

manduca[®]

my baby carrier /
mon porte-bébé

xt

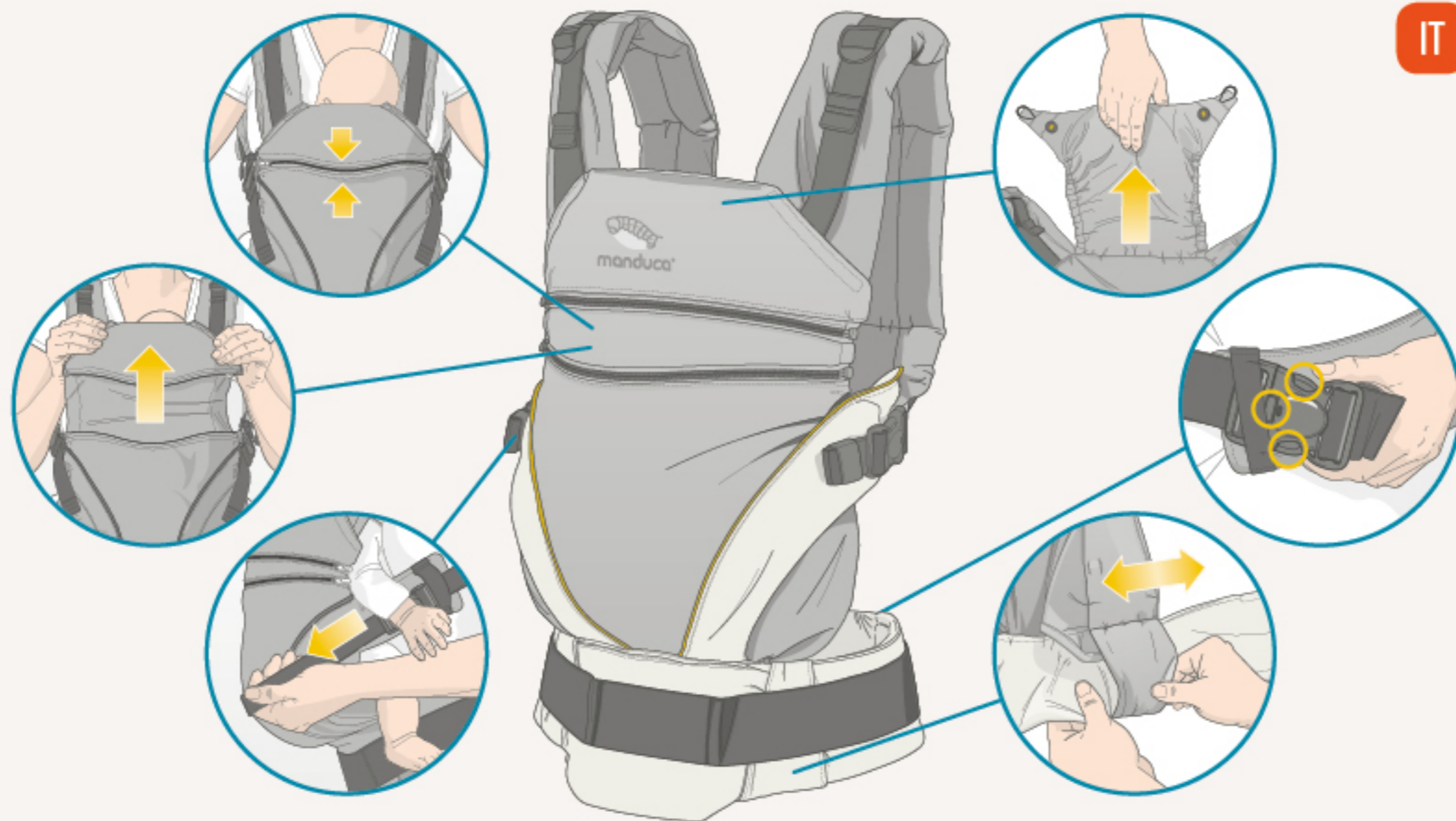

IT Istruzioni d'uso

IMPORTANTE! CONSERVARE LE ISTRUZIONI D'USO PER EVENTUALI RIFERIMENTI FUTURI

Leggere attentamente le presenti istruzioni prima di indossare per la prima volta il marsupio!

ATTENZIONE

ATTENZIONE Controlla attentamente e continuamente il tuo bambino assicurandoti che bocca e naso non siano coperti.

ATTENZIONE Consulta un medico prima di usare il prodotto nel caso di bambini prematuri, di poco peso e/o con disturbi.

ATTENZIONE Assicurati che il mento del tuo bambino non sia poggiato sul suo petto per evitare disturbi di respirazione che possano provocare soffocamento.

ATTENZIONE Metti a sedere il tuo bambino in una posizione sicura nel marsupio per evitare che possa cadere giù.

Alcune attività richiedono prudenza, ad esempio mentre si cucina o si fanno le pulizie, oppure in prossimità di fonti di calore o di bevande calde.

Utilizza il marsupio sempre per portare un solo bambino.

Il marsupio è stato progettato esclusivamente per portare il tuo bimbo rivolto verso di te.

Il vostro equilibrio può essere compromesso dal movimento vostro e del bambino.

Fare attenzione quando ci si piega o china in avanti o lateralmente.

Non usare il marsupio durante l'attività sportiva come corsa, bicicletta, nuoto e sci.

Il rischio di cadere giù dal marsupio aumenta una volta che il tuo bambino diventa più mobile e attivo.

CONSERVAZIONE E CURA

Tieni il marsupio fuori dalla portata di bambini quando non in uso.

Controllare regolarmente il marsupio per individuare eventuali segni d'usura, inclusi cuciture e stoffa lacerati.

Chiudi tutte le fibbie prima del lavaggio e quando riponi il marsupio non utilizzato.



Detersivo per capi delicati

manduca[®]
my baby carrier/
mon porte-bébé
xt



4

Reggitesta



6

I primi passi



10

Marsupio ventrale



18

Sul fianco



22

Marsupio dorsale

Reggitesta

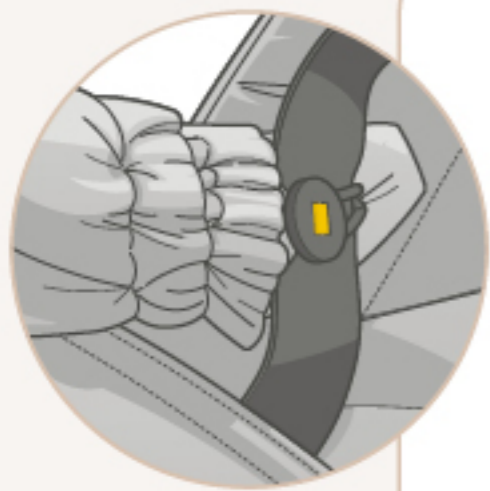

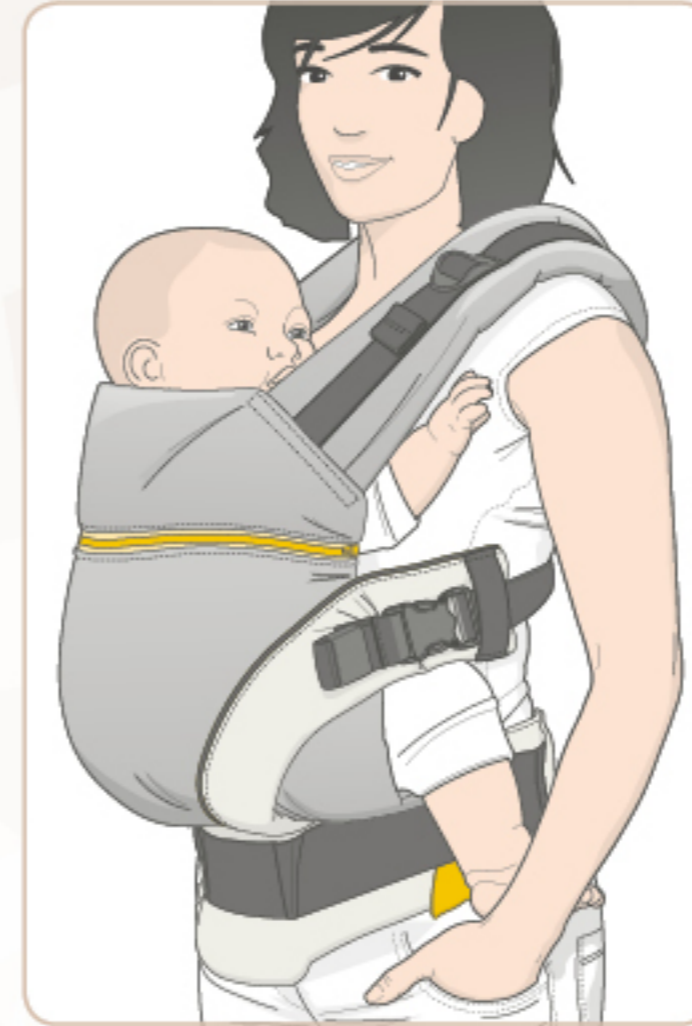



I primi passi

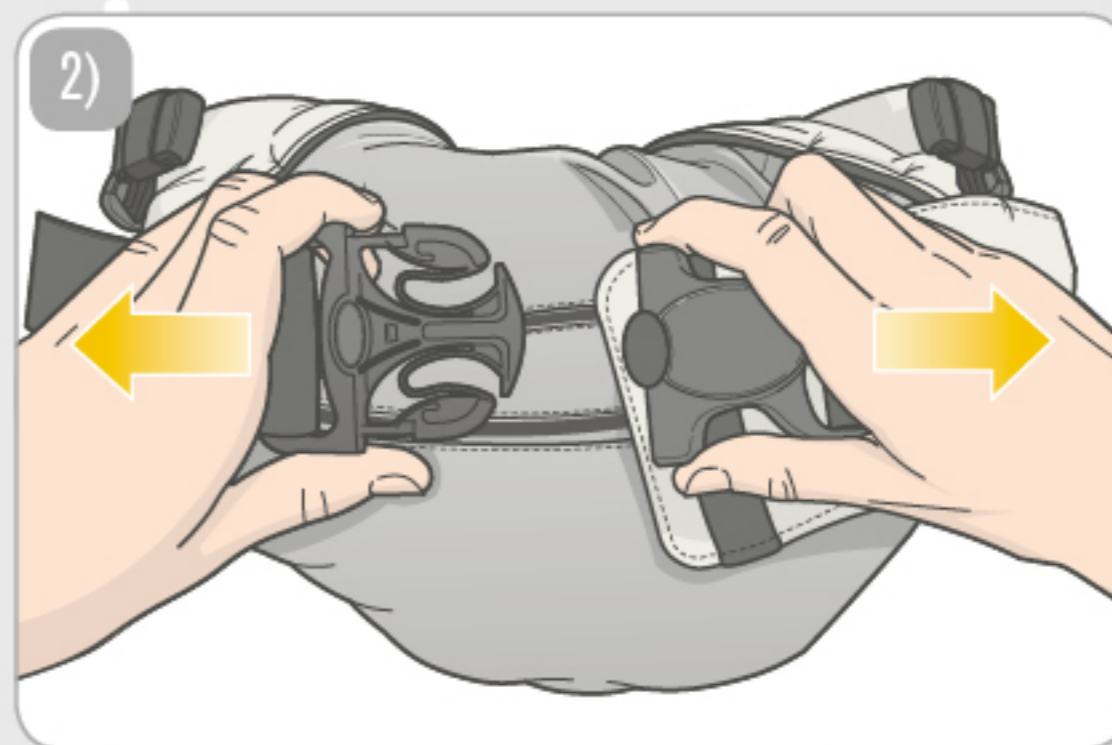
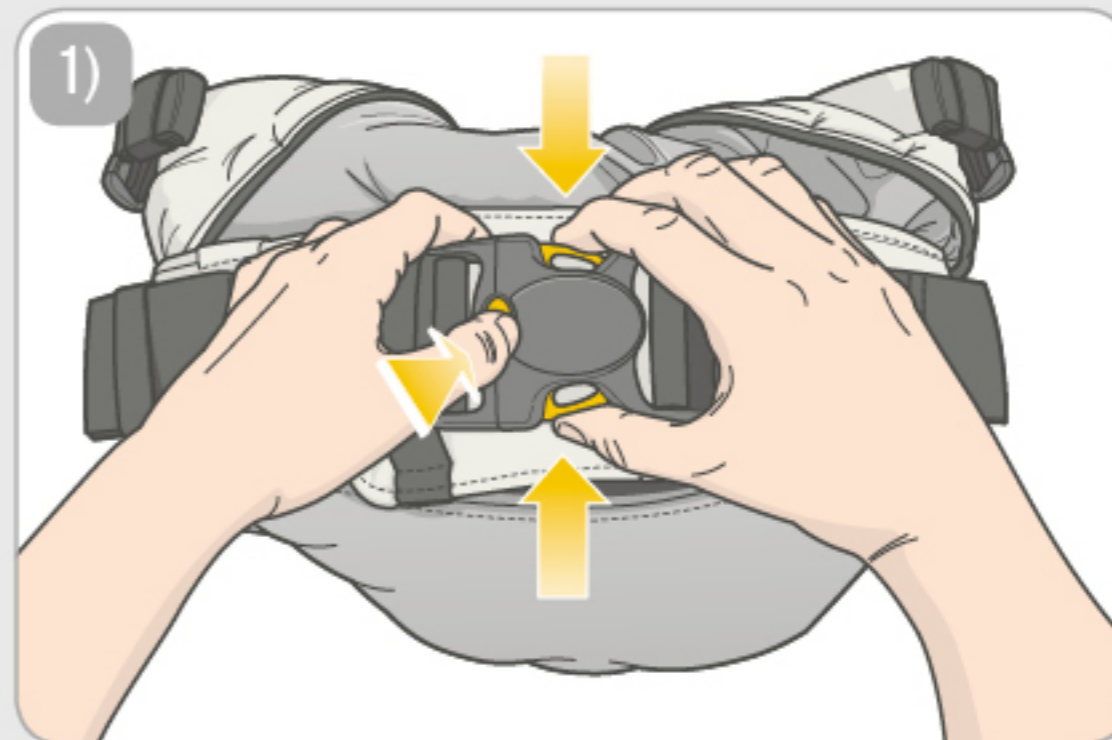
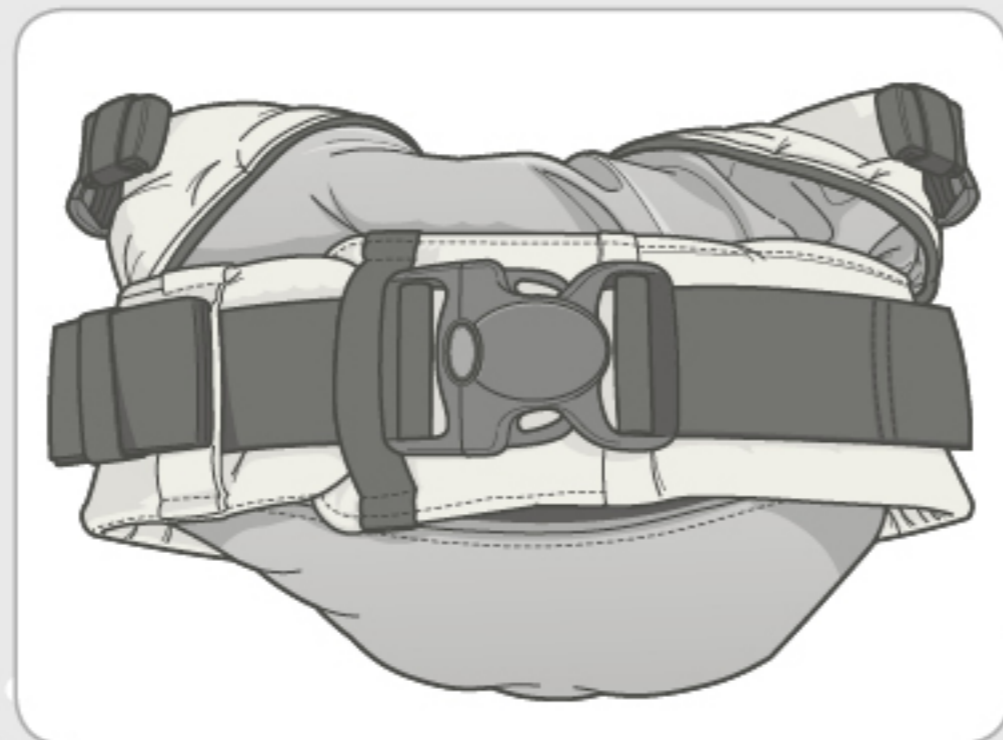

3)

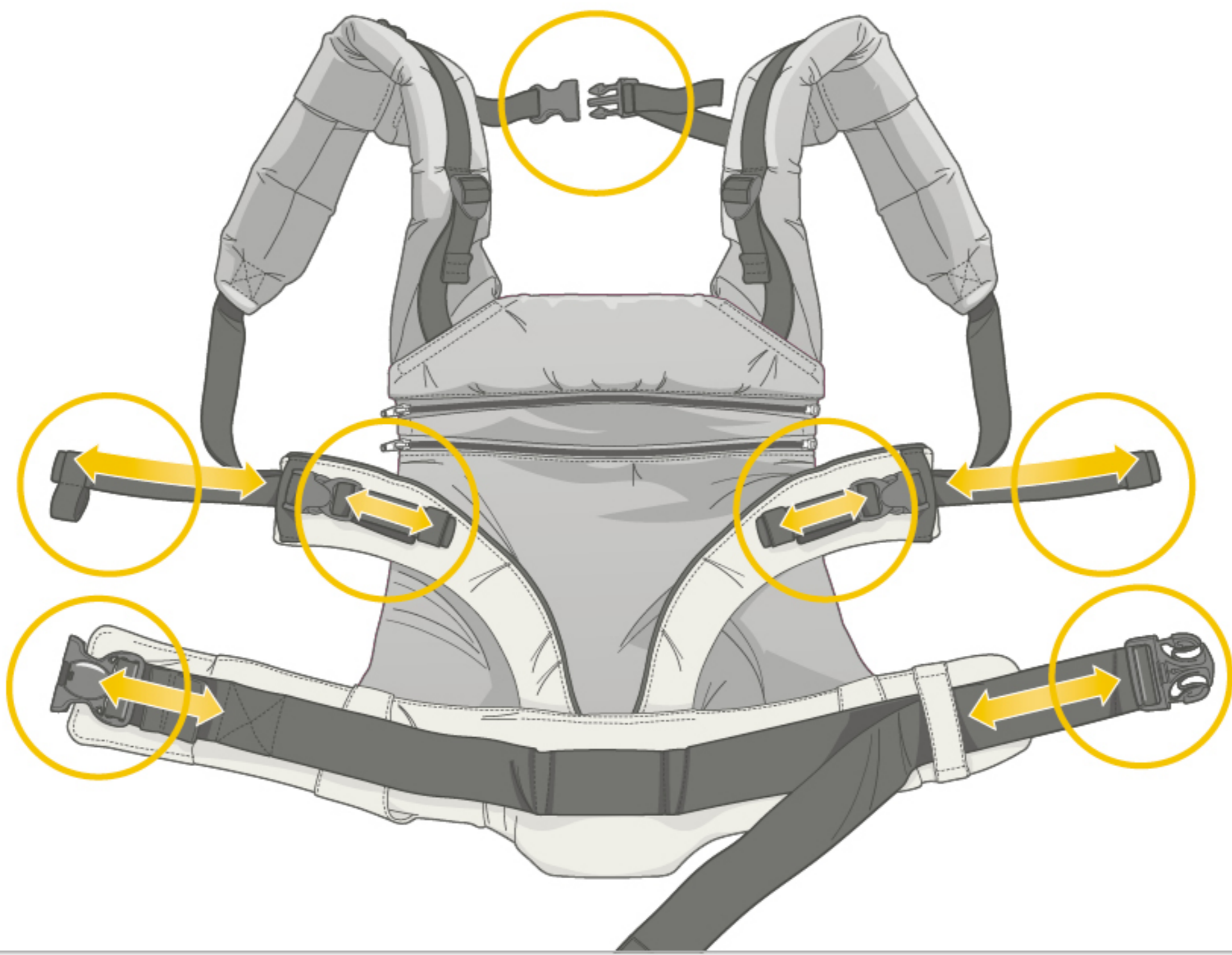

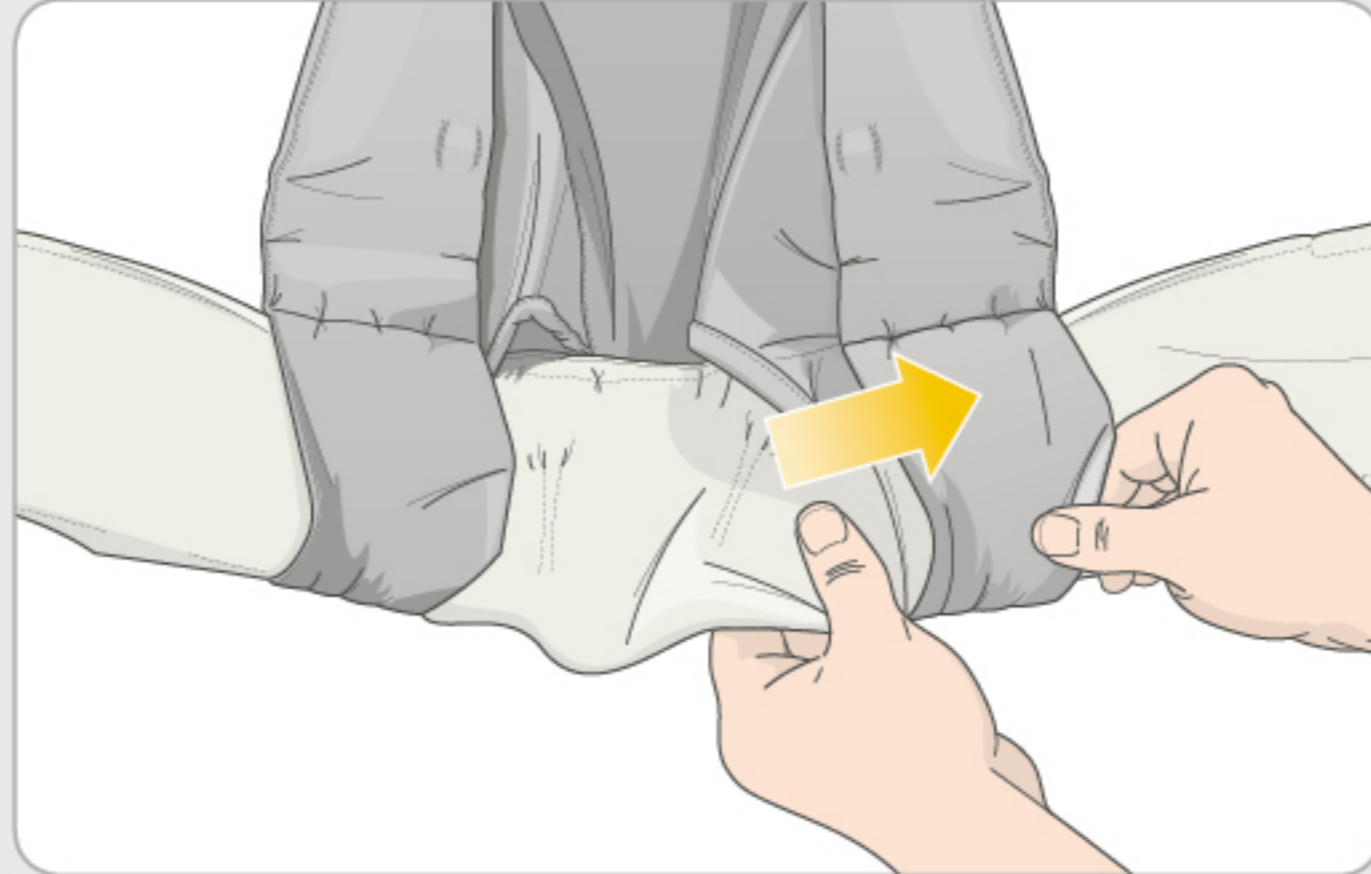
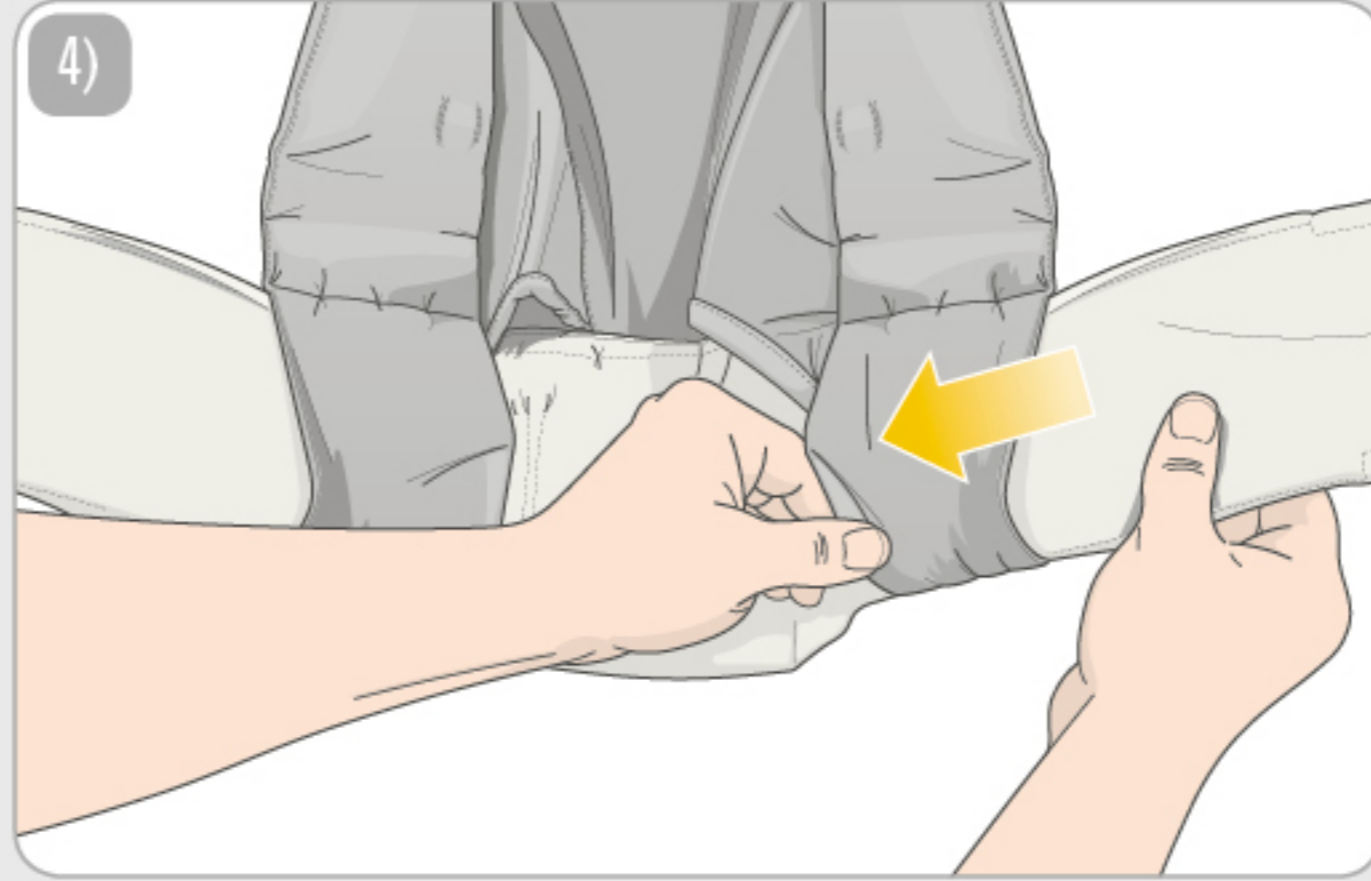

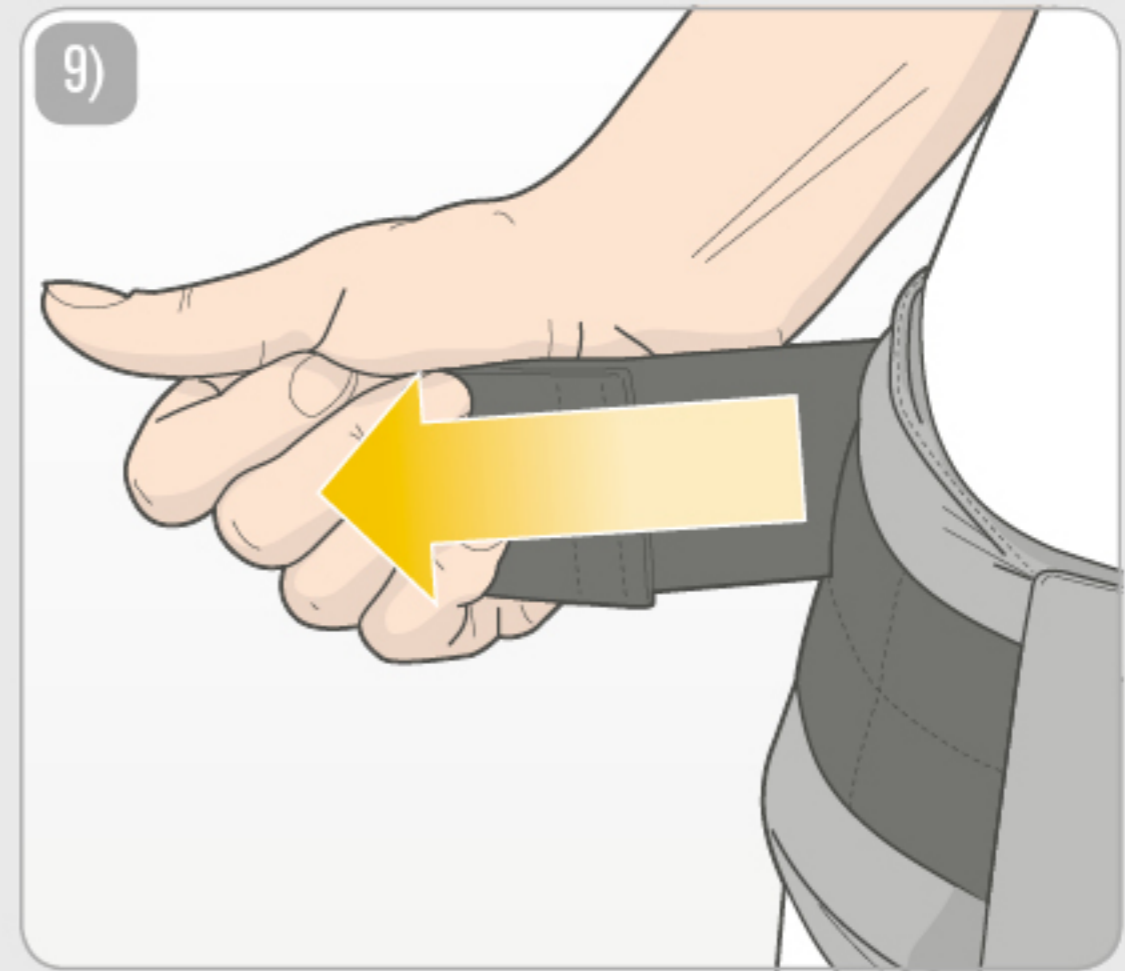
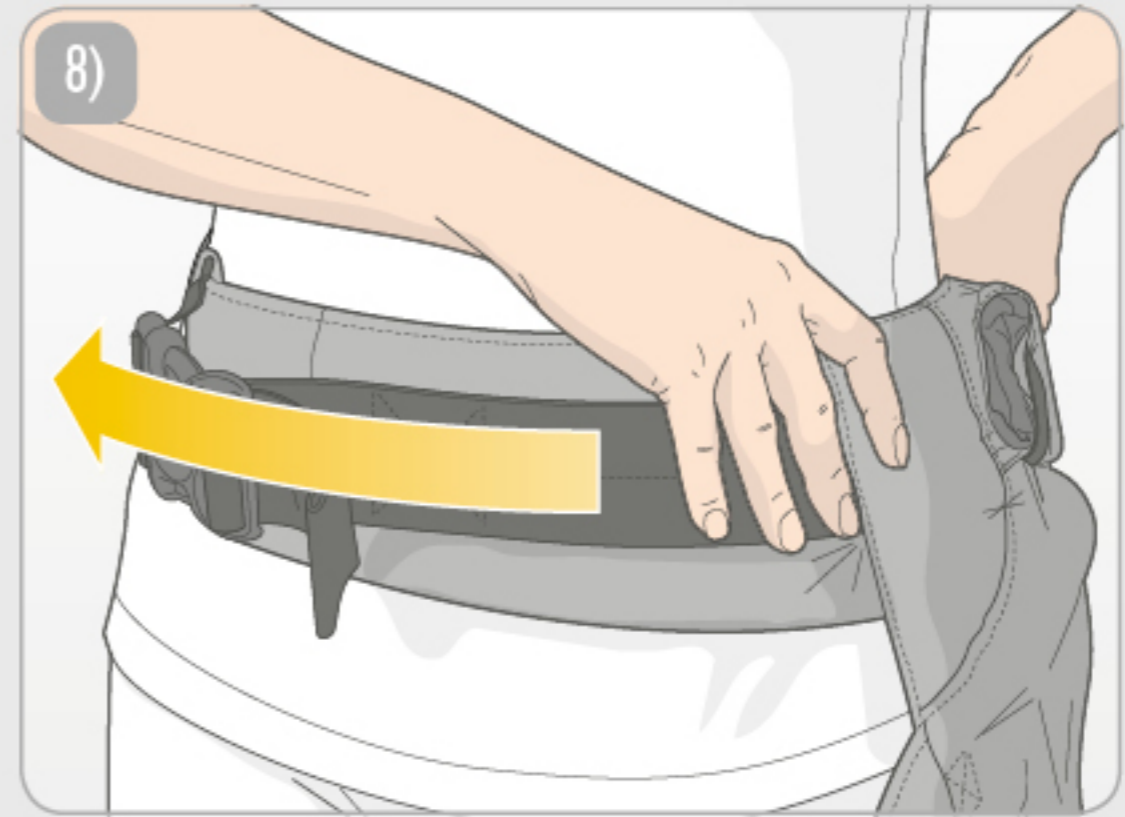
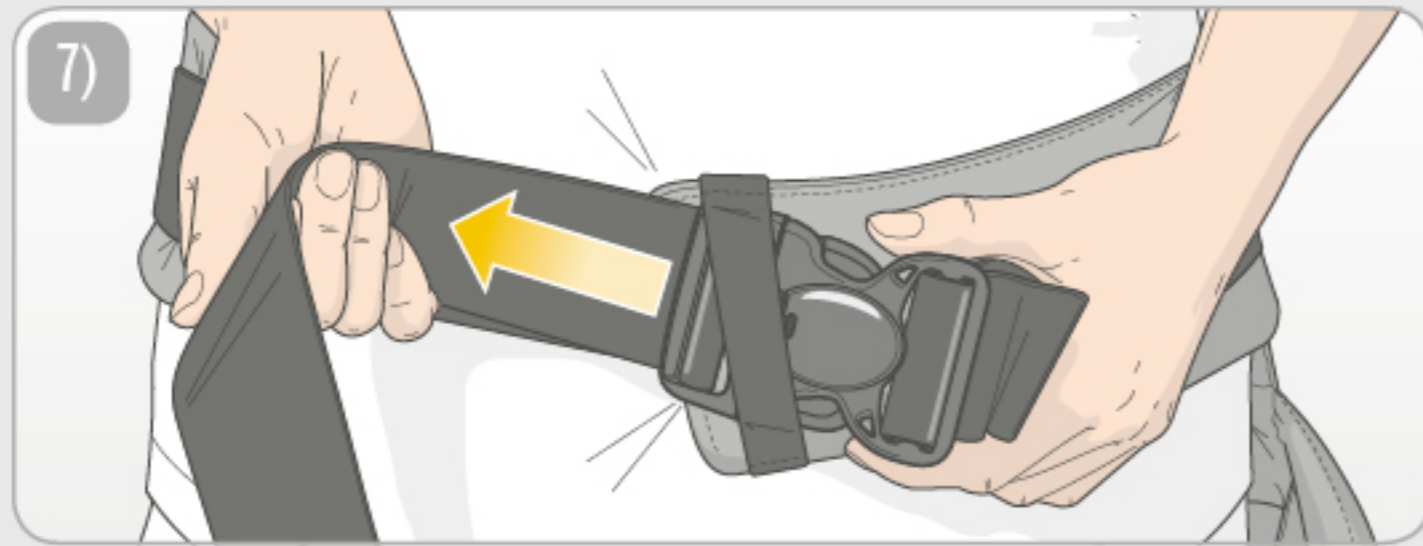
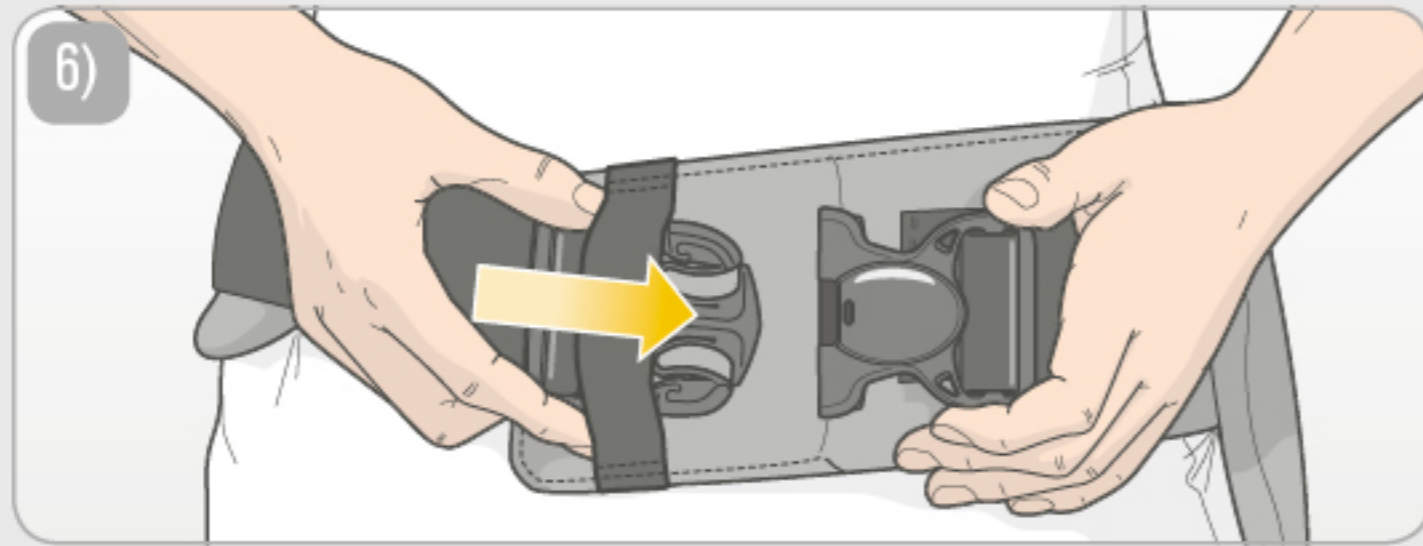
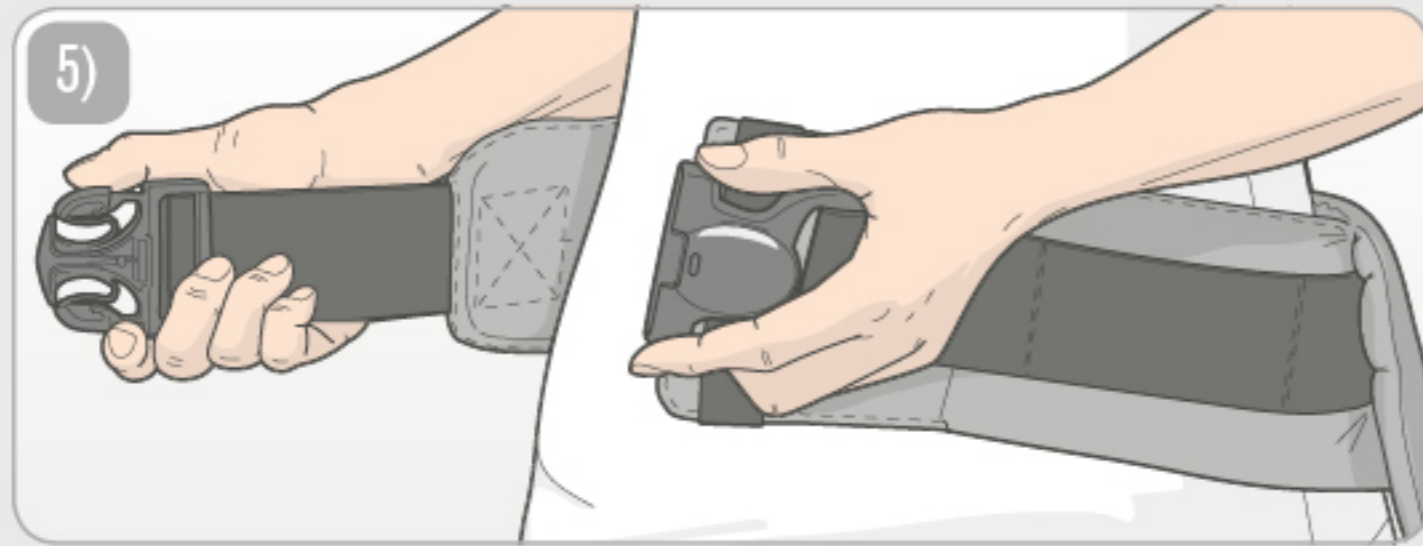

Marsupio ventrale

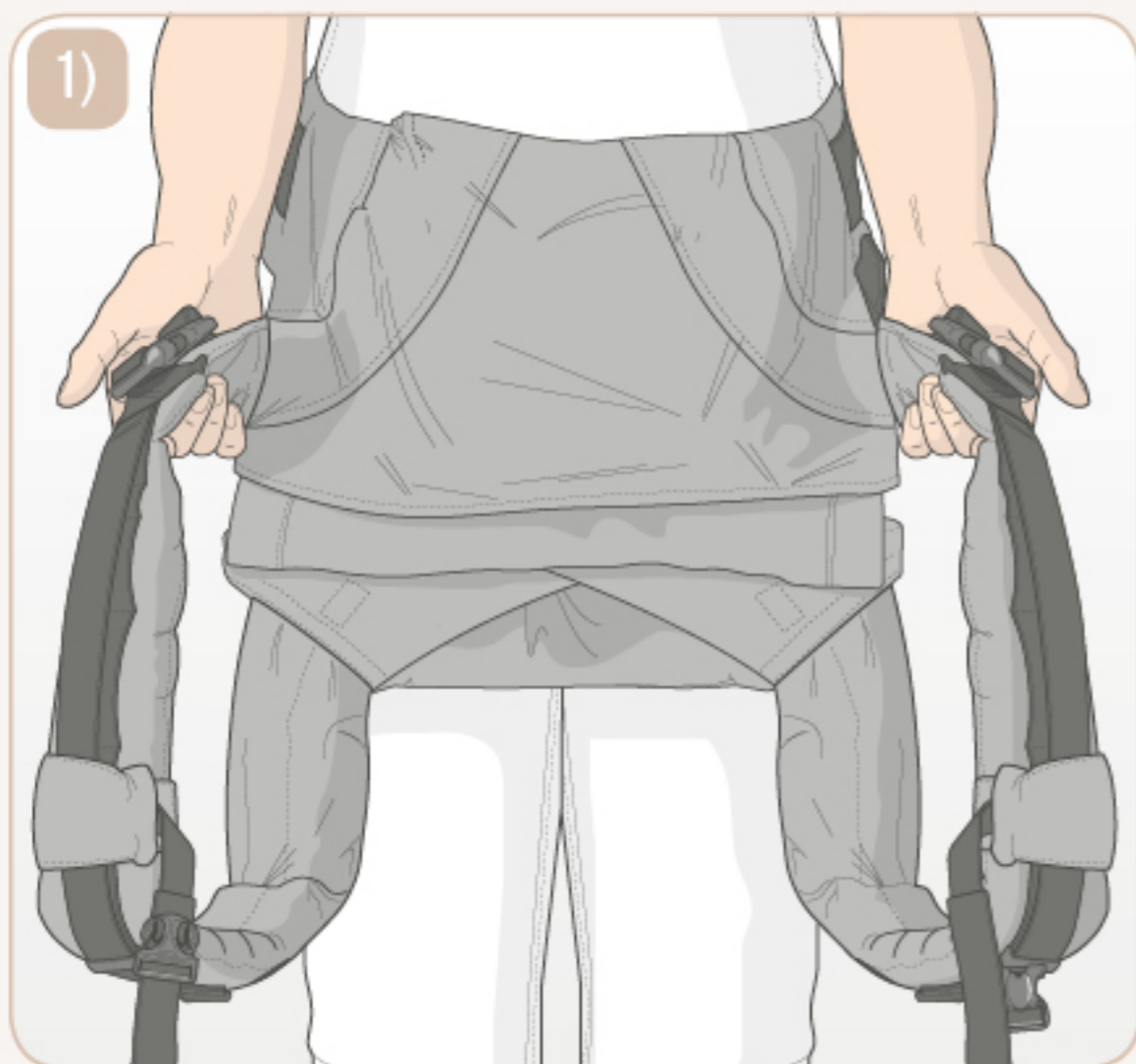



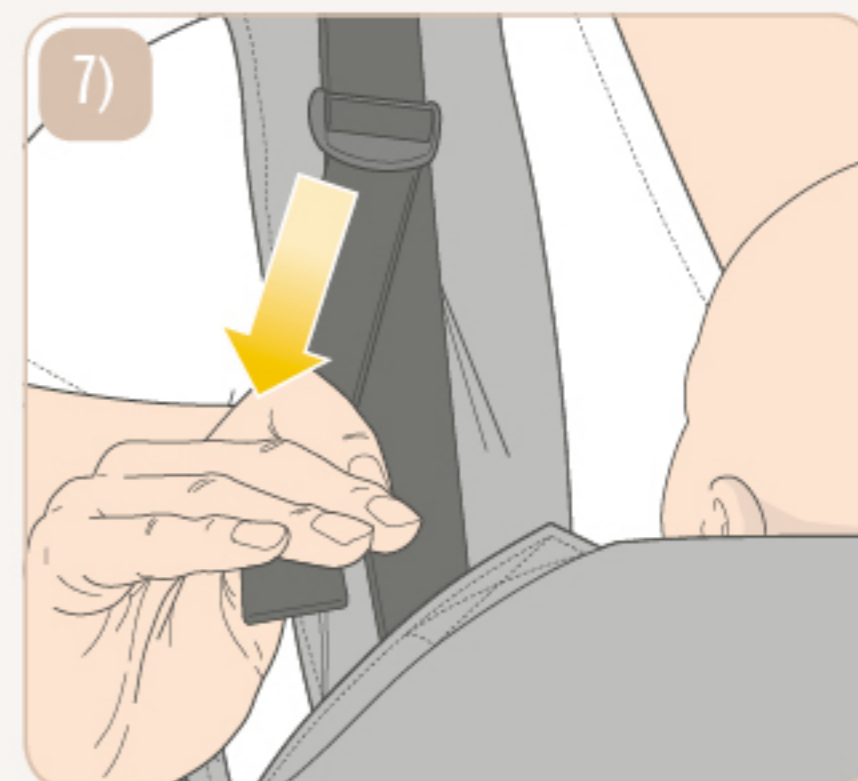
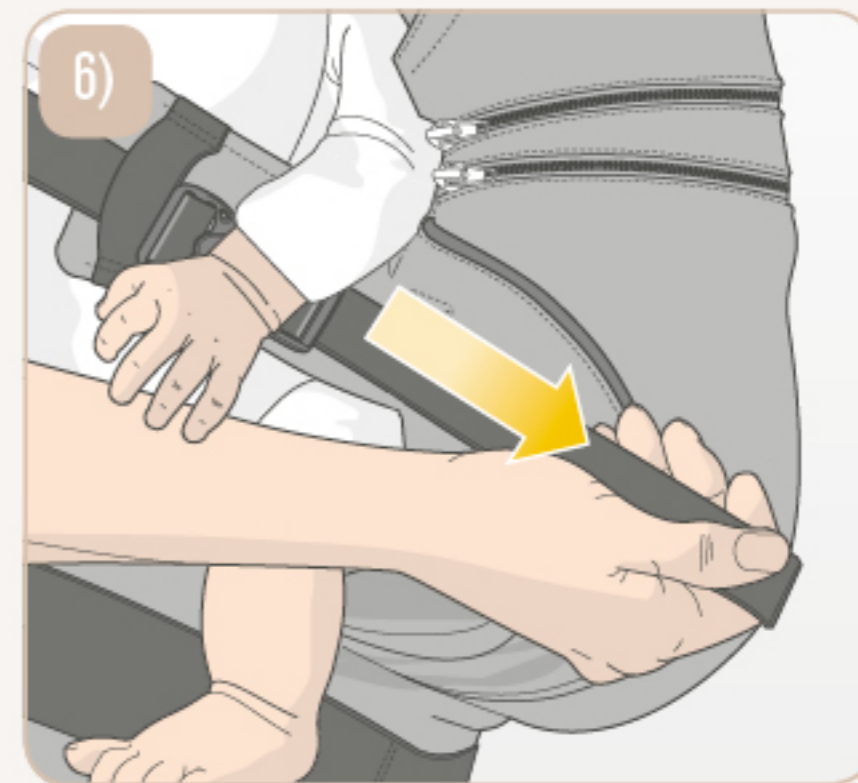
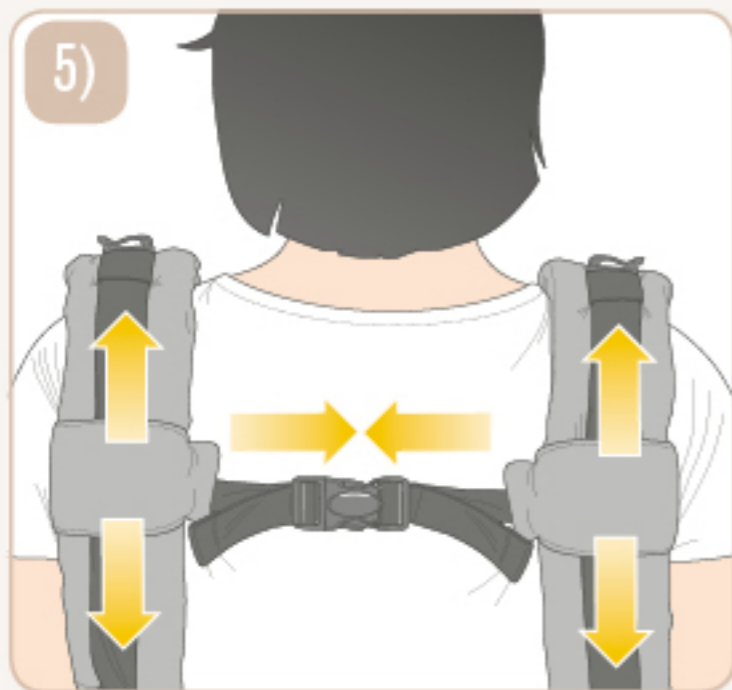

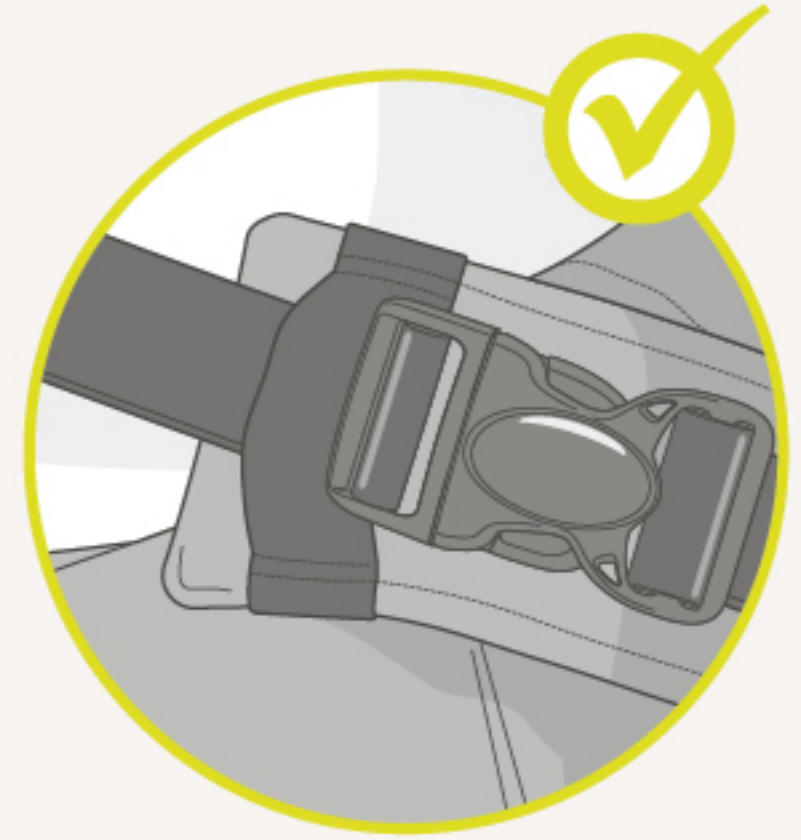
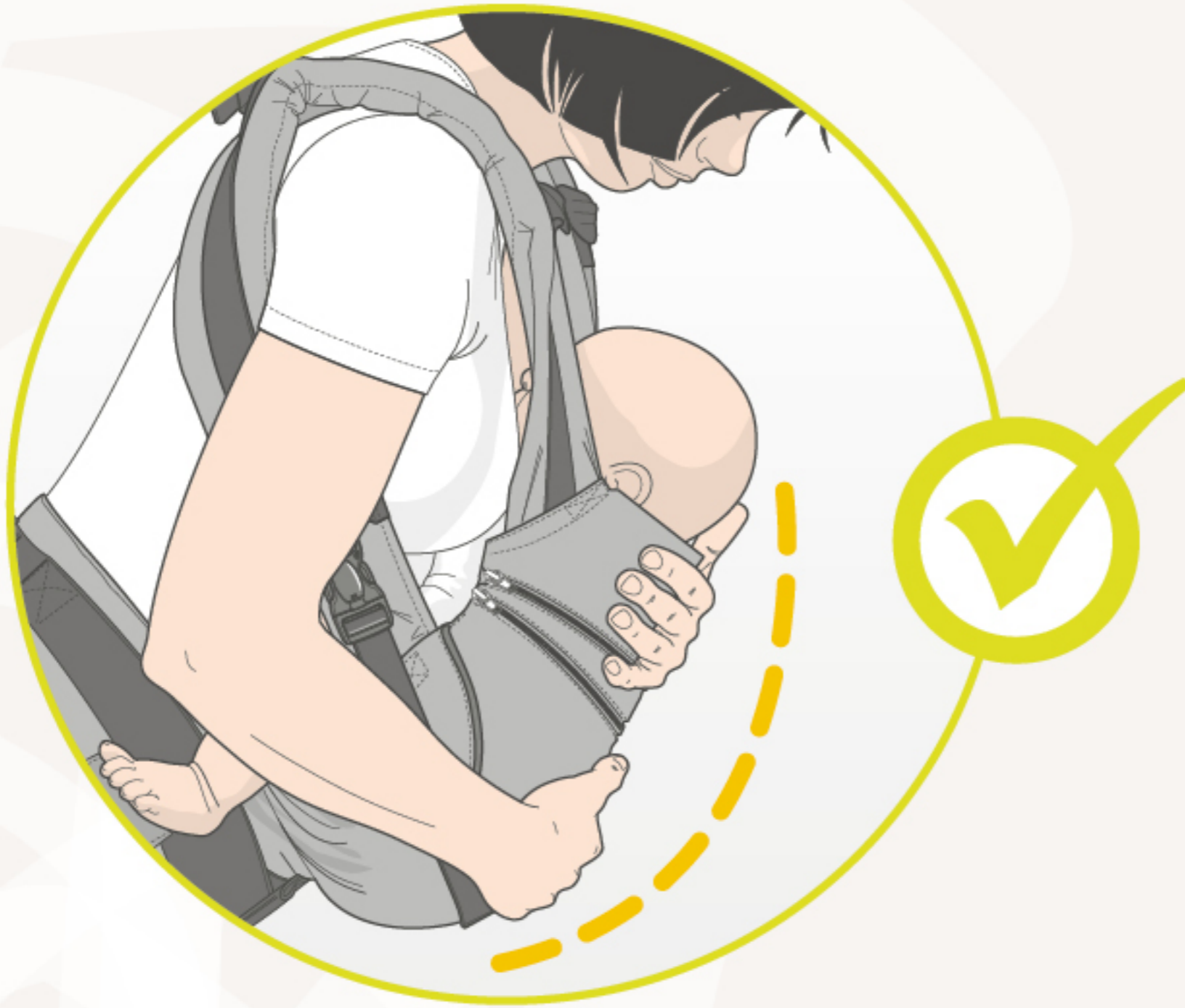

Marsupio ventrale



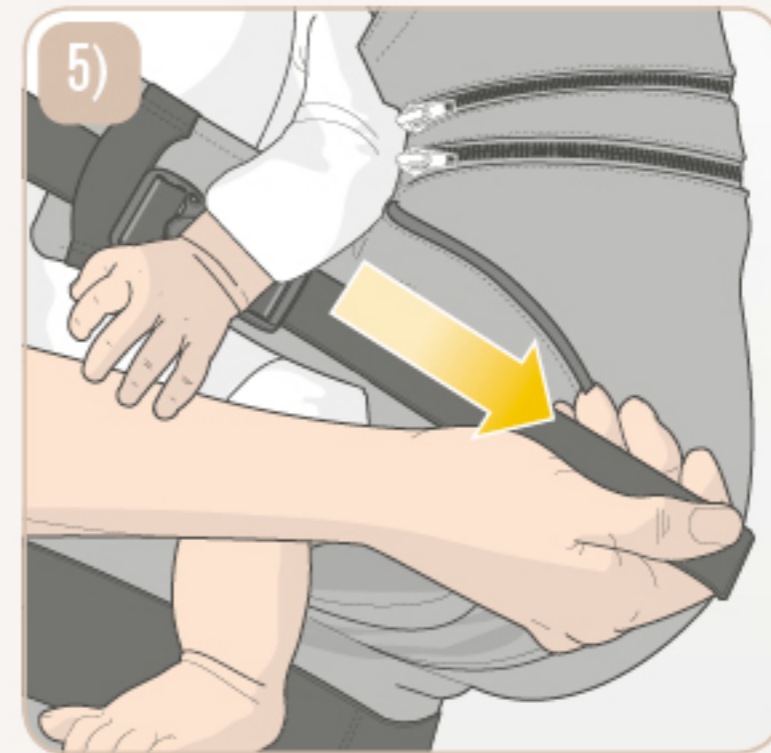
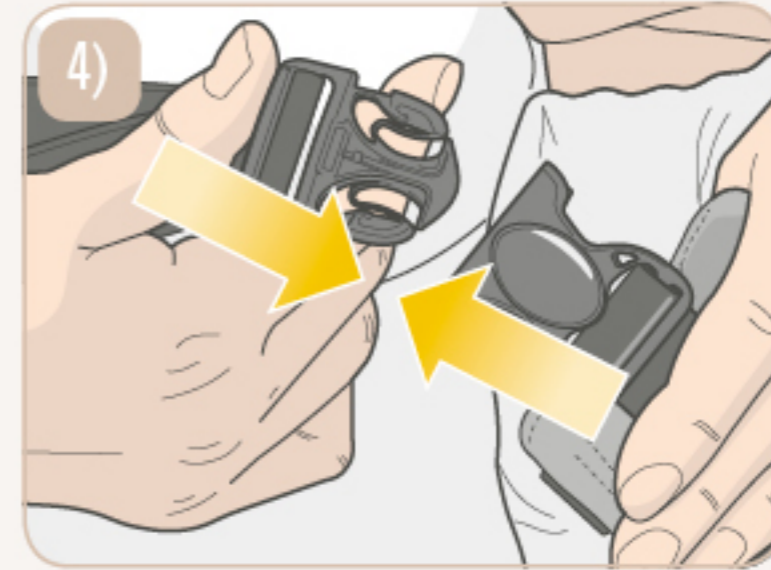
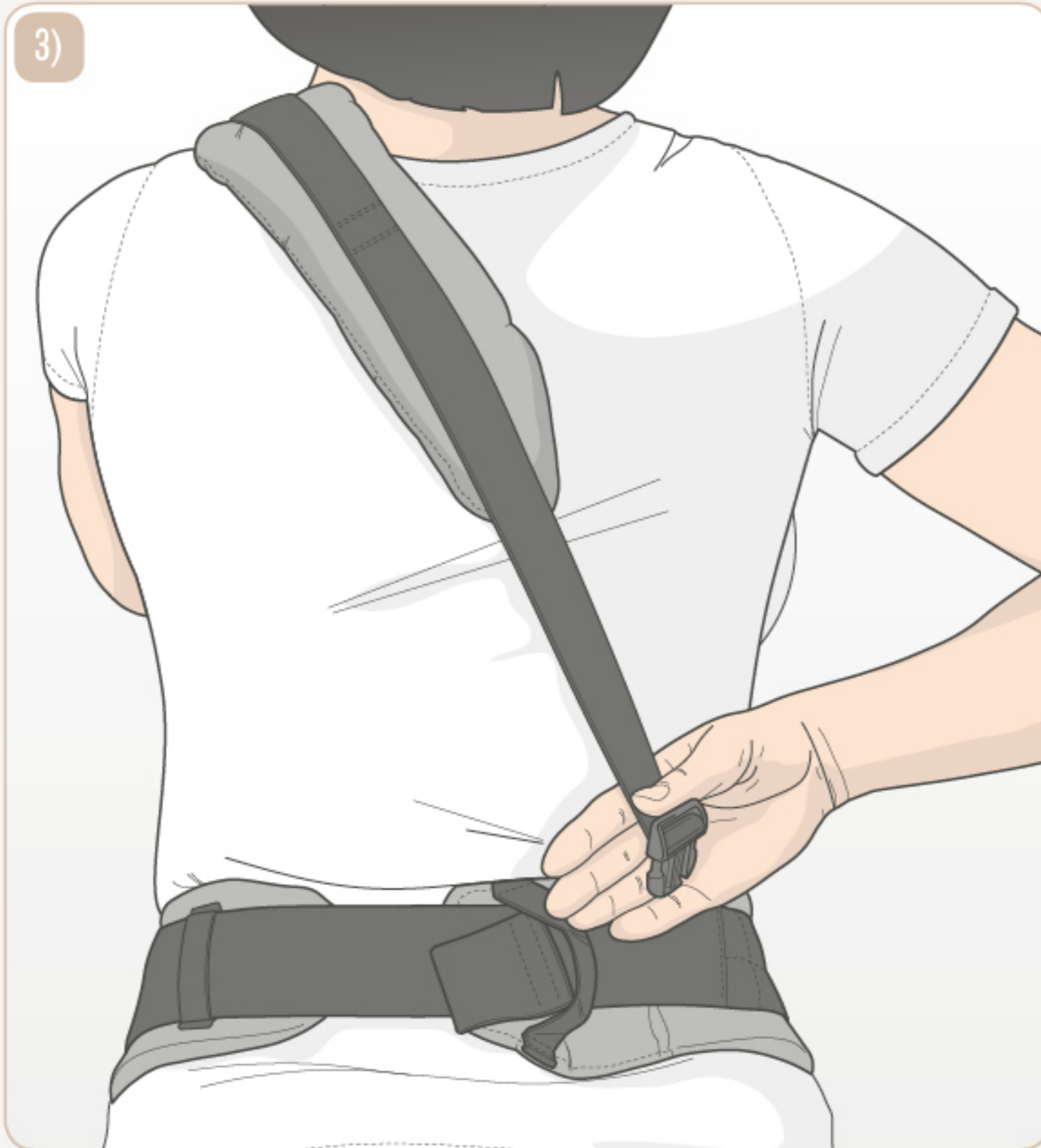

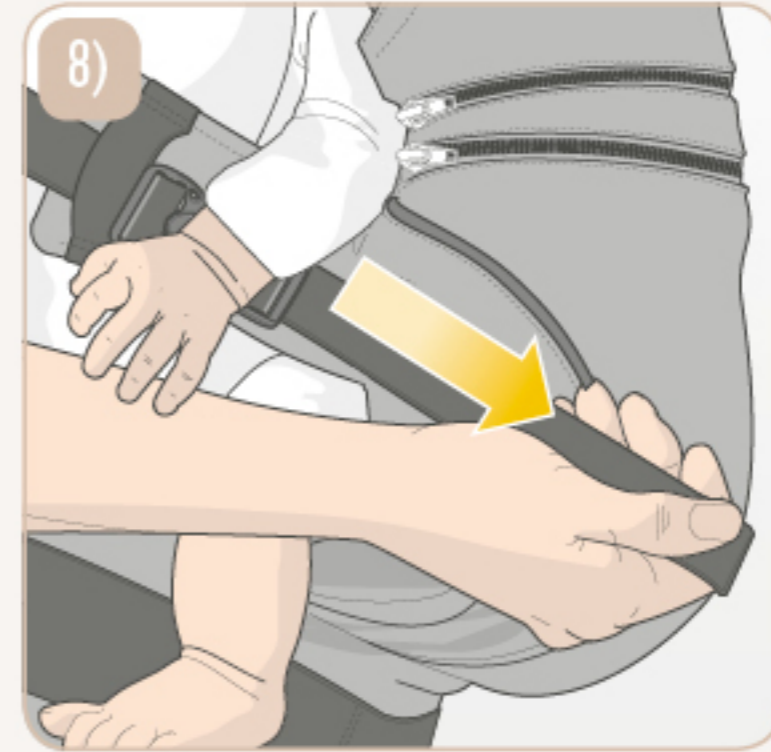
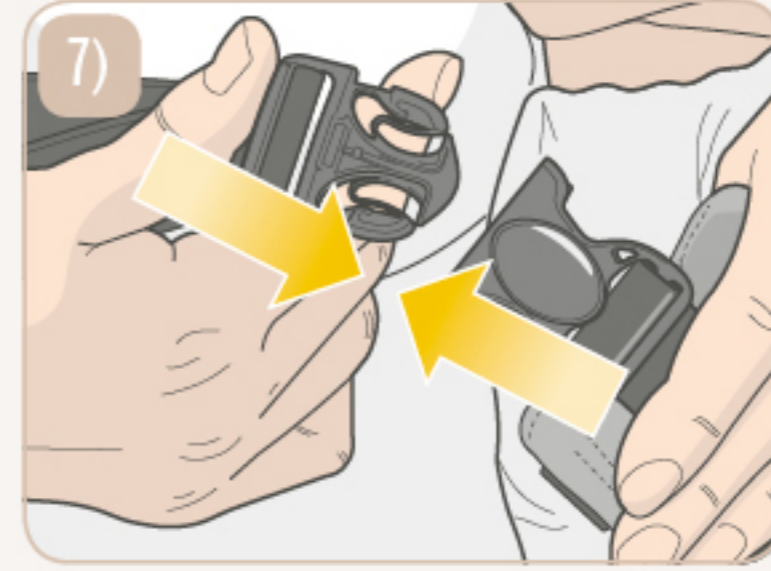
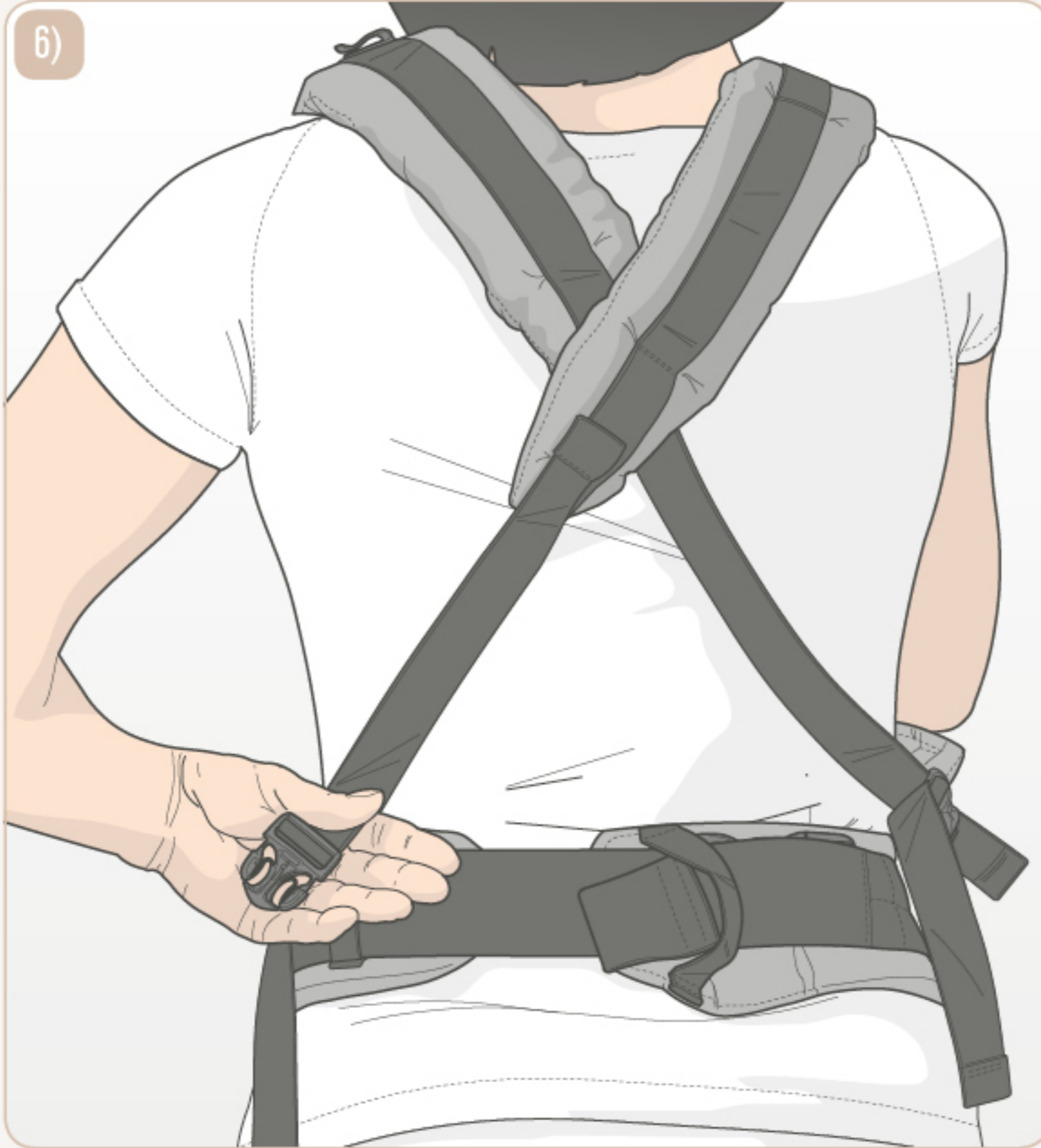

manduca®

my baby carrier /
mon porte-bébé

xt

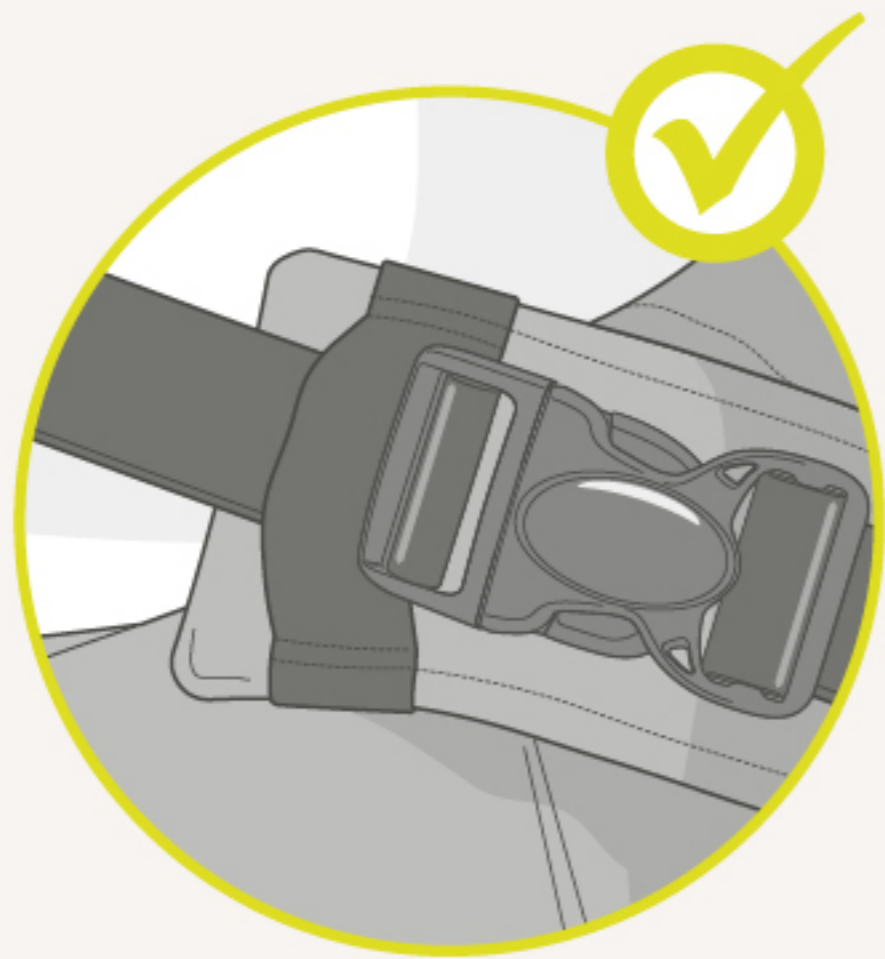



>3 mo.

Sul fianco

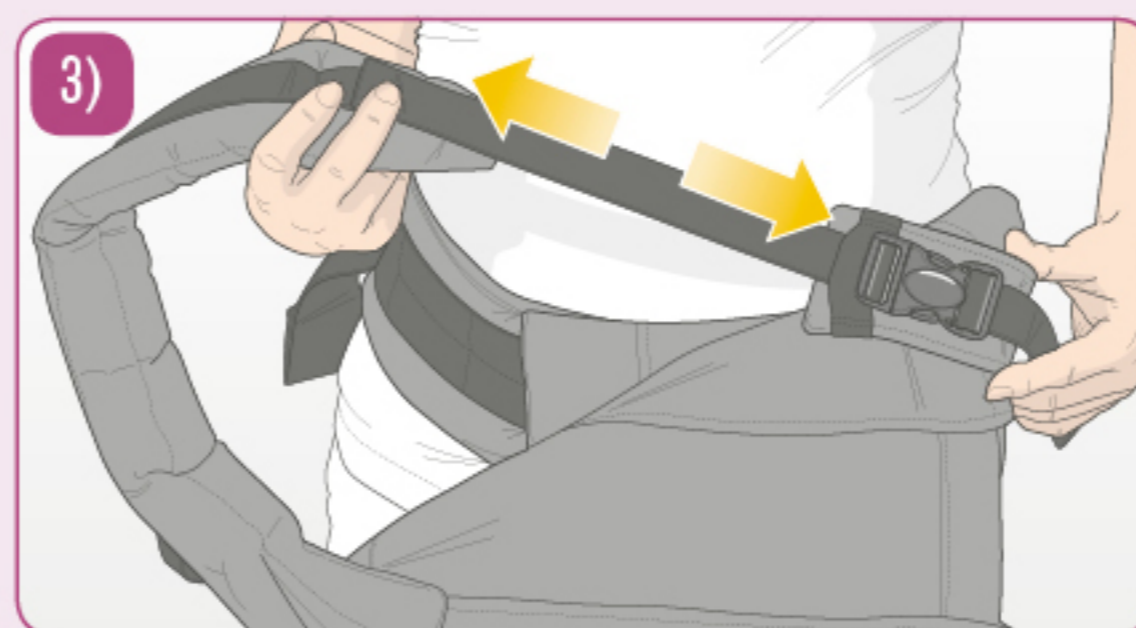
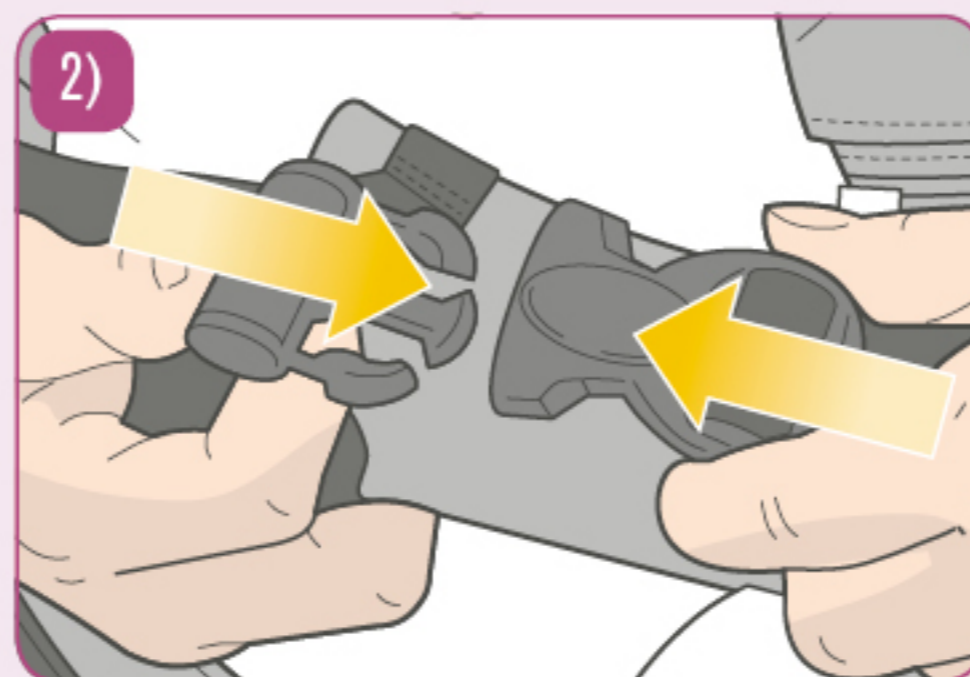
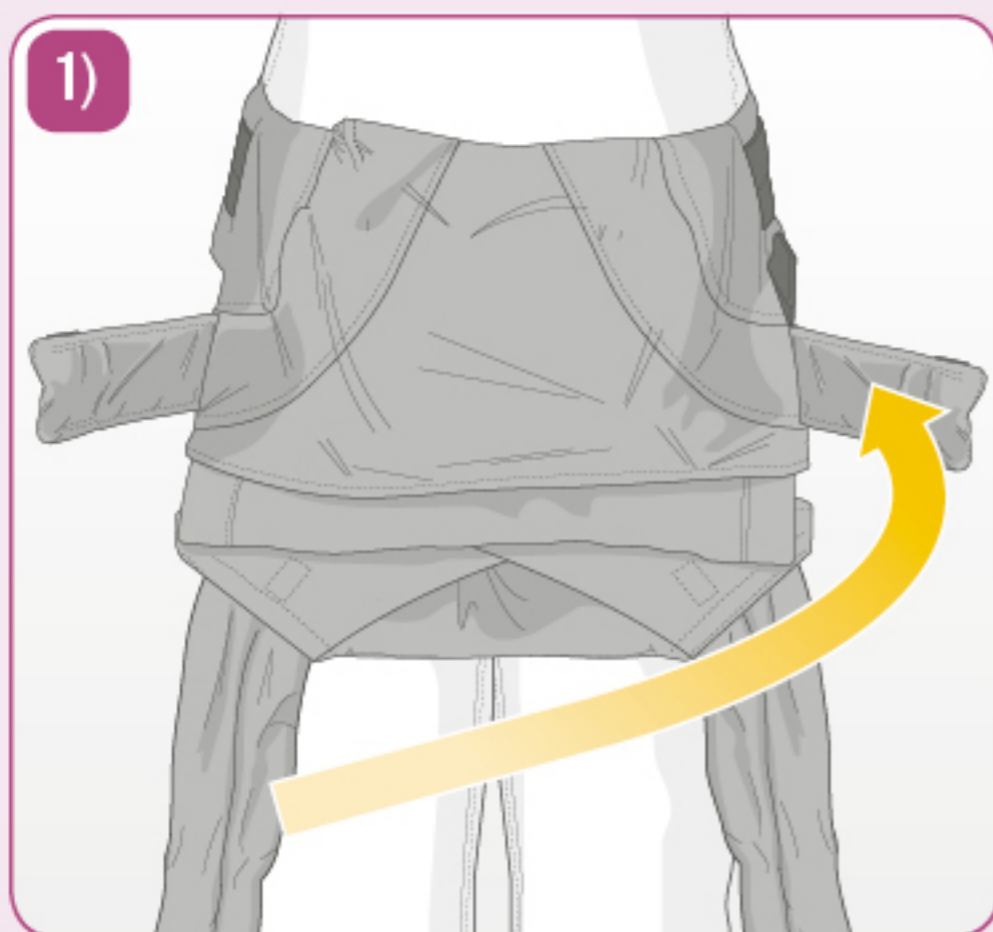

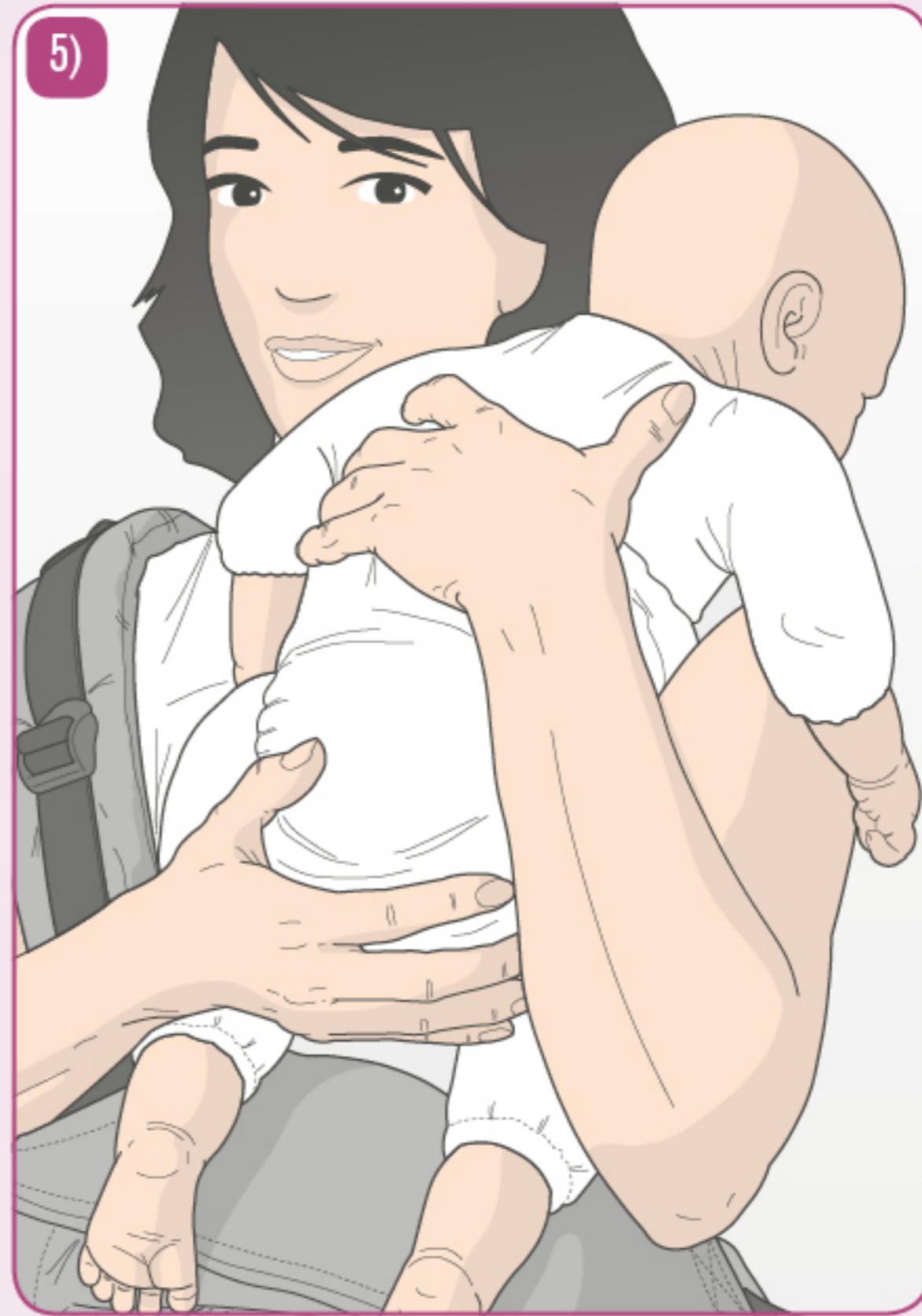

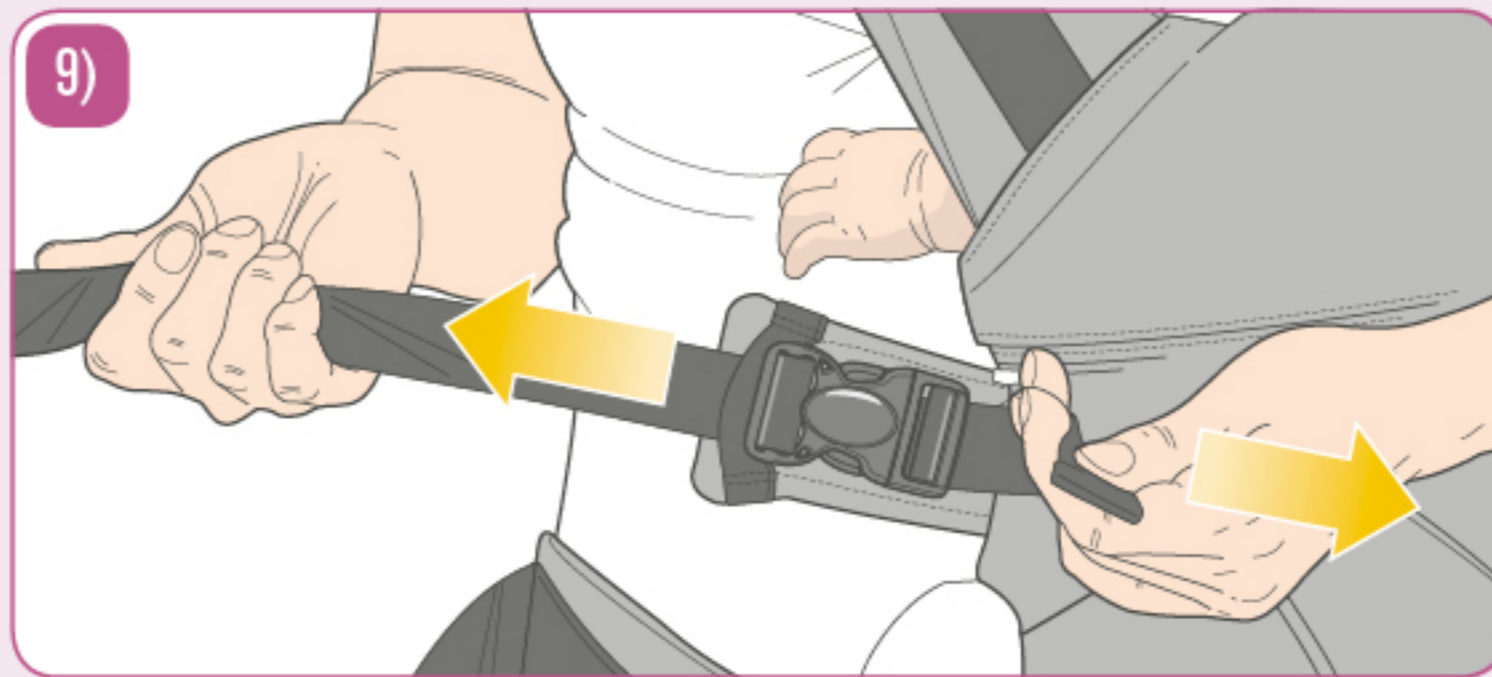
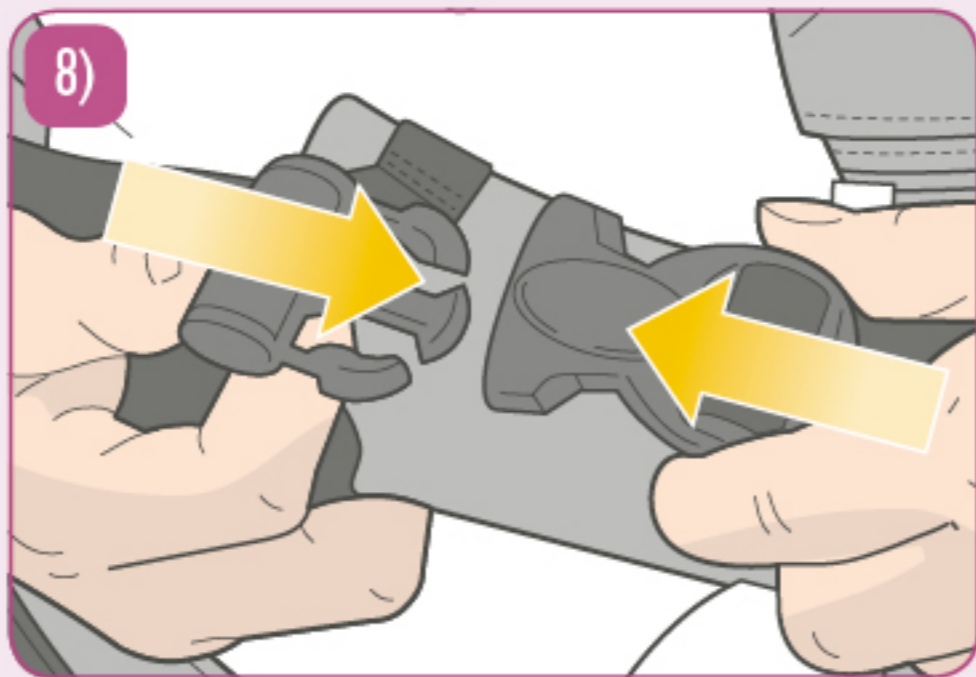
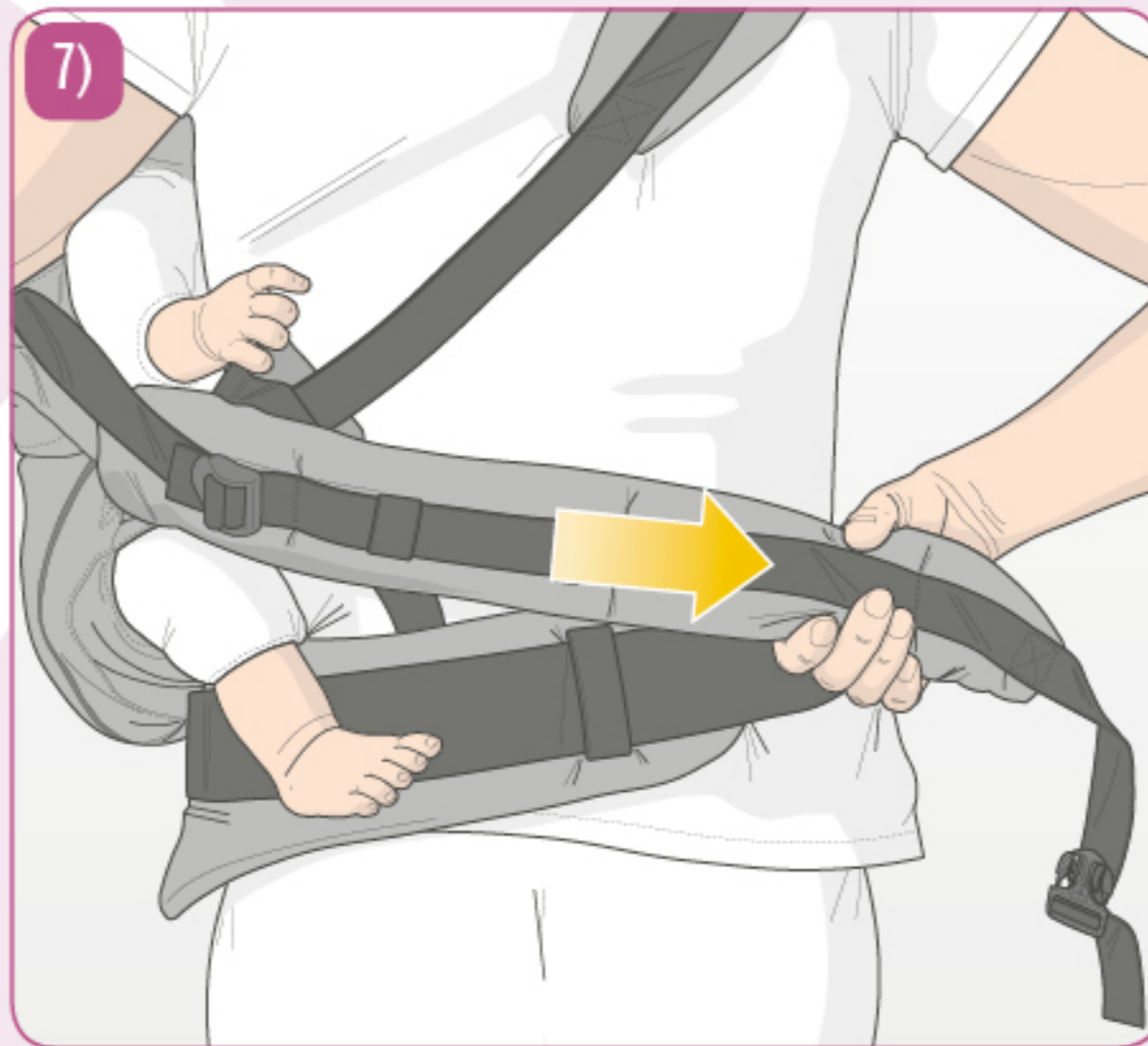

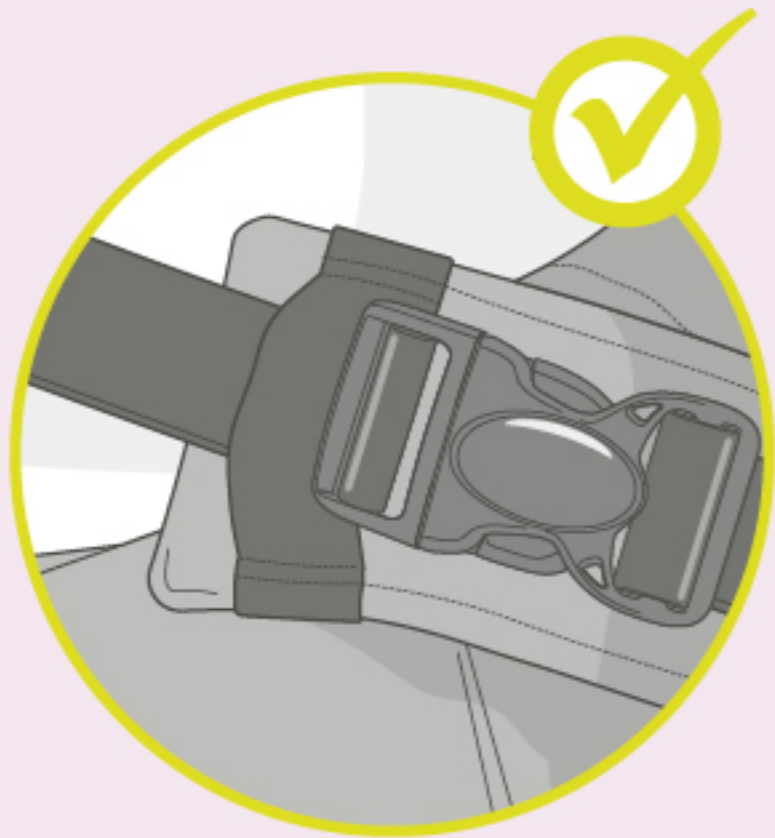



>3 mo.

Marsupio dorsale

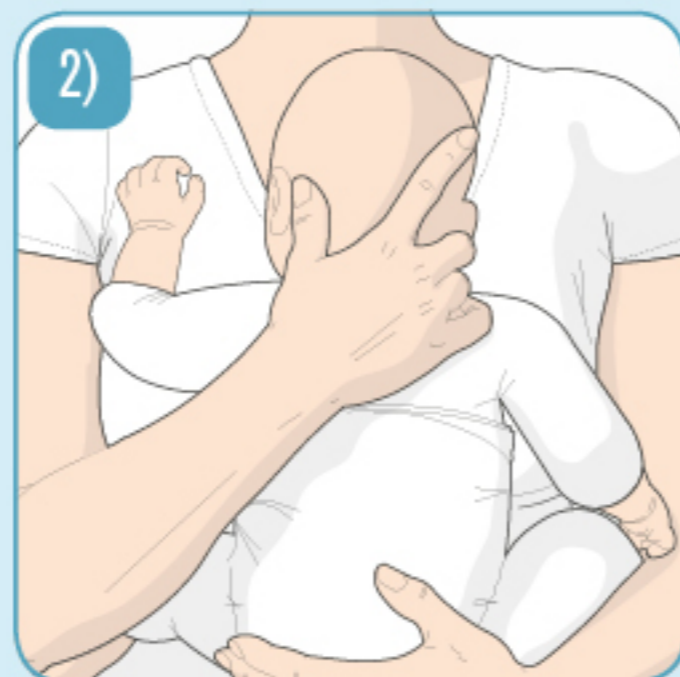

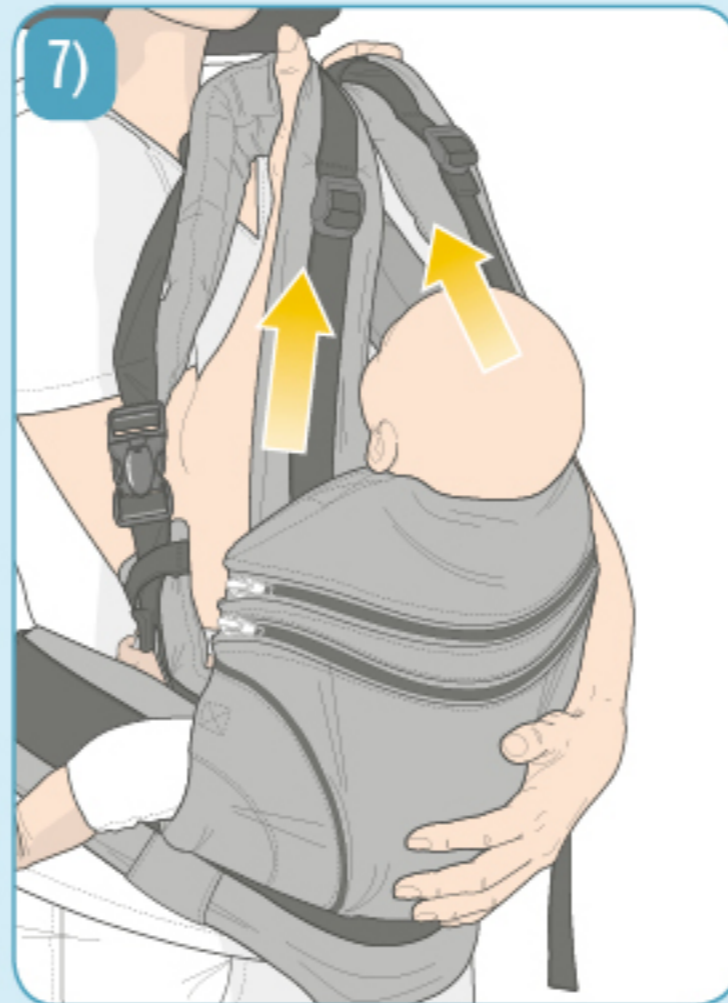

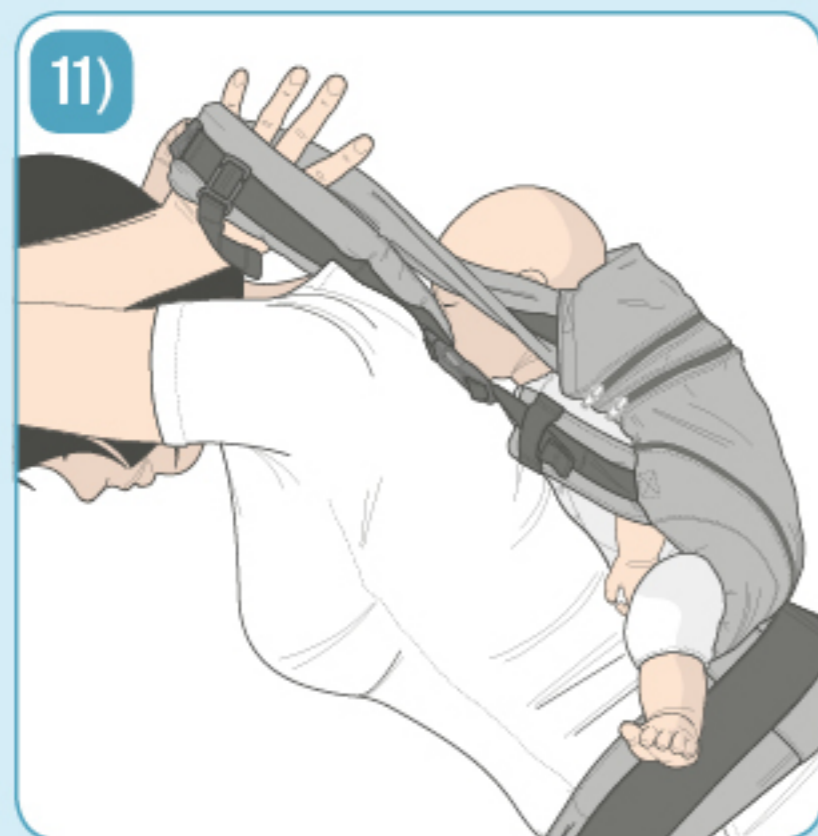

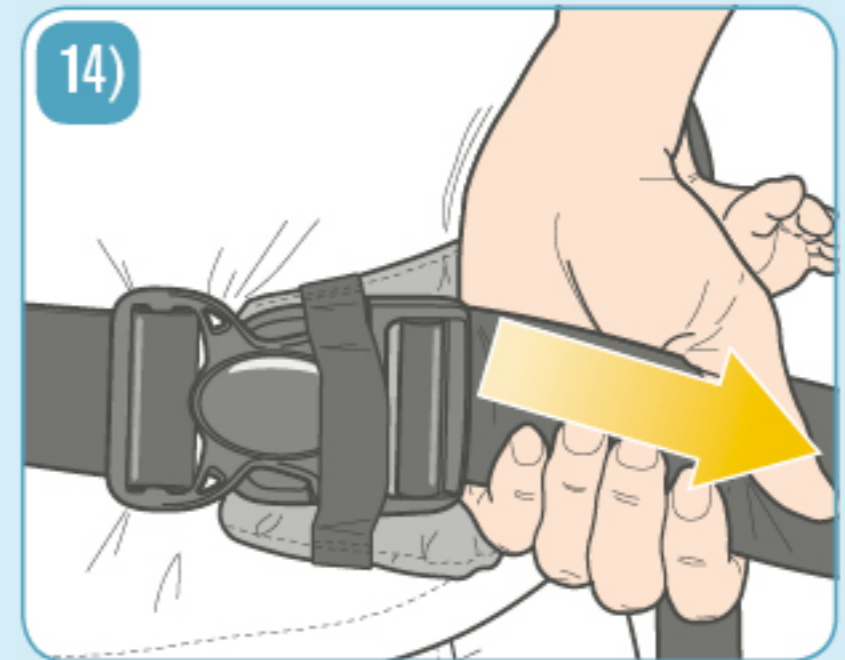
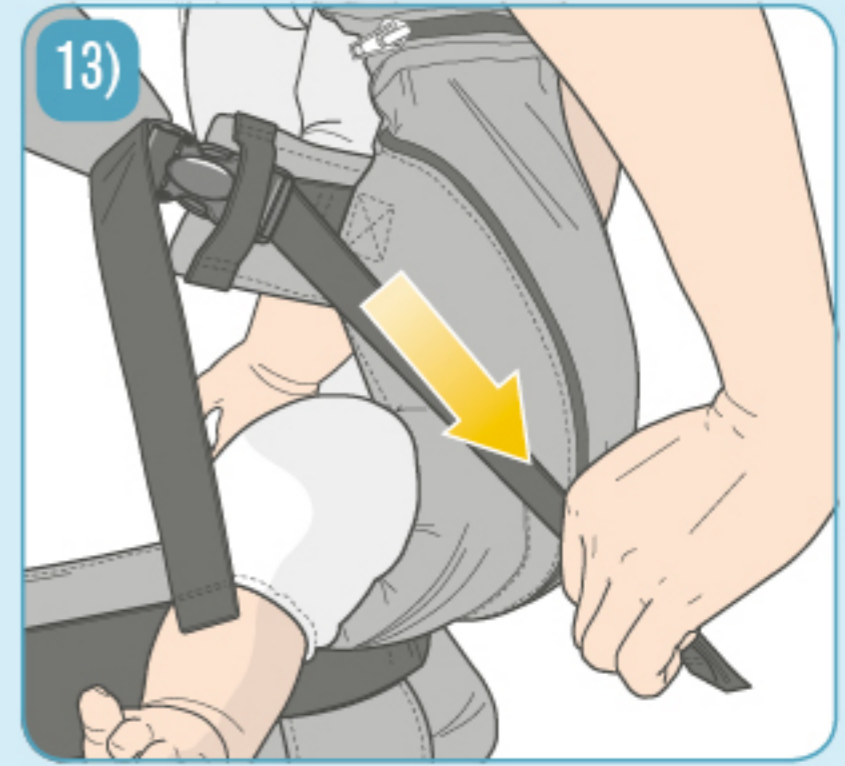
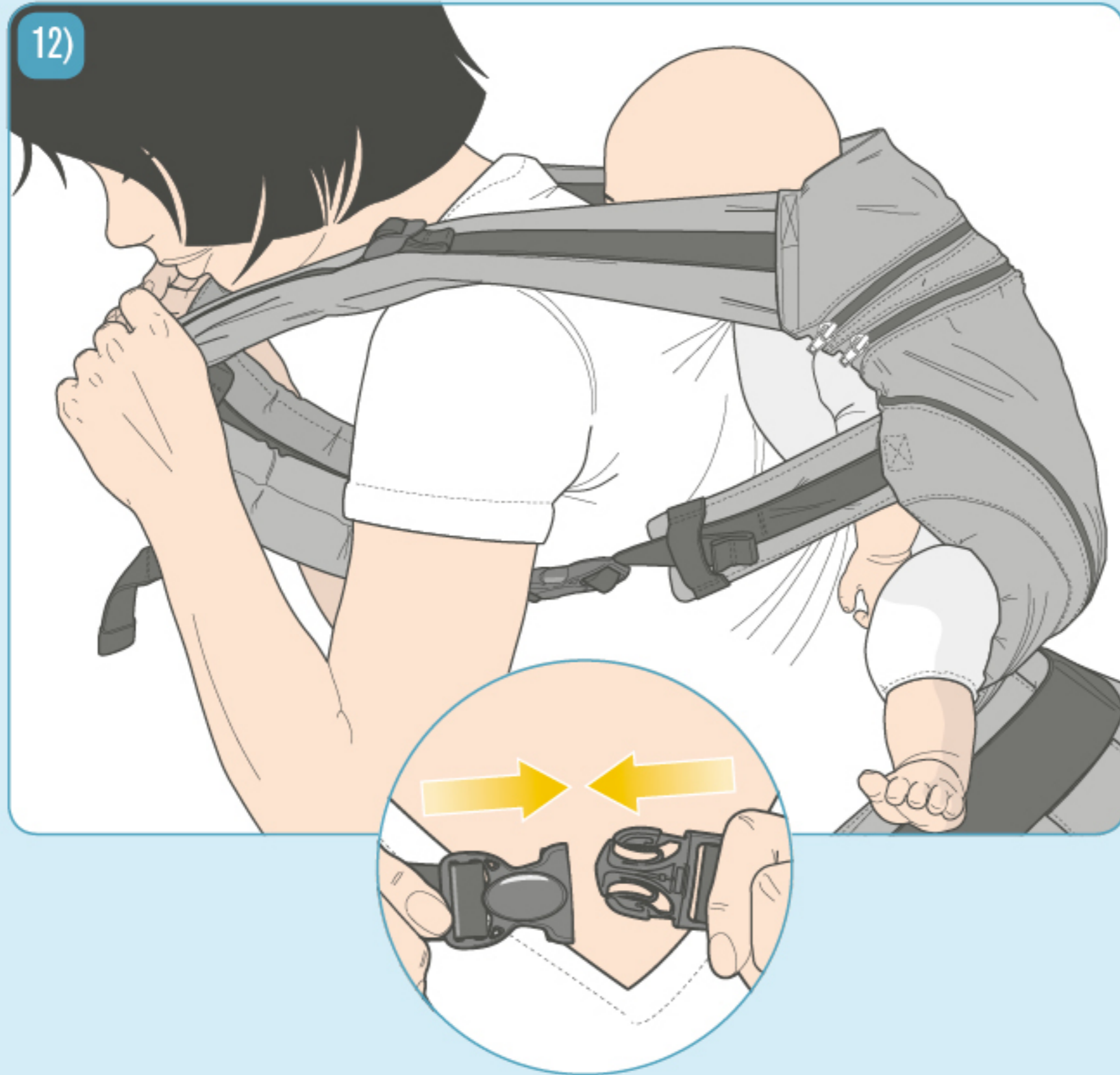



>9 mo.

Marsupio dorsale



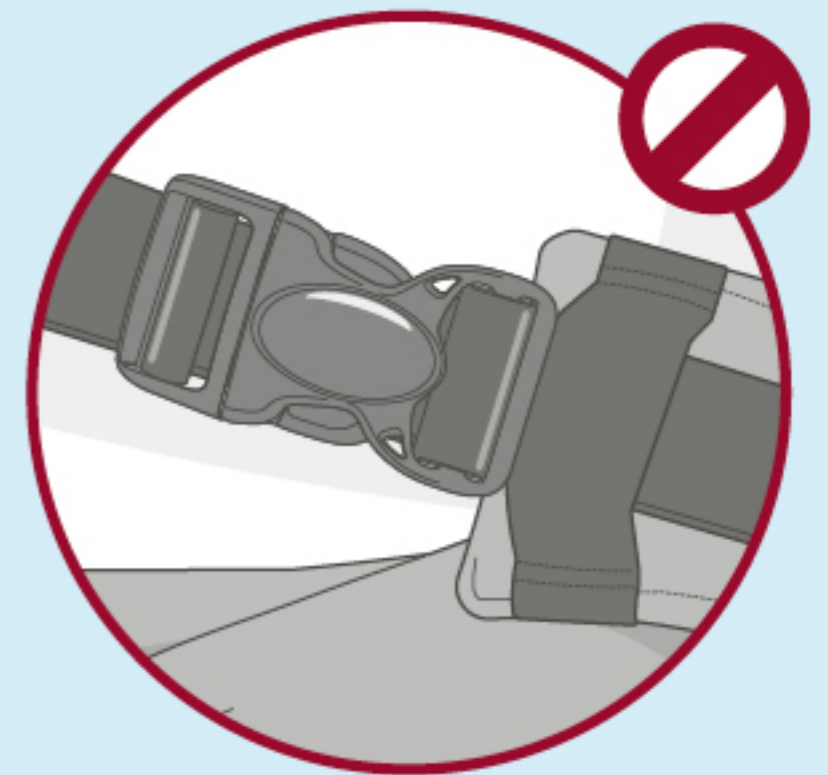
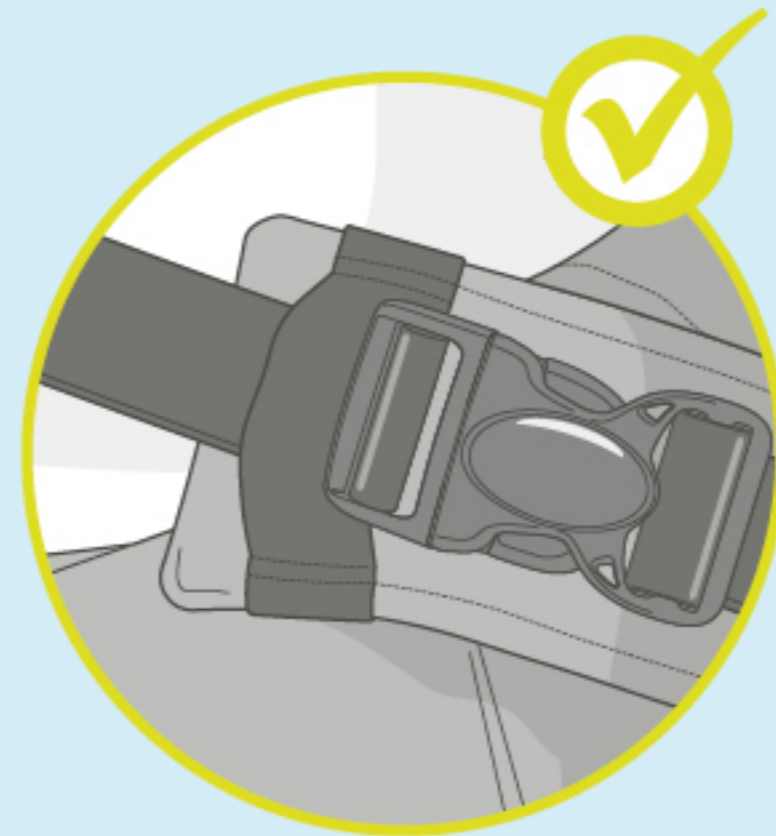
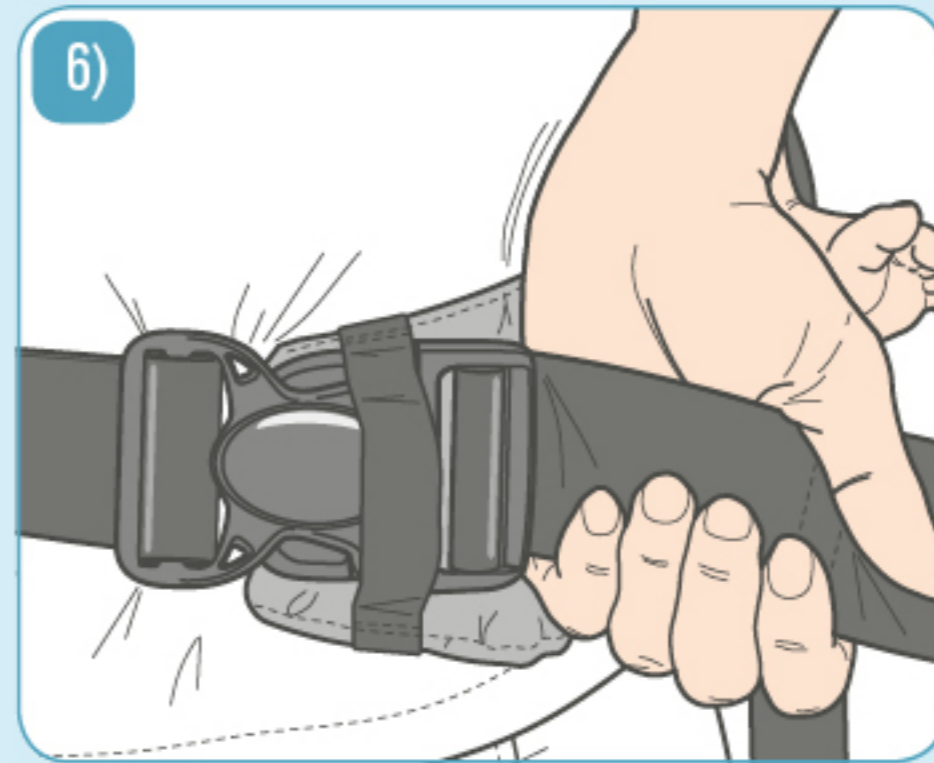
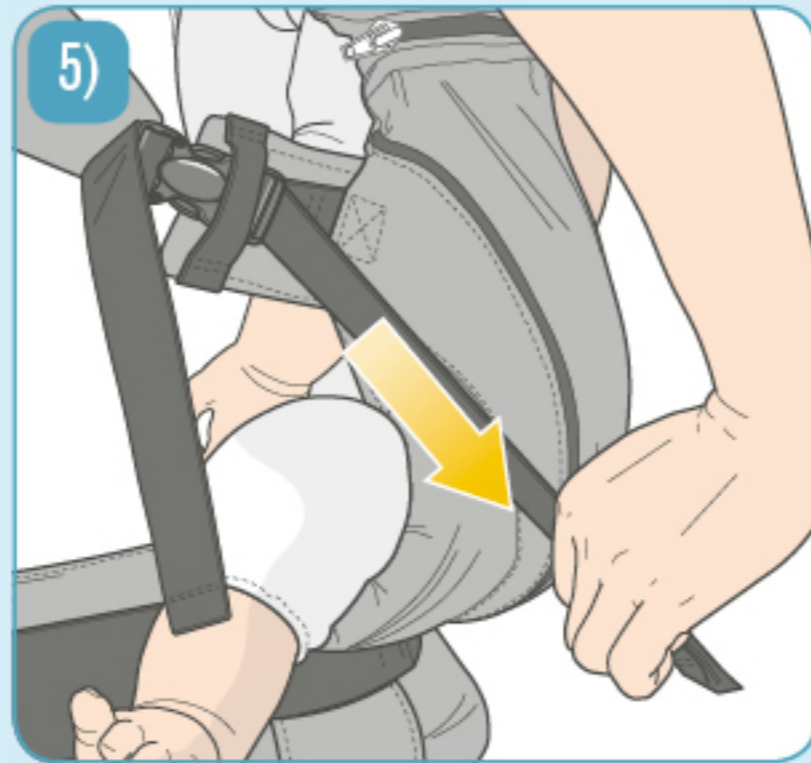

min/max

3,5/20 kg
7.7/44 lbs



manduca®

my baby carrier /
mon porte-bébé

xt

Design and distribution:

Wickelkinder GmbH
Zelterstraße 1
35043 Marburg
Germany

Tel. +49 6424 928690
info@manduca.de