

# manduca<sup>®</sup>

my baby carrier/  
mon porte-bébé

# first

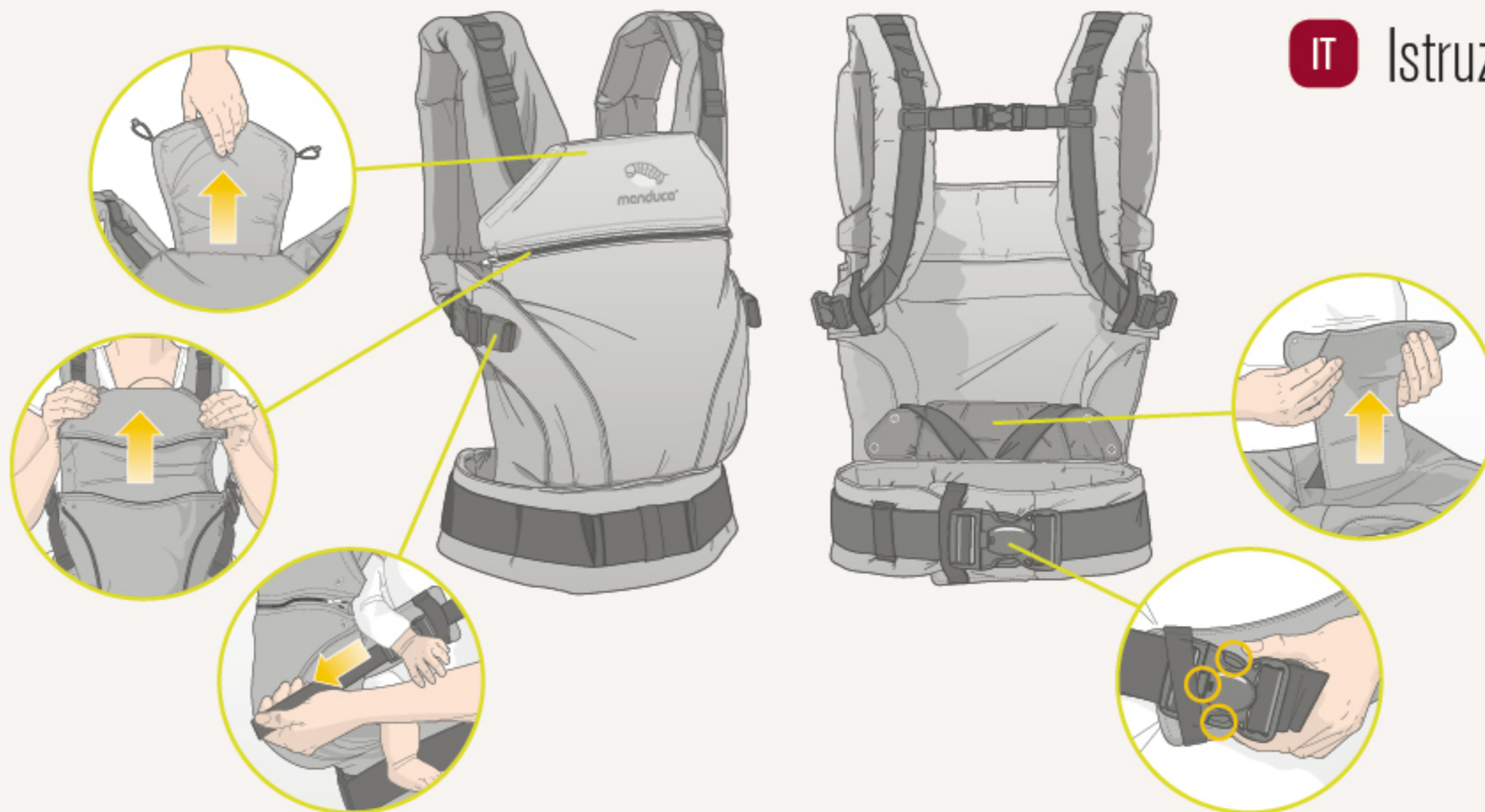

**IT** Istruzioni d'uso

# IMPORTANTE! CONSERVARE LE ISTRUZIONI D'USO PER EVENTUALI RIFERIMENTI FUTURI

Leggere attentamente le presenti istruzioni prima di indossare per la prima volta il marsupio!

## ATTENZIONE

**ATTENZIONE** Controlla attentamente e continuamente il tuo bambino assicurandoti che bocca e naso non siano coperti.

**ATTENZIONE** Consulta un medico prima di usare il prodotto nel caso di bambini prematuri, di poco peso e/o con disturbi.

**ATTENZIONE** Assicurati che il mento del tuo bambino non sia poggiato sul suo petto per evitare disturbi di respirazione che possano provocare soffocamento.

**ATTENZIONE** Metti a sedere il tuo bambino in una posizione sicura nel marsupio per evitare che possa cadere giù.

Alcune attività richiedono prudenza, ad esempio mentre si cucina o si fanno le pulizie, oppure in prossimità di fonti di calore o di bevande calde.

Utilizza il marsupio sempre per portare un solo bambino.

Il marsupio è stato progettato esclusivamente per portare il tuo bimbo rivolto verso di te.

Il vostro equilibrio può essere compromesso dal movimento vostro e del bambino.

Fare attenzione quando ci si piega o china in avanti o lateralmente.

Non usare il marsupio durante l'attività sportiva come corsa, bicicletta, nuoto e sci.

Il rischio di cadere giù dal marsupio aumenta una volta che il tuo bambino diventa più mobile e attivo.

## CONSERVAZIONE E CURA

Tieni il marsupio fuori dalla portata di bambini quando non in uso.

Controllare regolarmente il marsupio per individuare eventuali segni d'usura, inclusi cuciture e stoffa lacerati.

Chiudi tutte le fibbie prima del lavaggio e quando riponi il marsupio non utilizzato.



Detersivo per capi delicati

# manduca<sup>®</sup> my baby carrier / mon porte-bébé first



4

Reggitesta



5

I primi passi



8

Riduttore della seduta



10

Marsupio ventrale



18

Sul fianco



22

Marsupio dorsale



# Reggitesta





## I primi passi

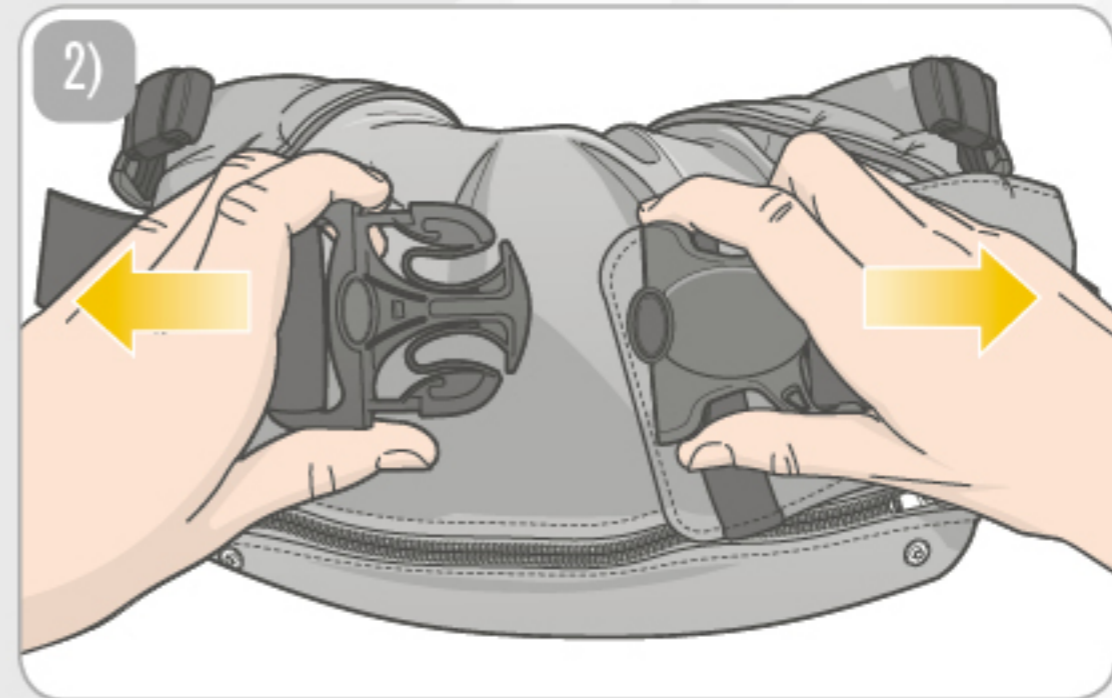
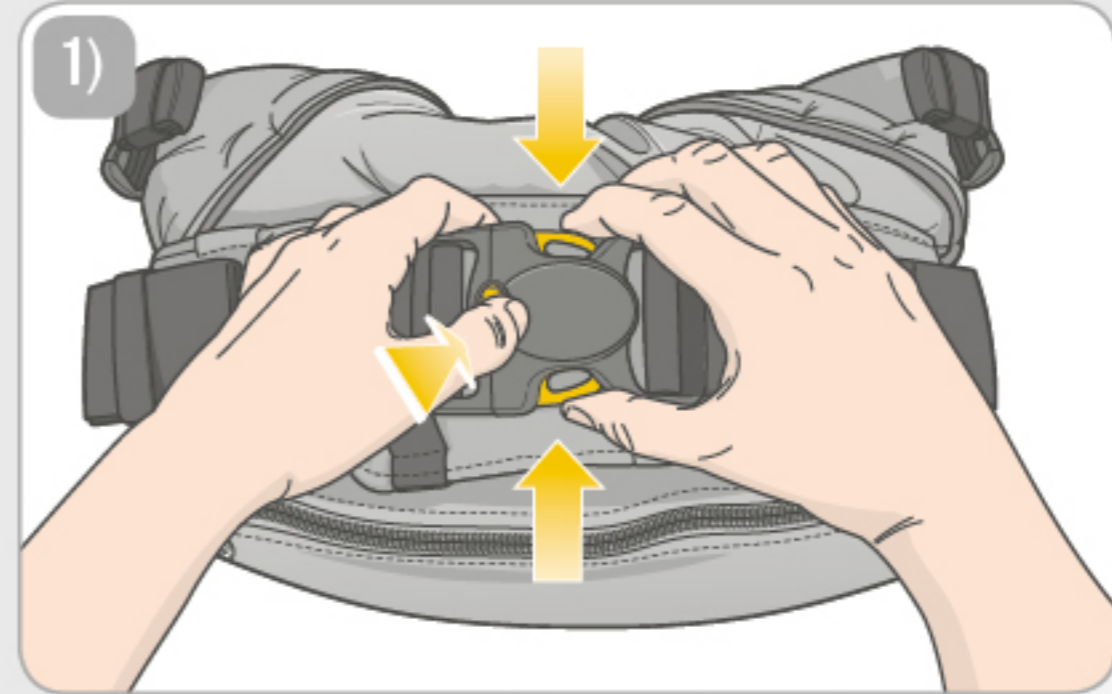
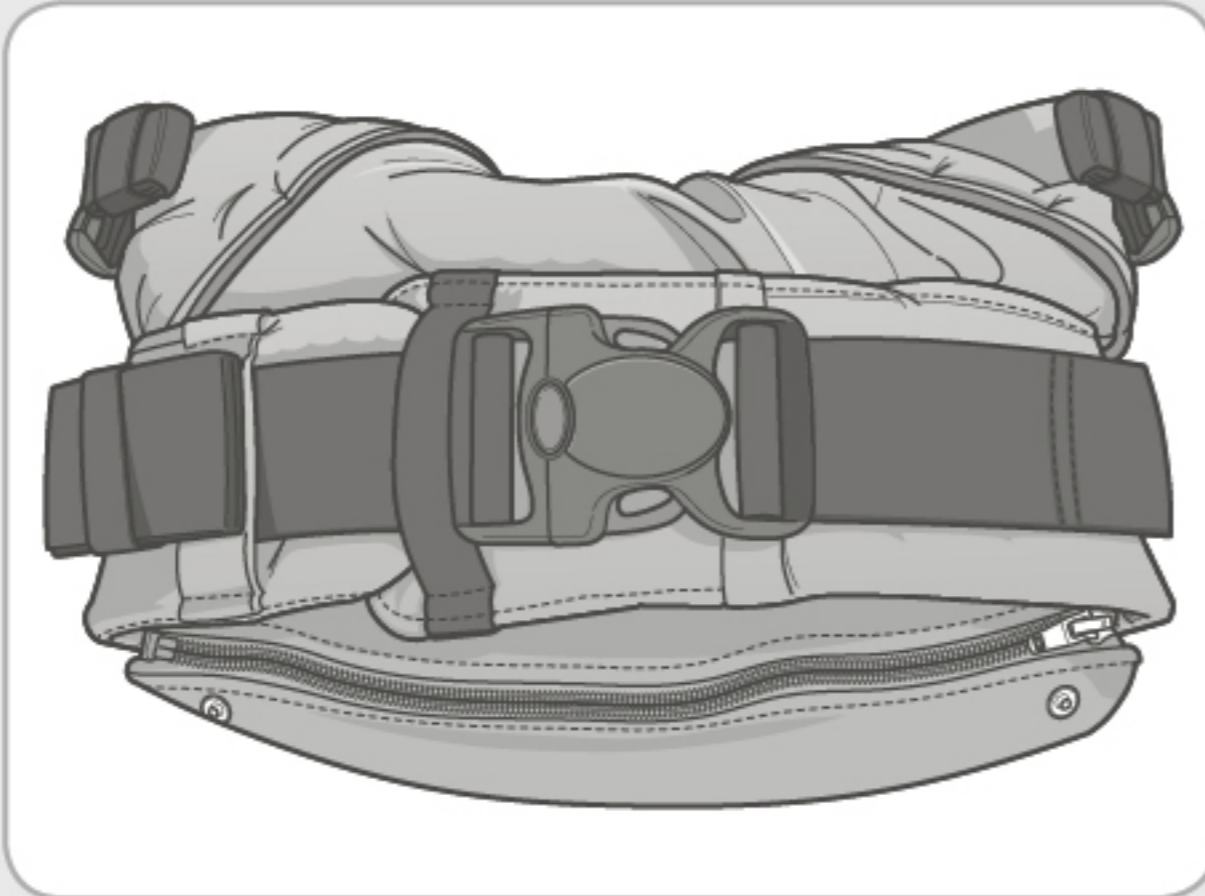

3)

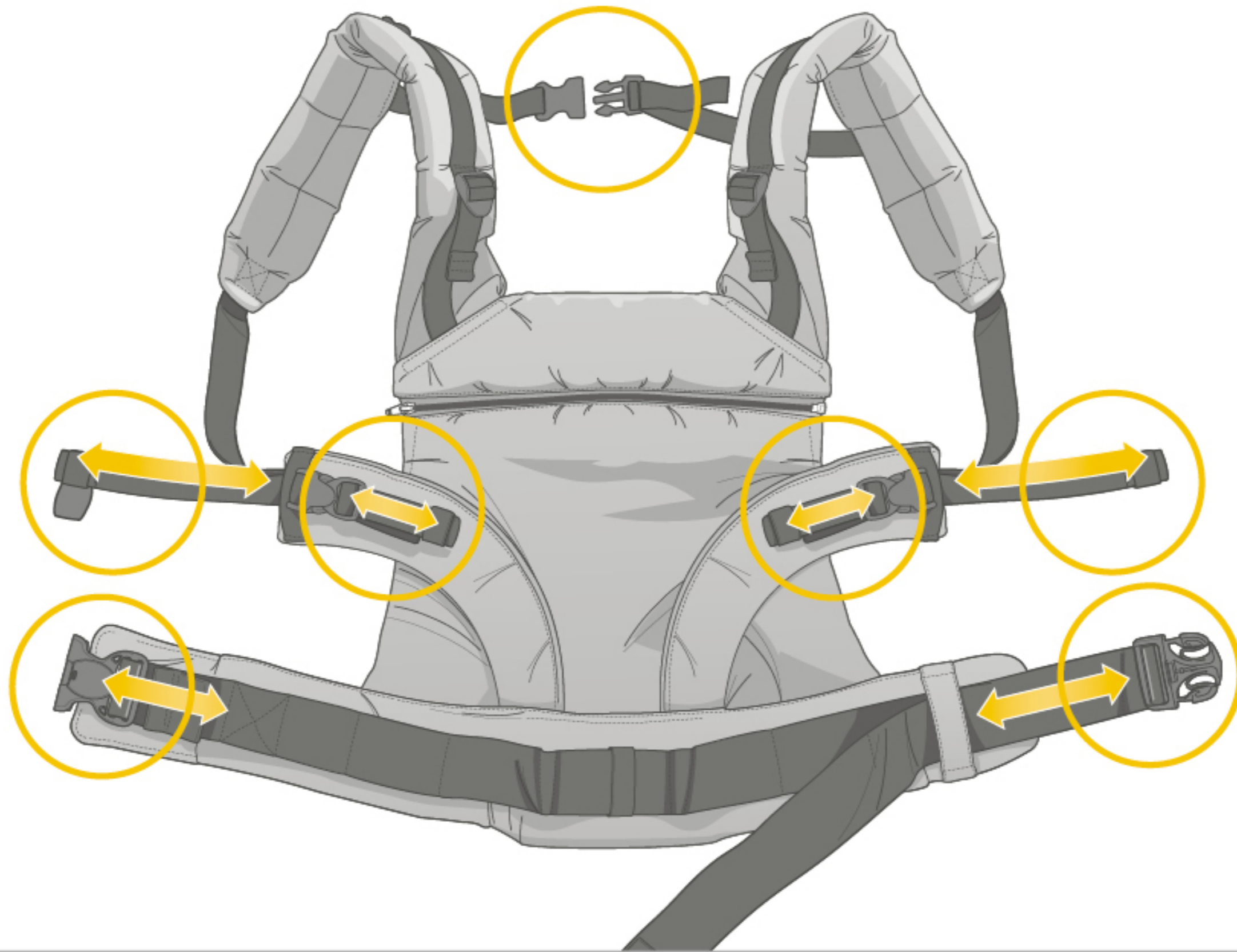



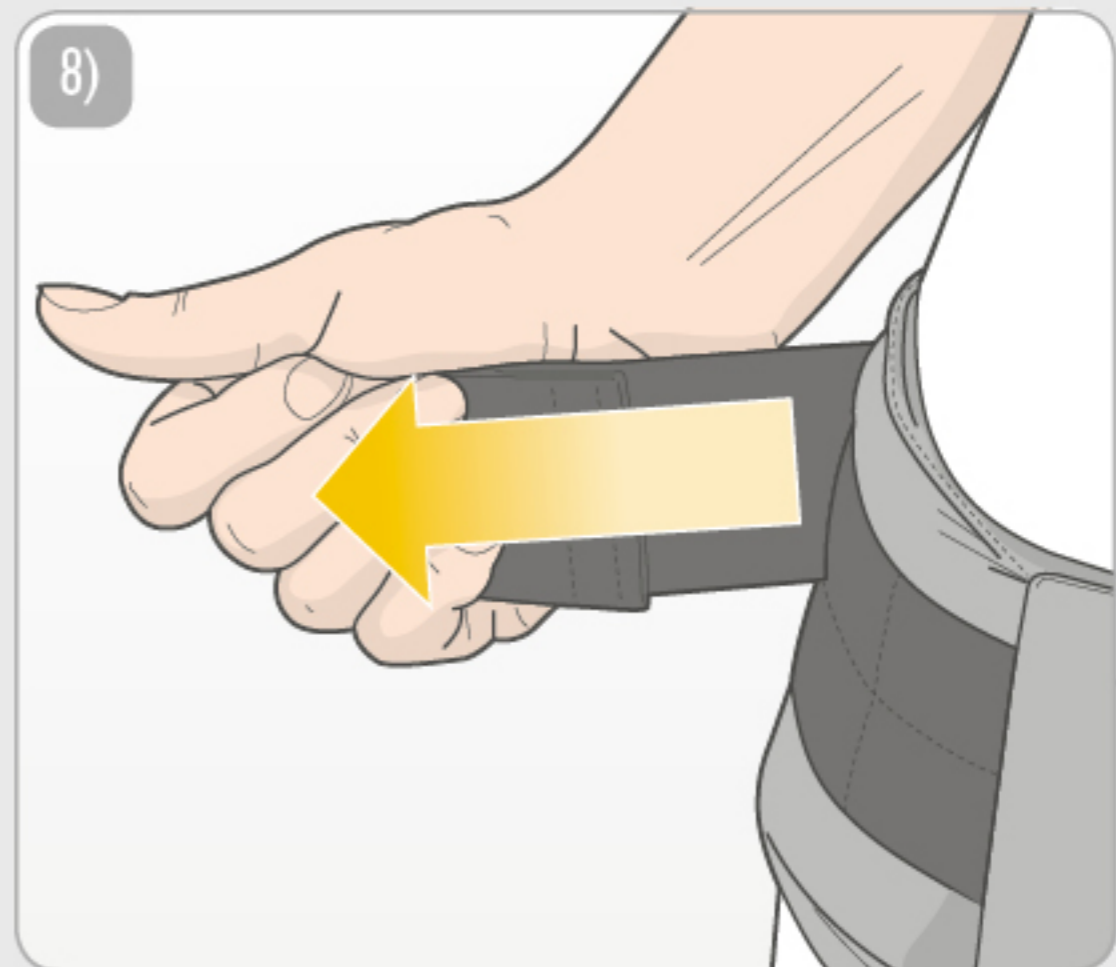
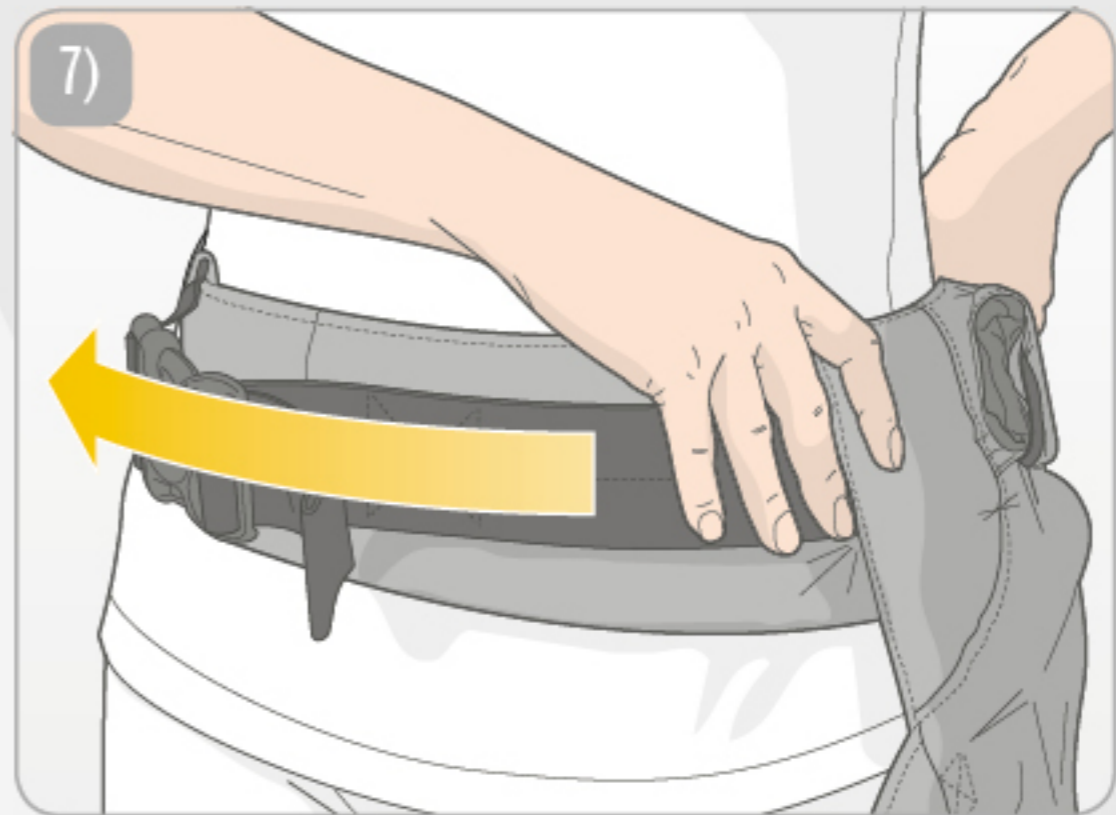
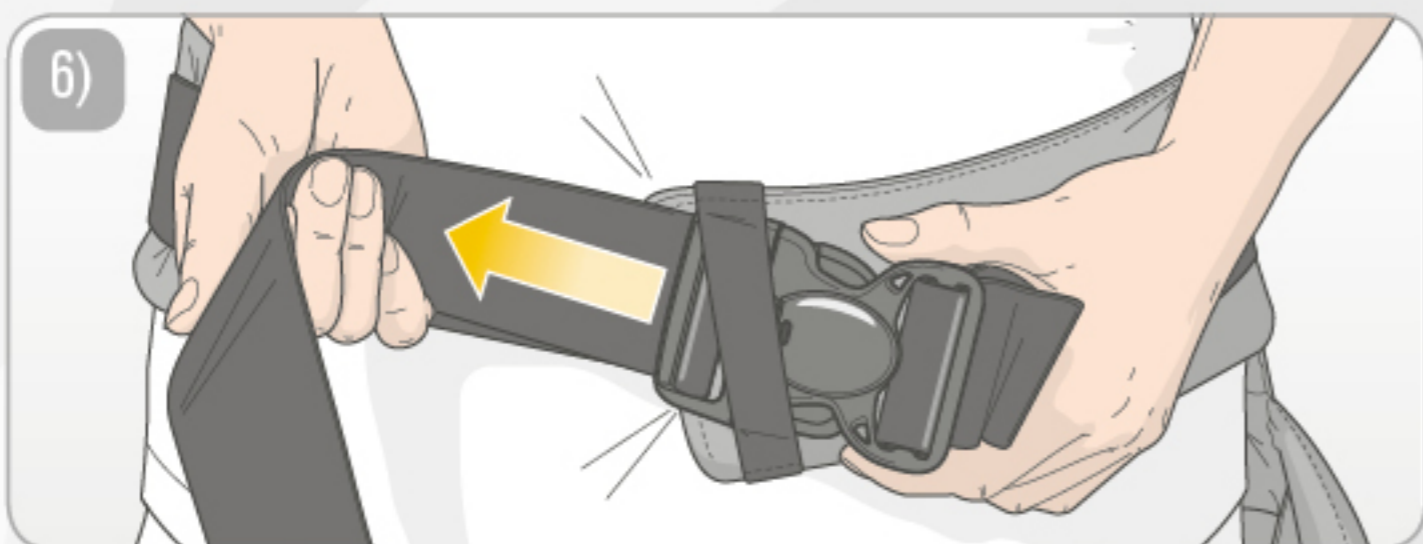
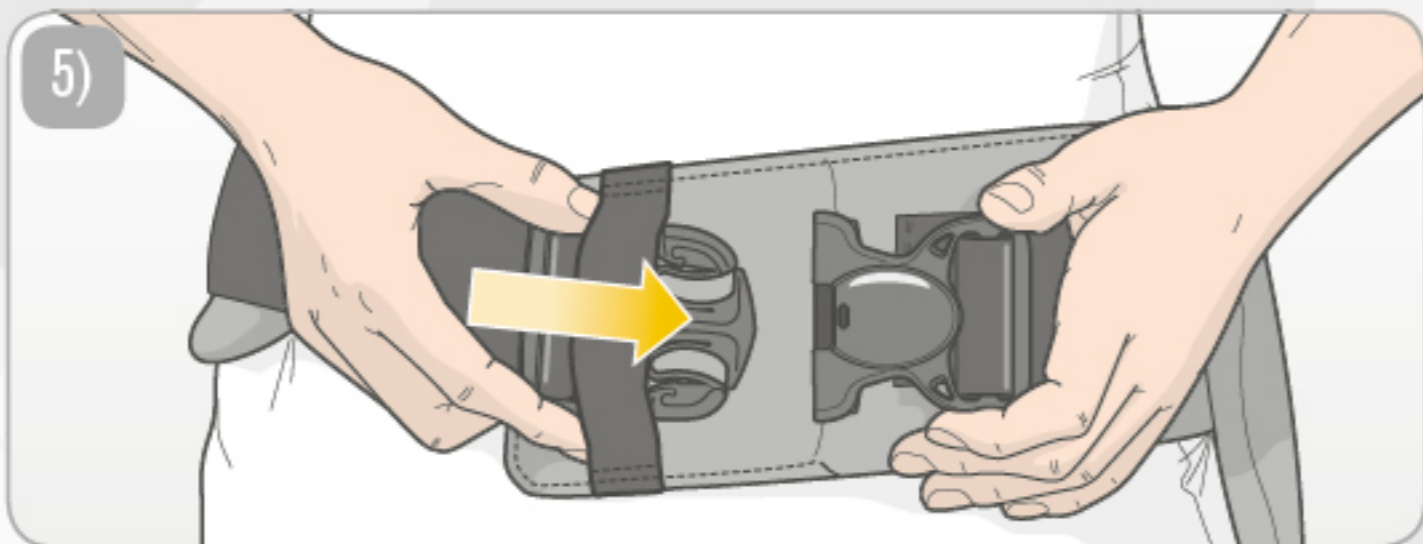
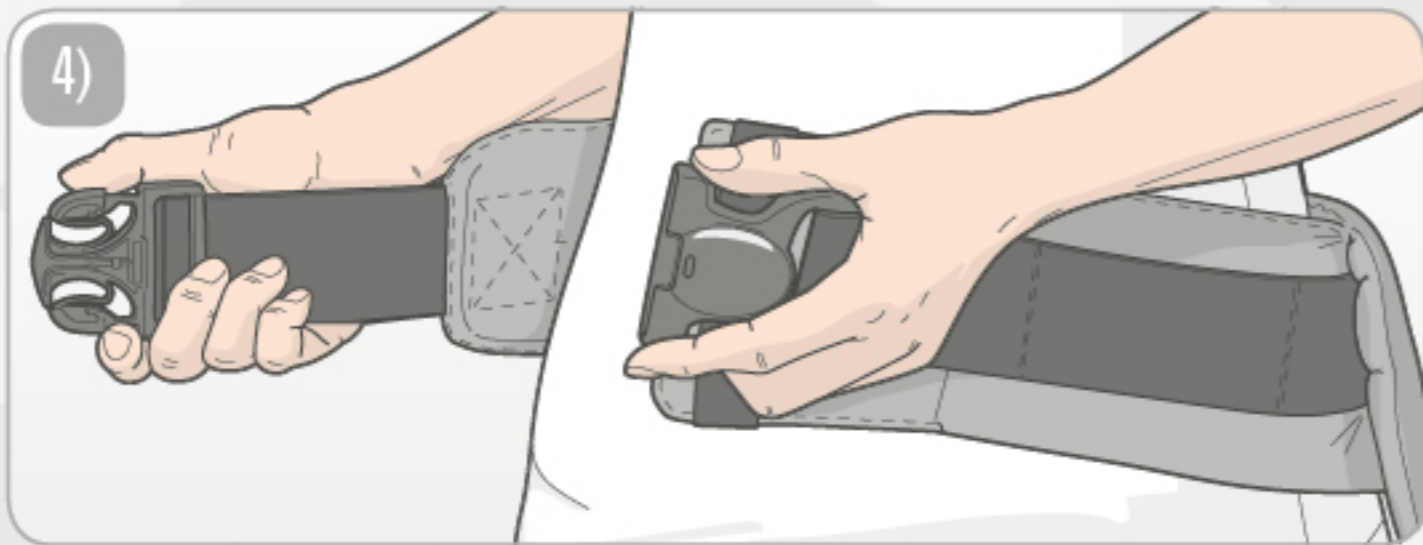



<3 mo.



## Riduttore della seduta





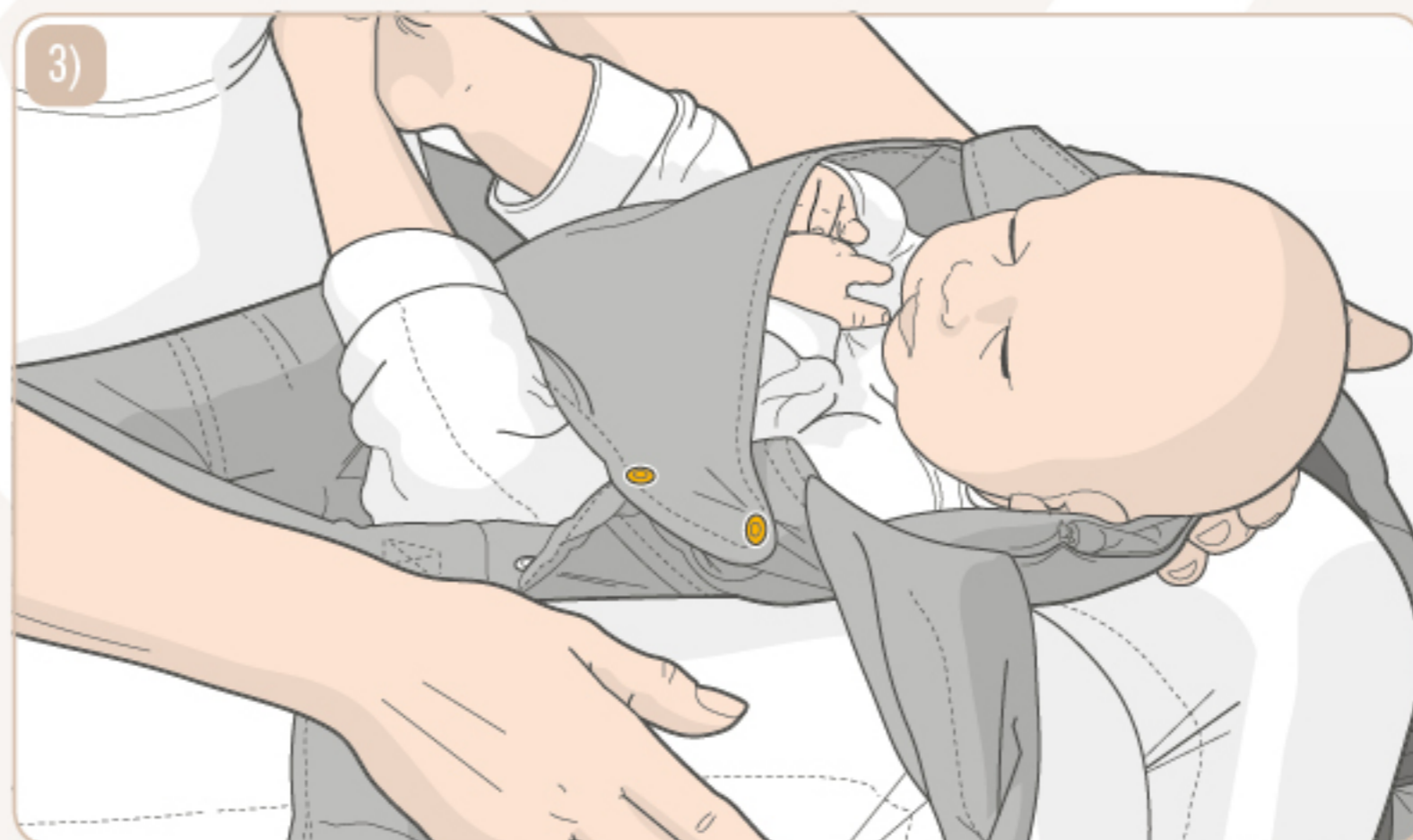
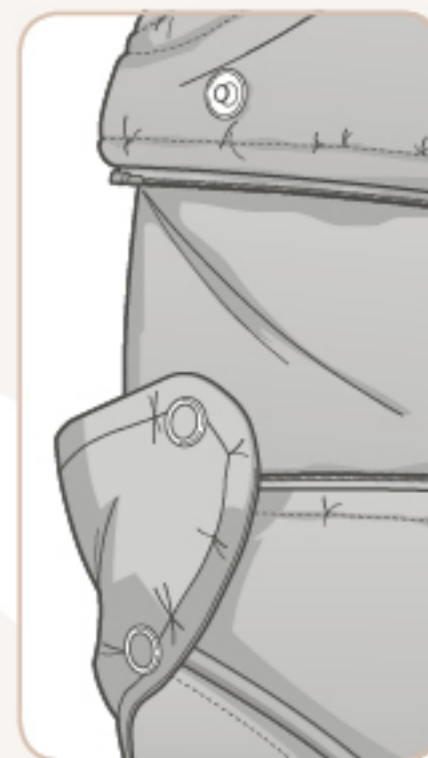
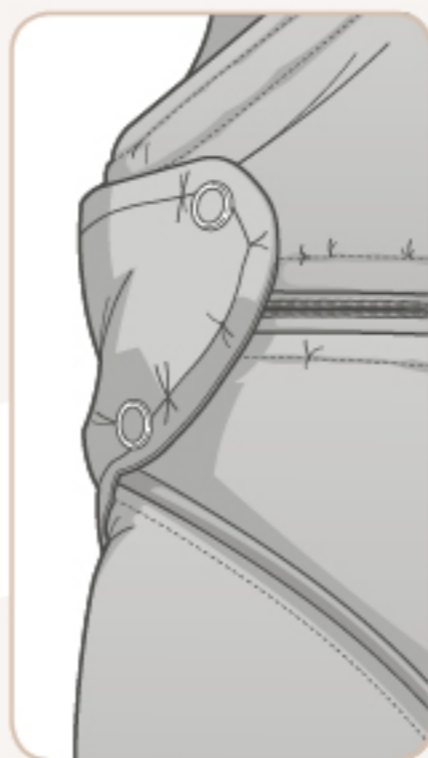
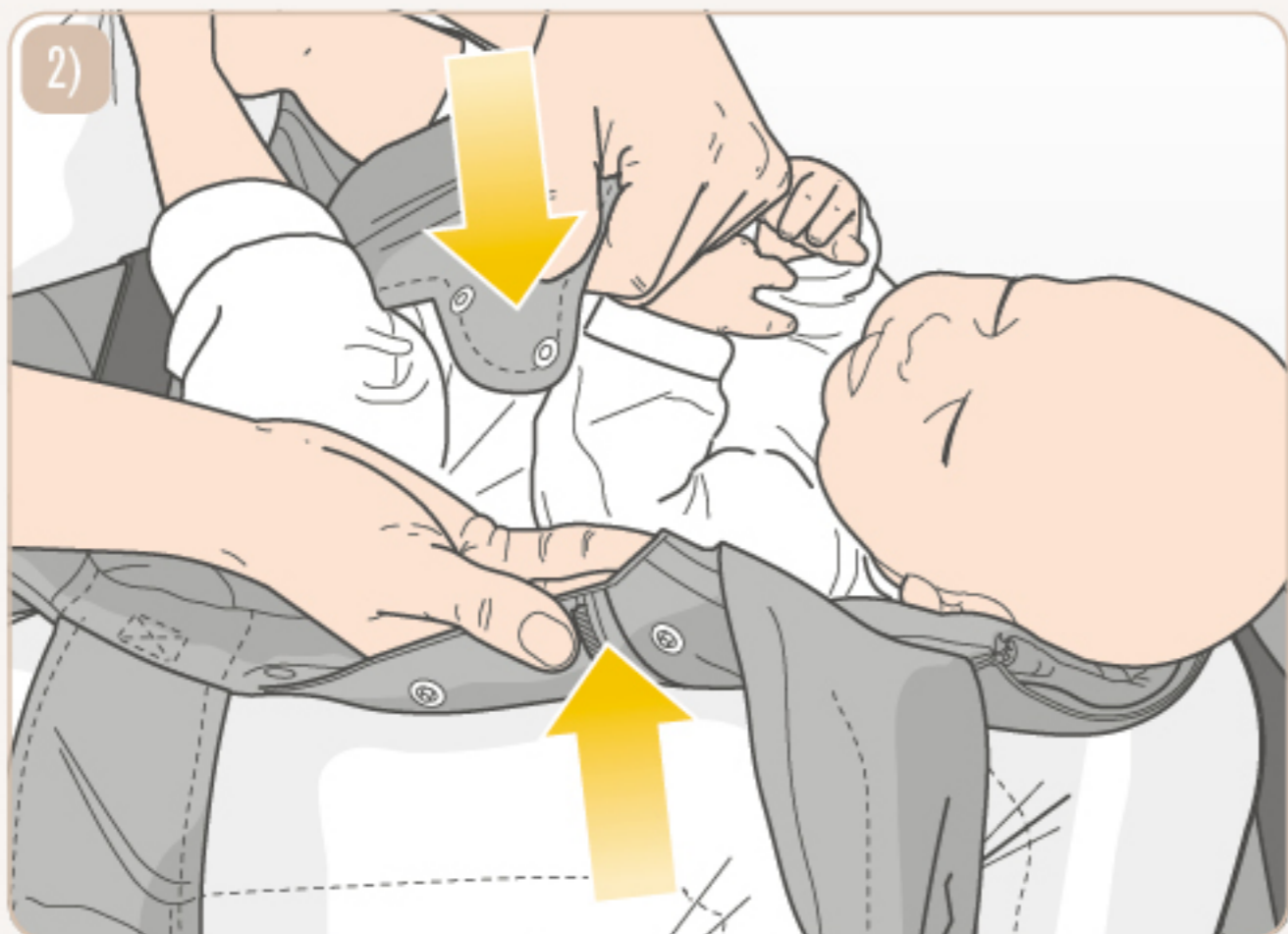



## Marsupio ventrale









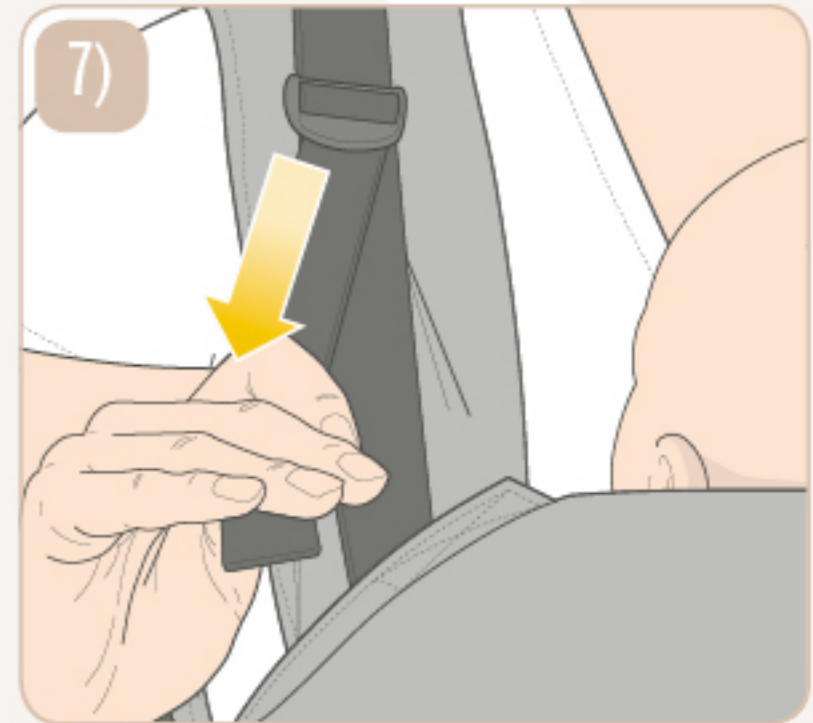
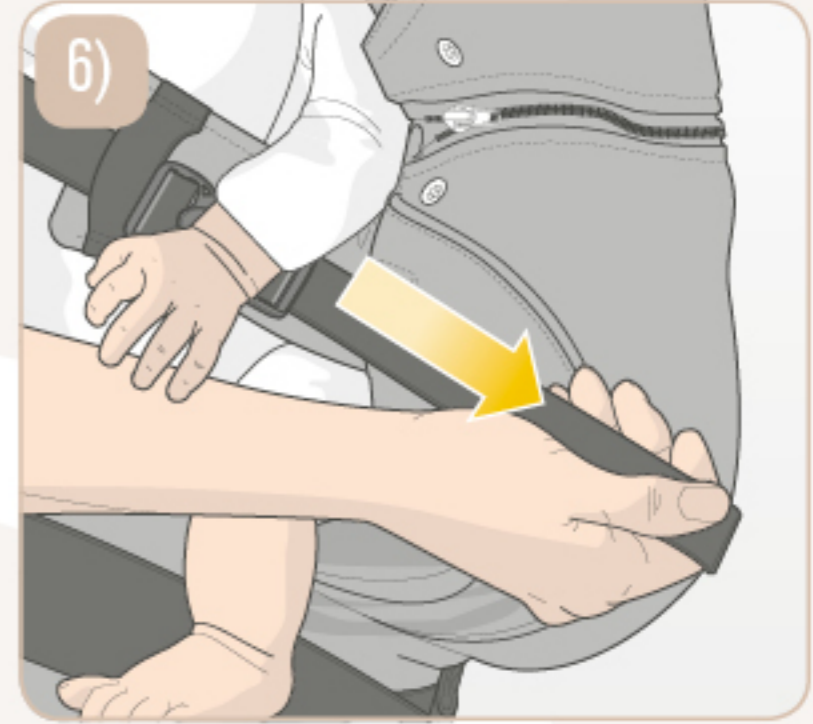
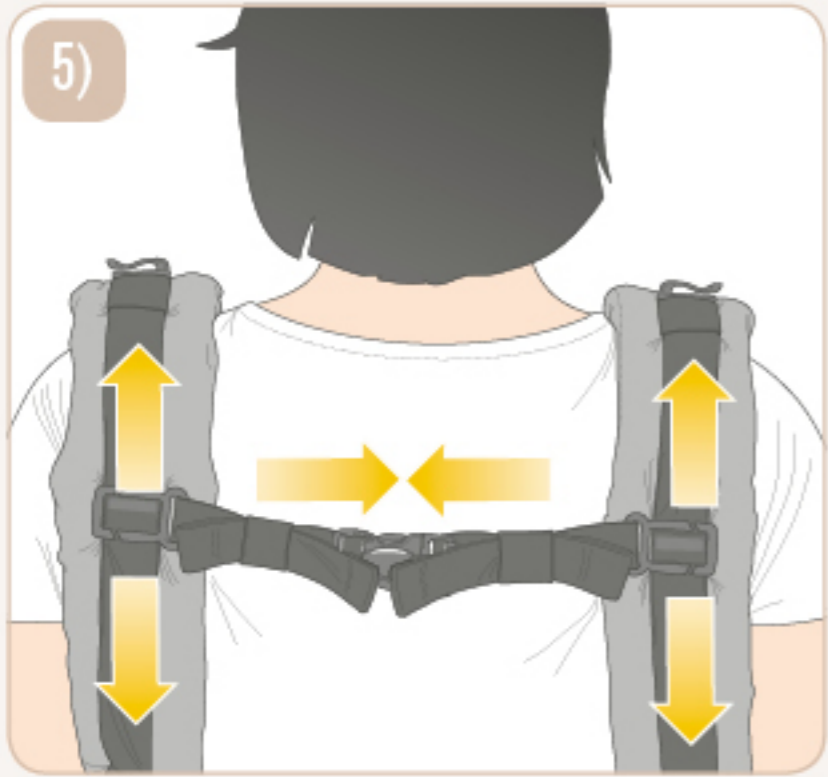

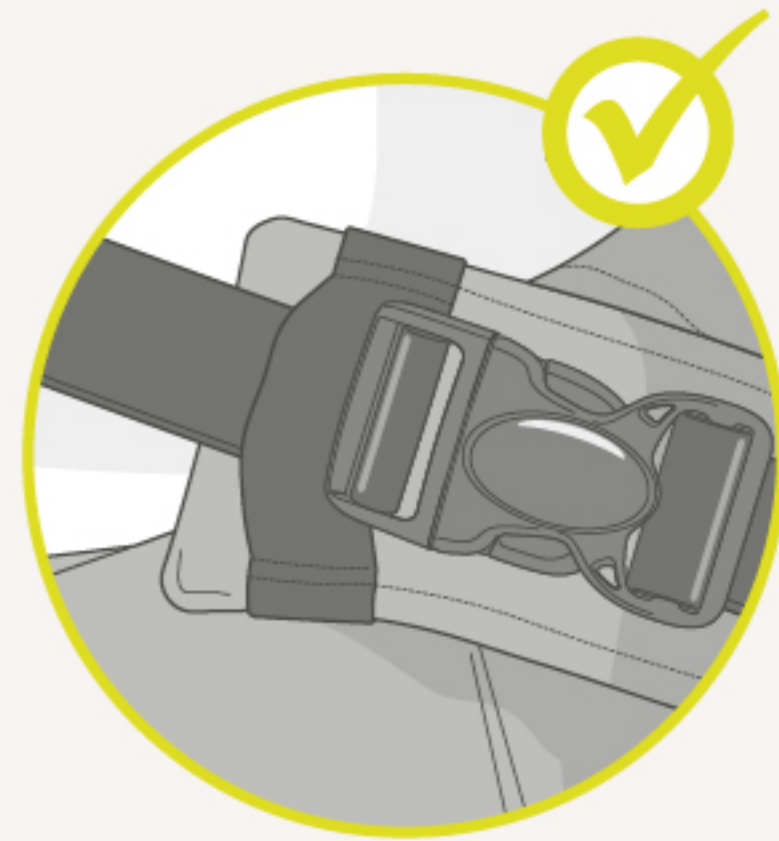
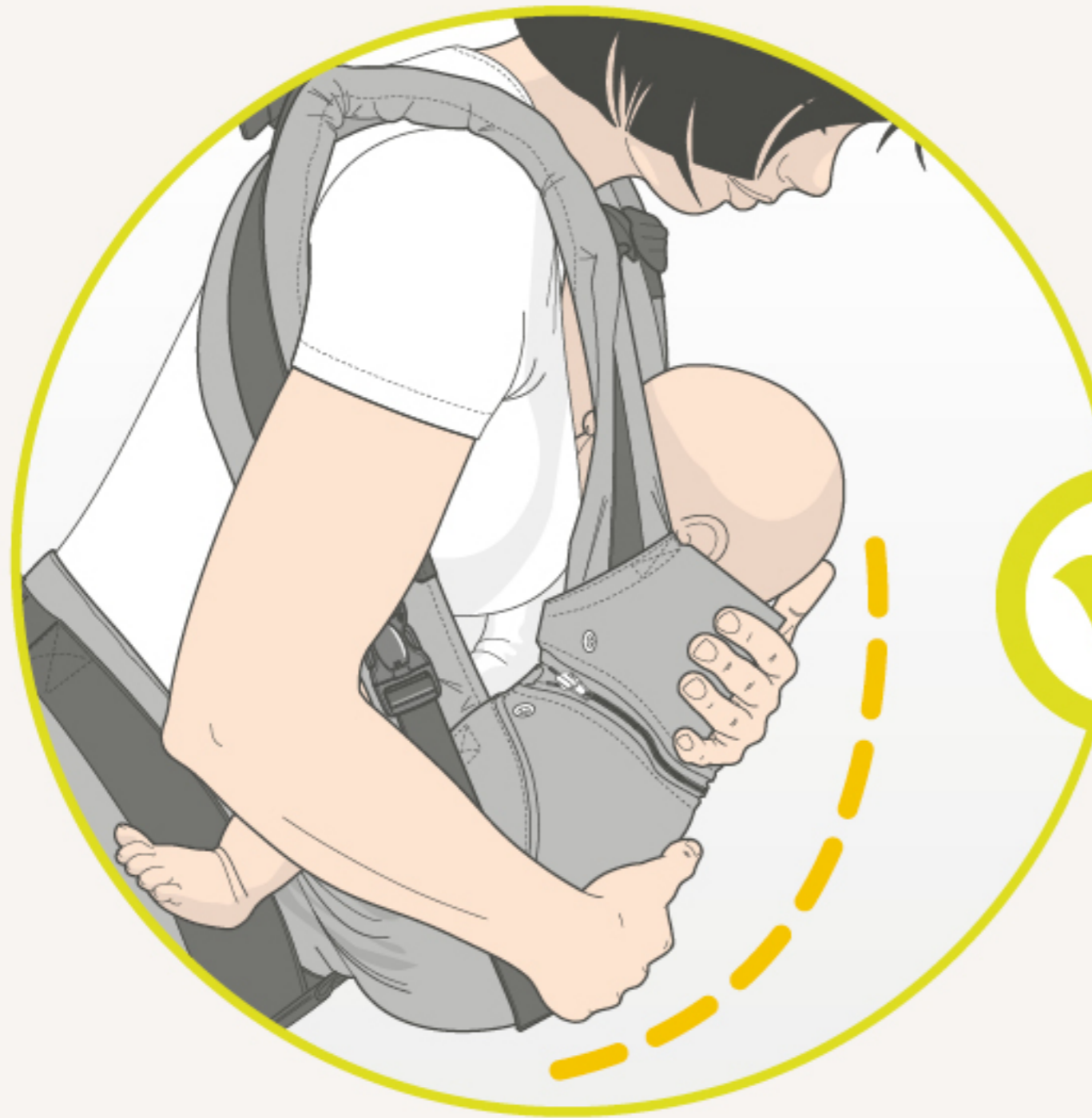



## Marsupio ventrale

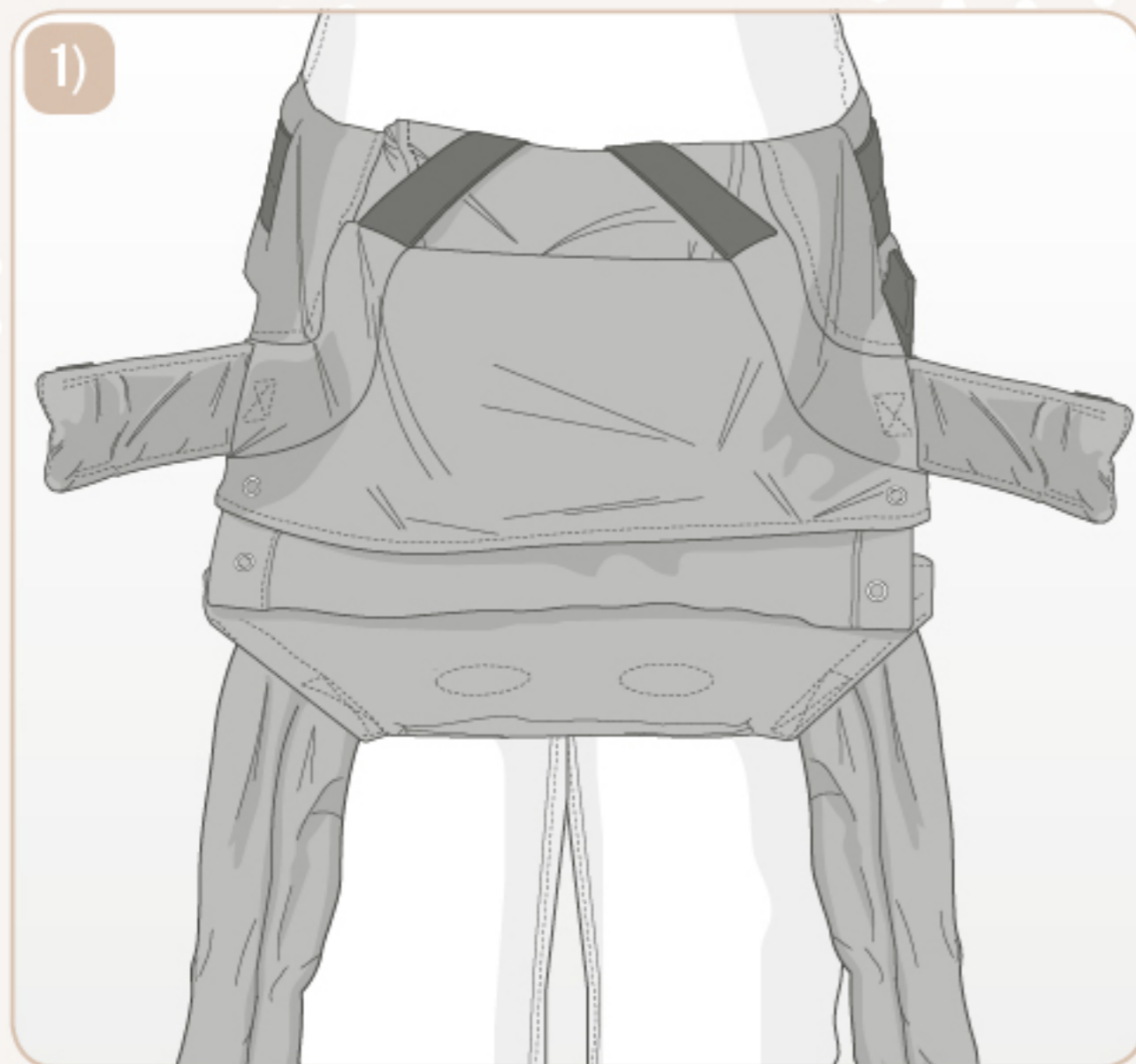



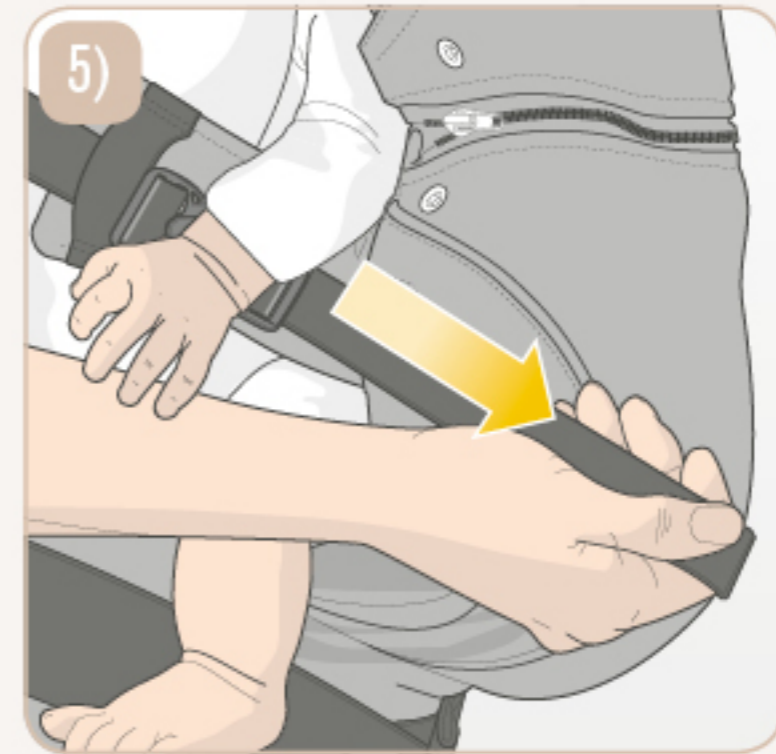
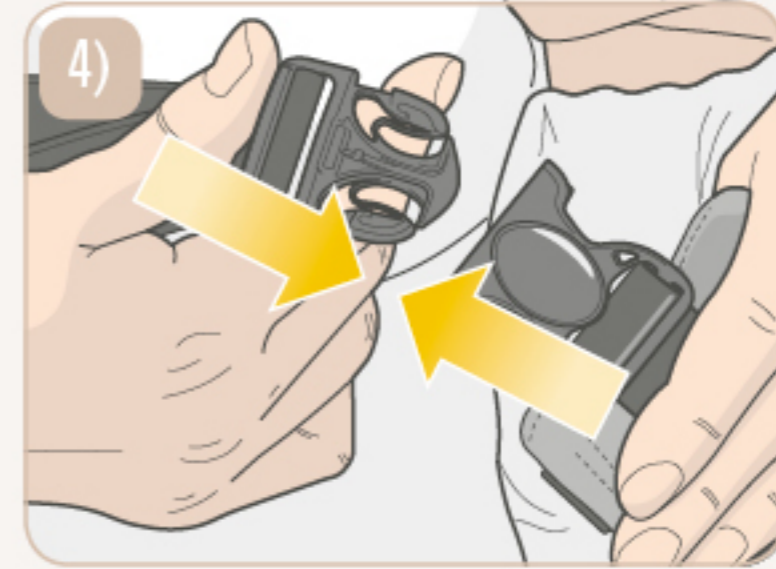
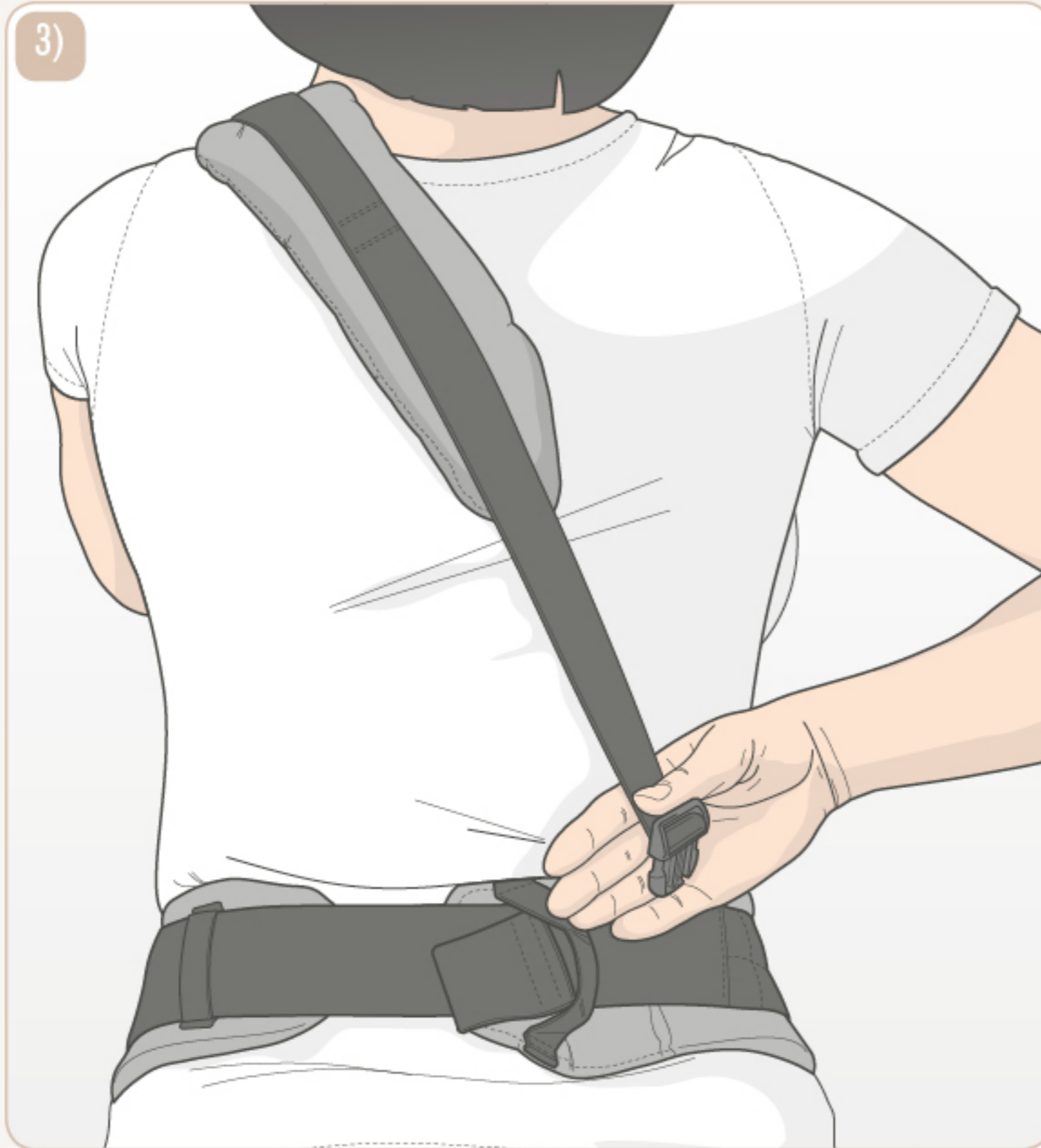

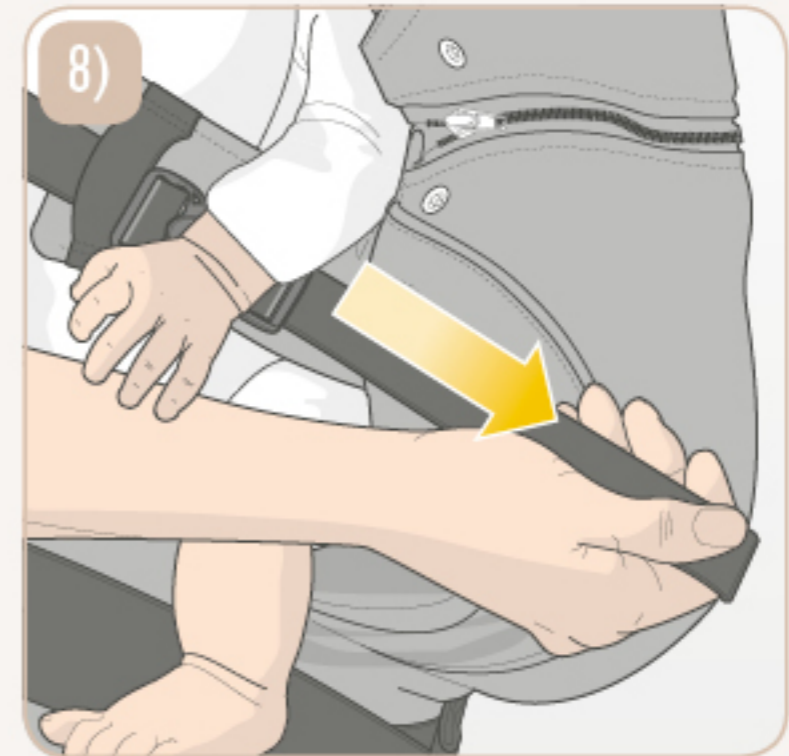
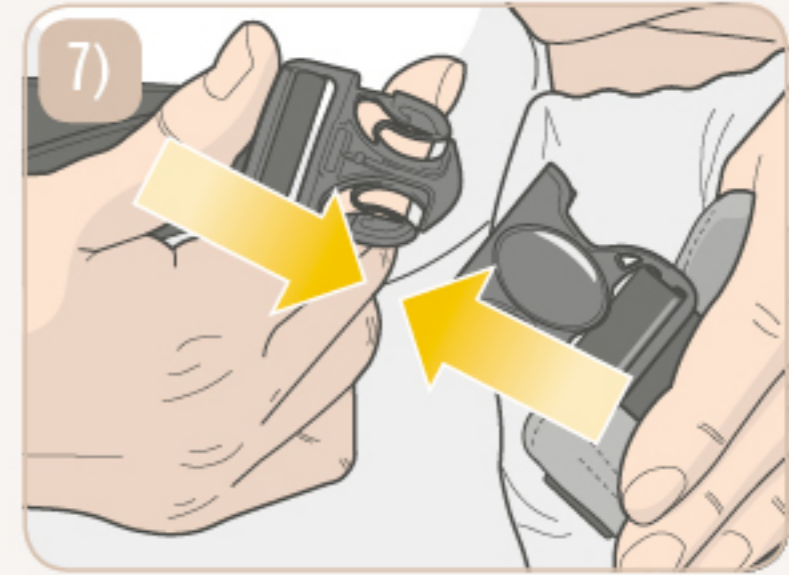
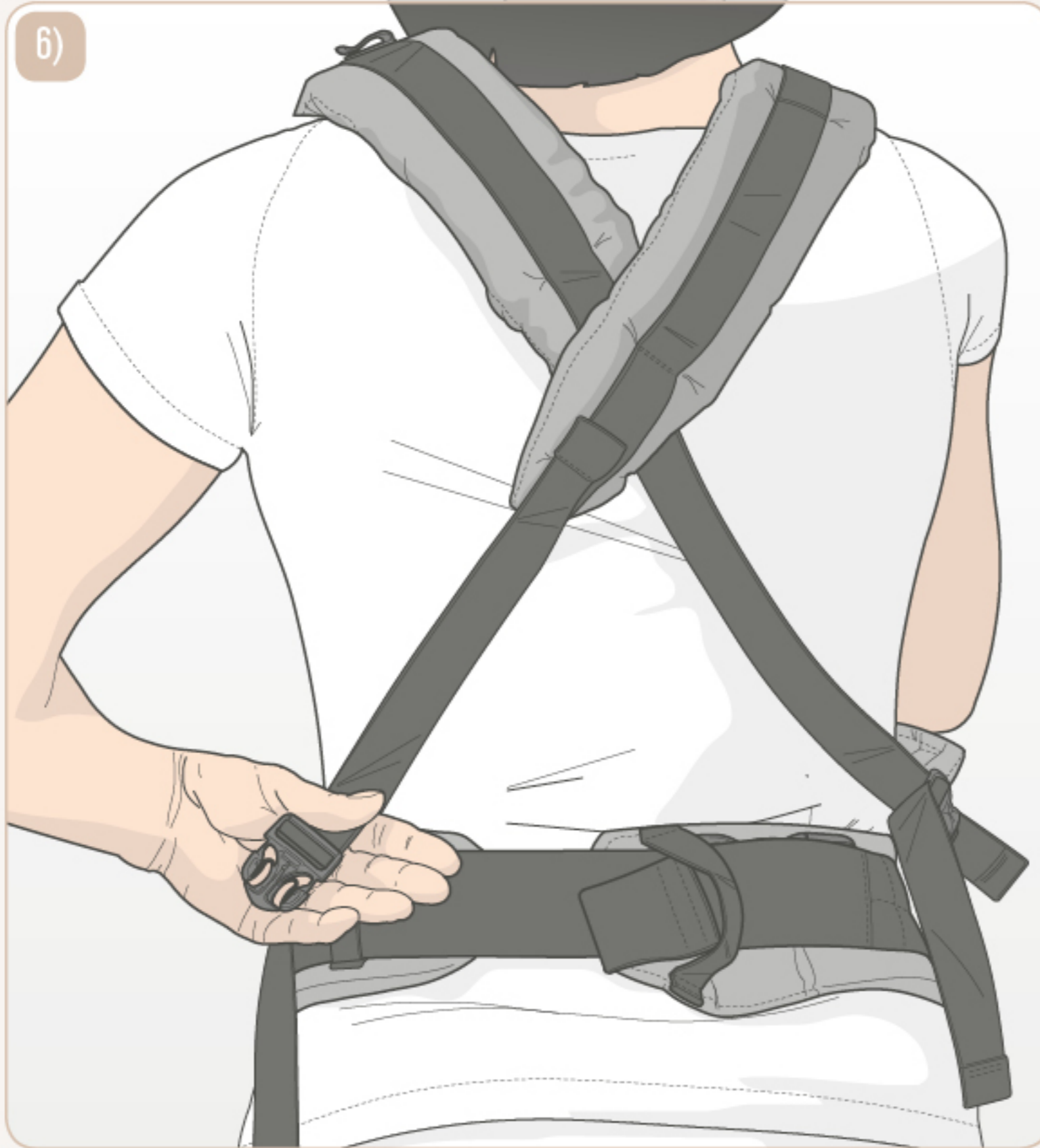

# manduca®

my baby carrier /  
mon porte-bébé

# first

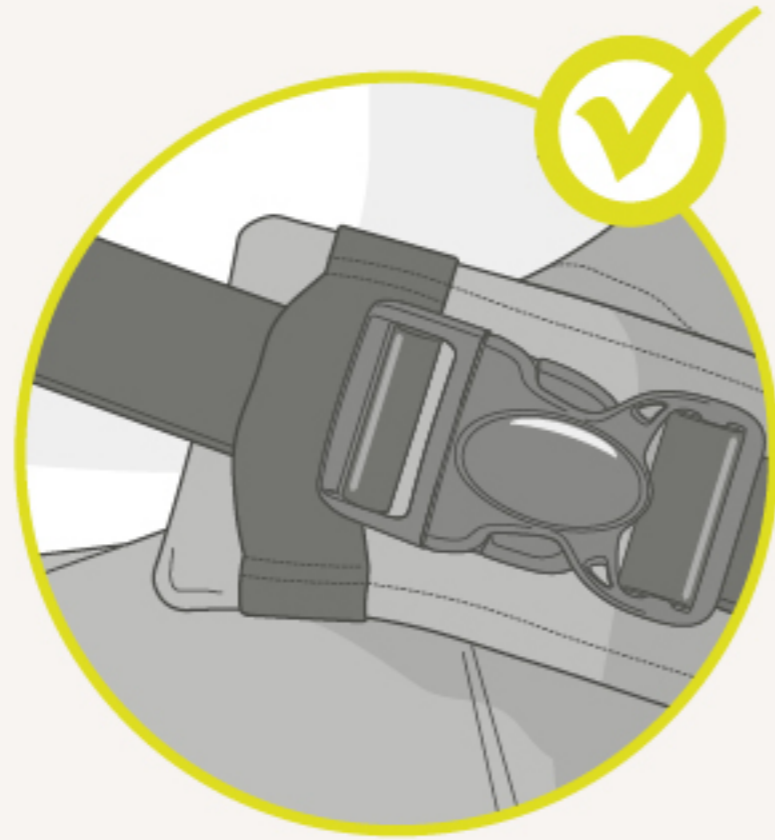





>3 mo. Sul fianco

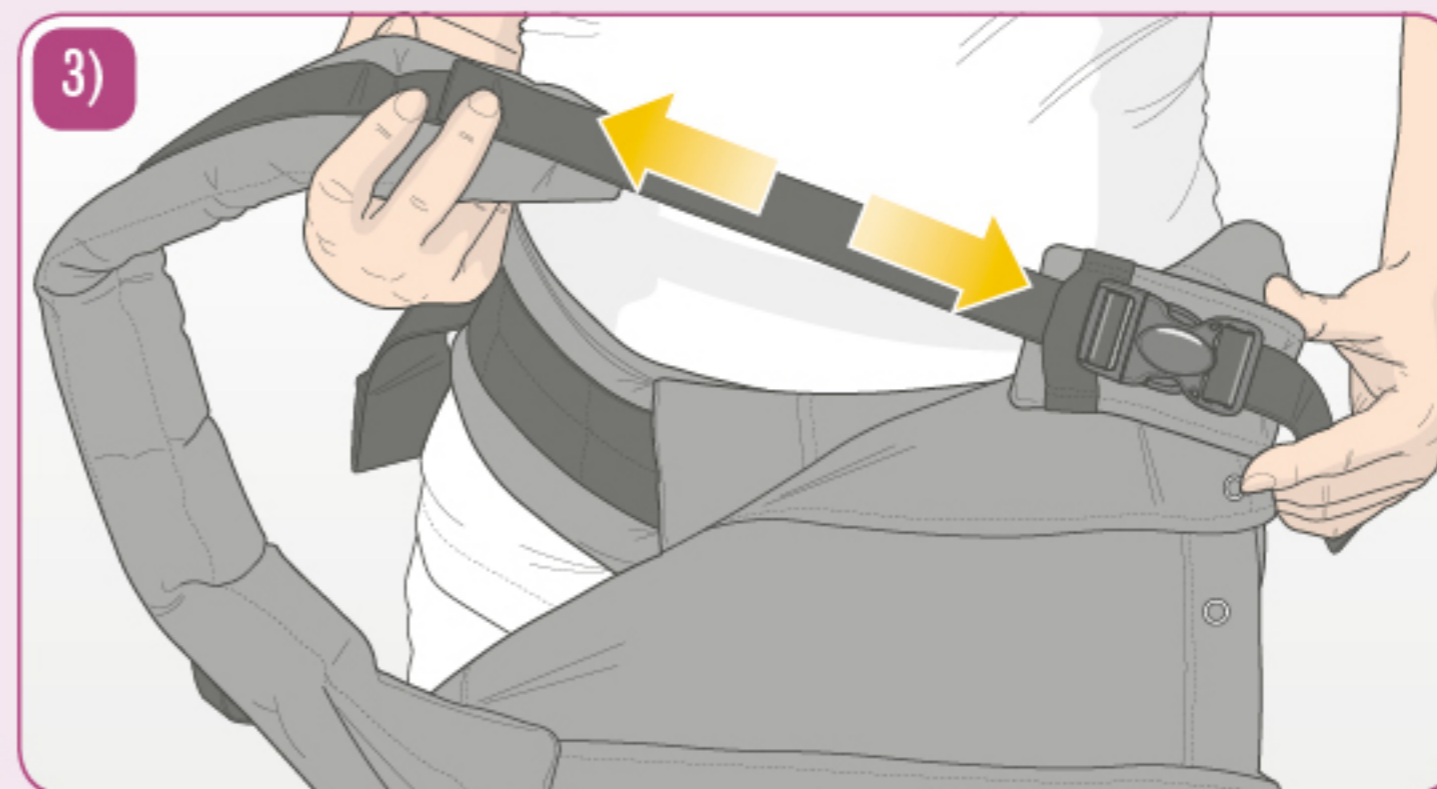
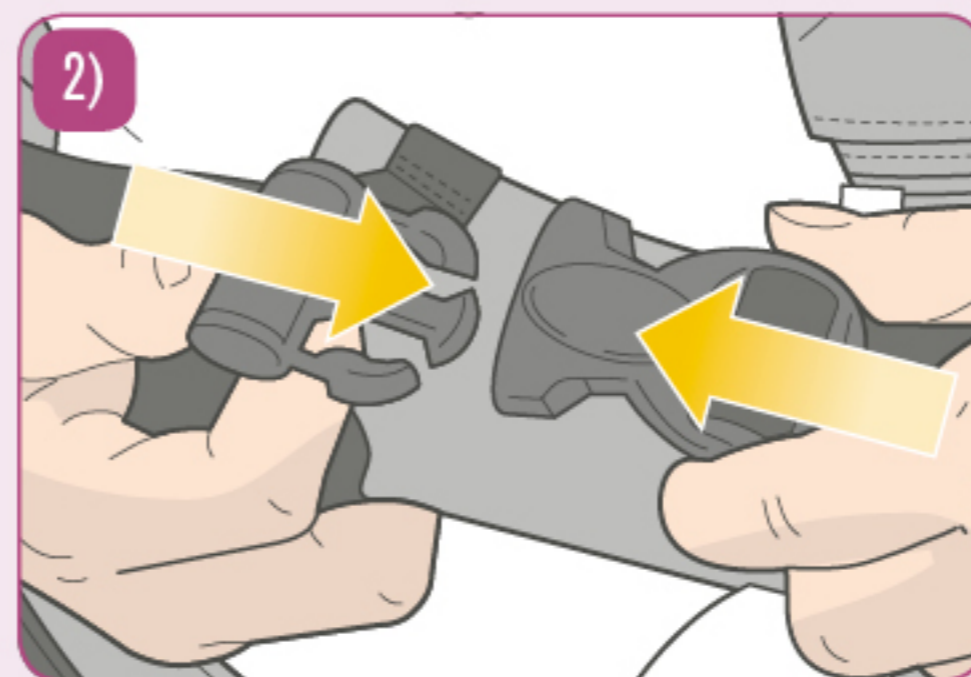
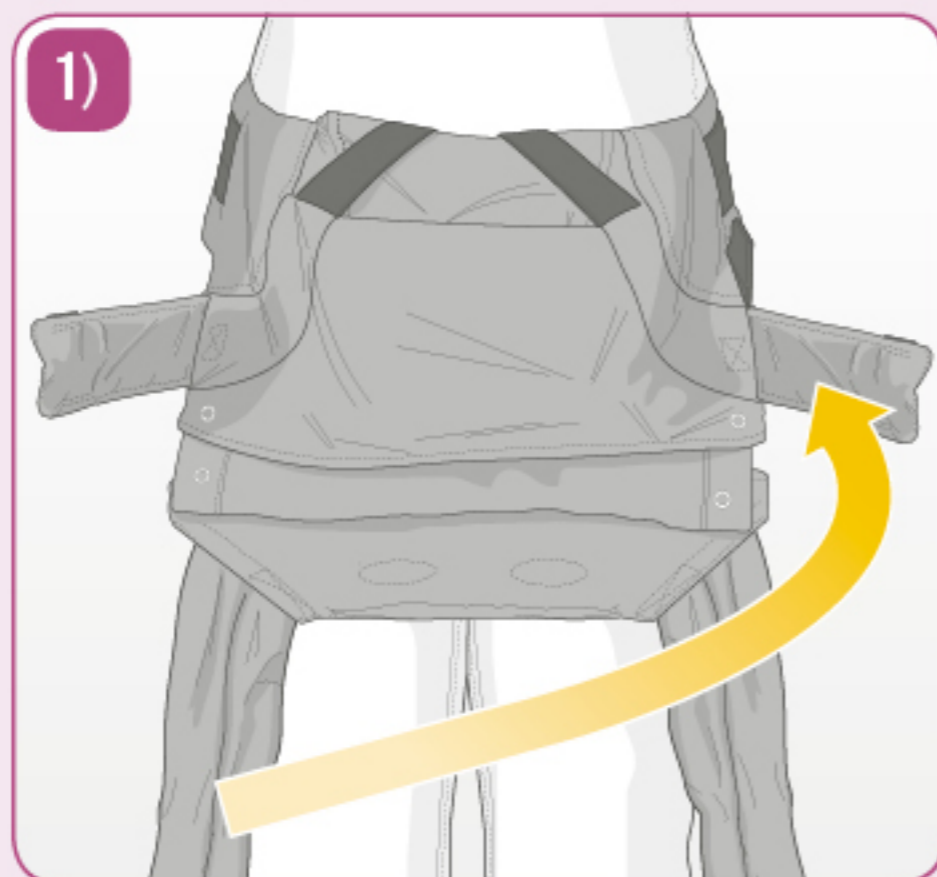

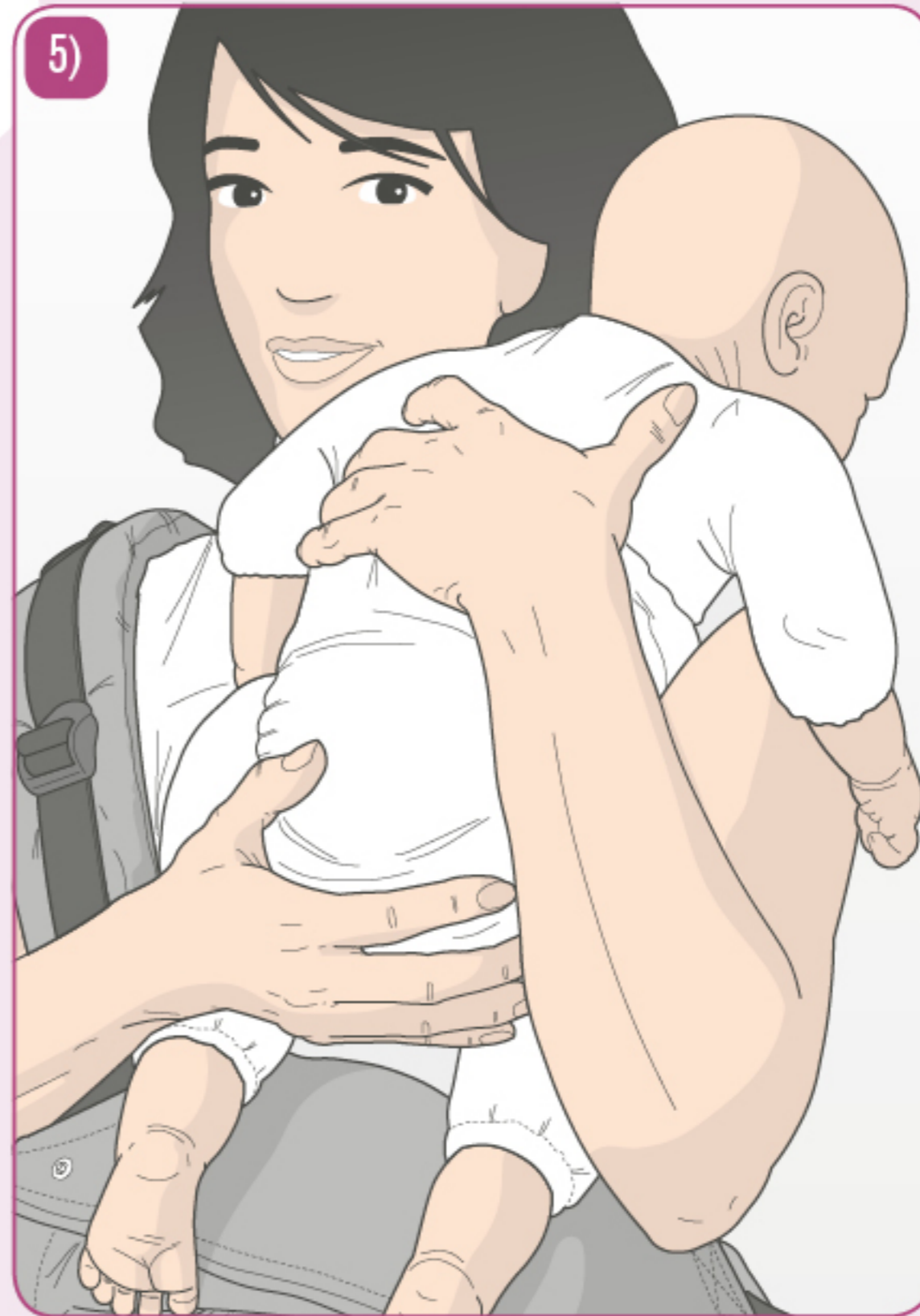



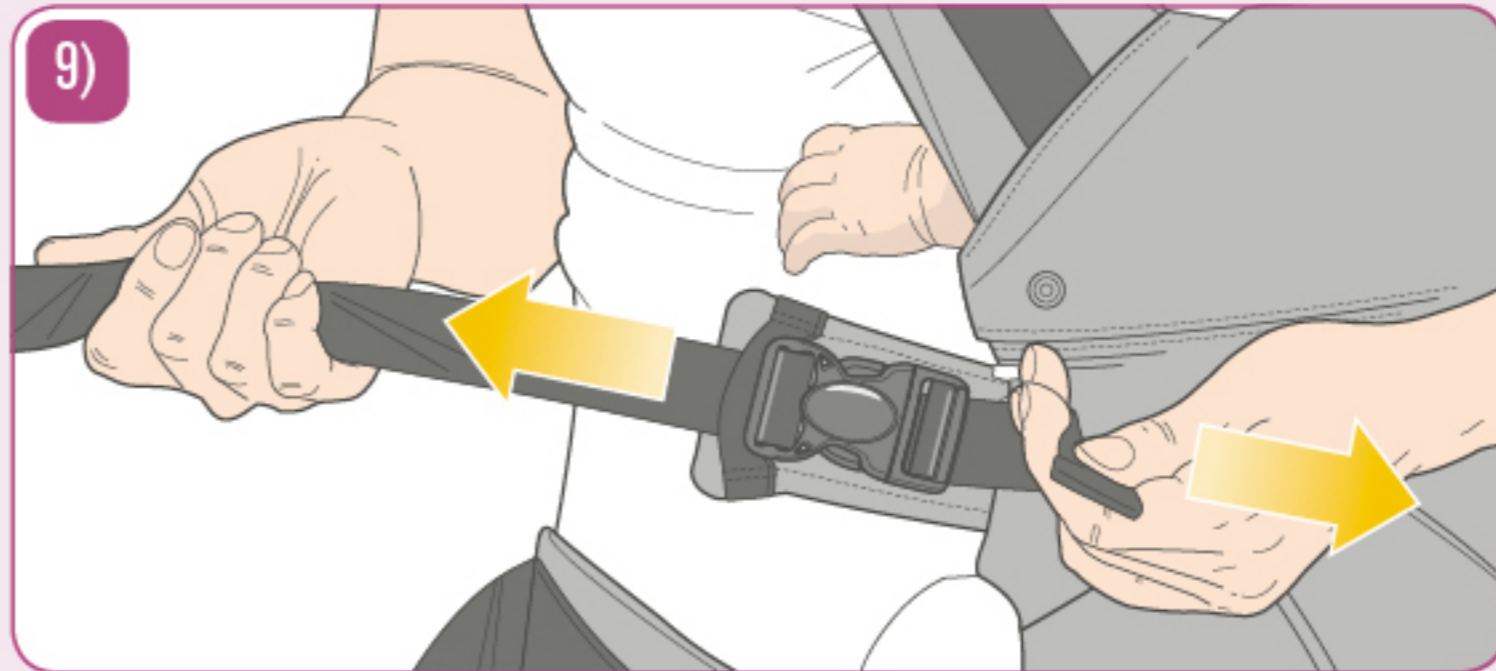
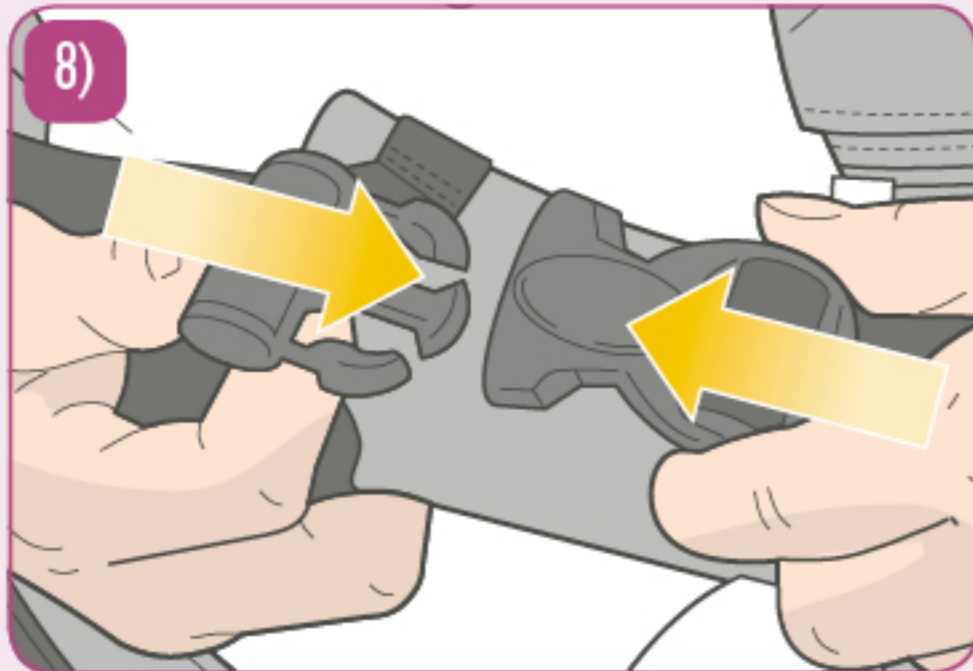
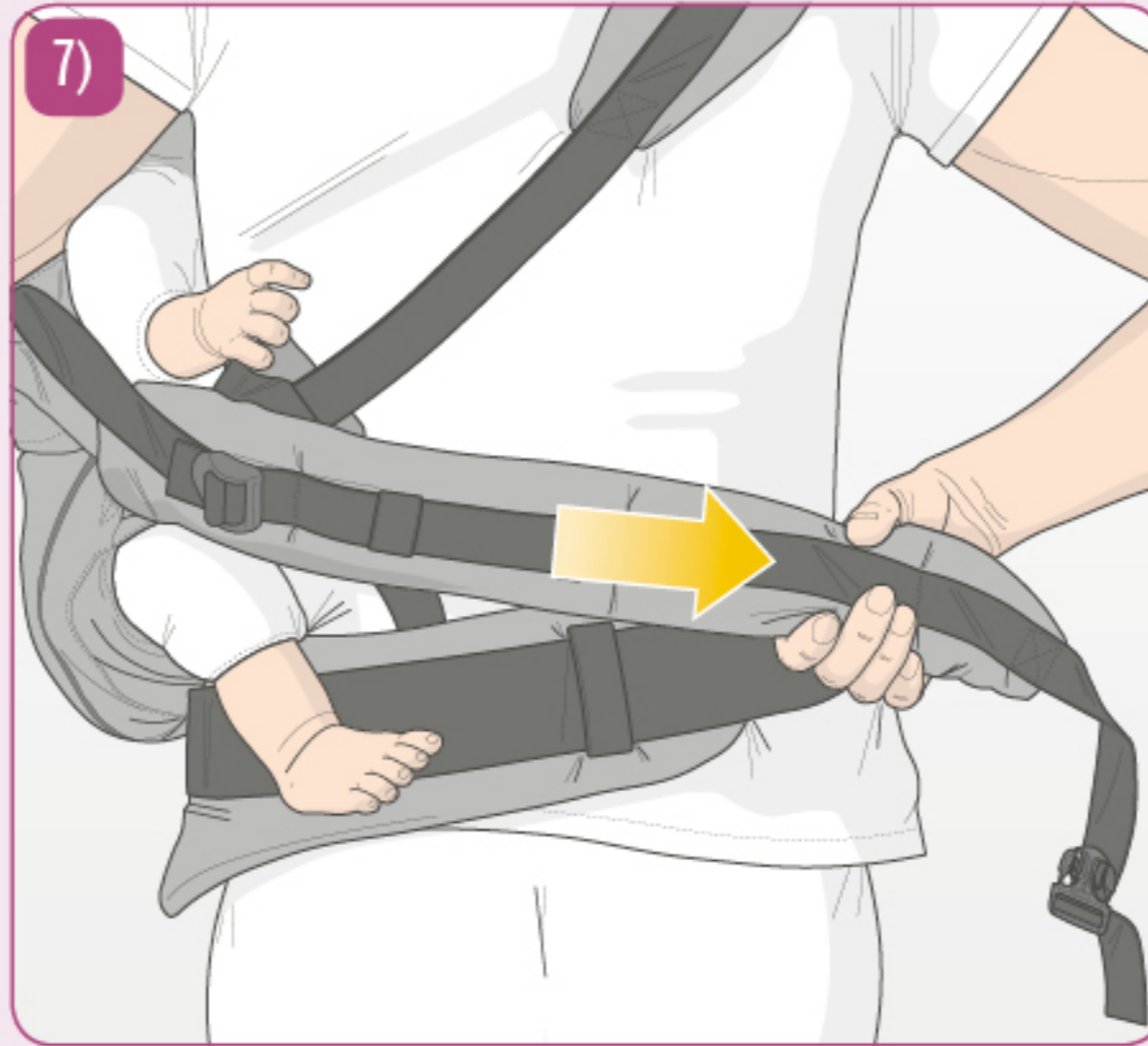



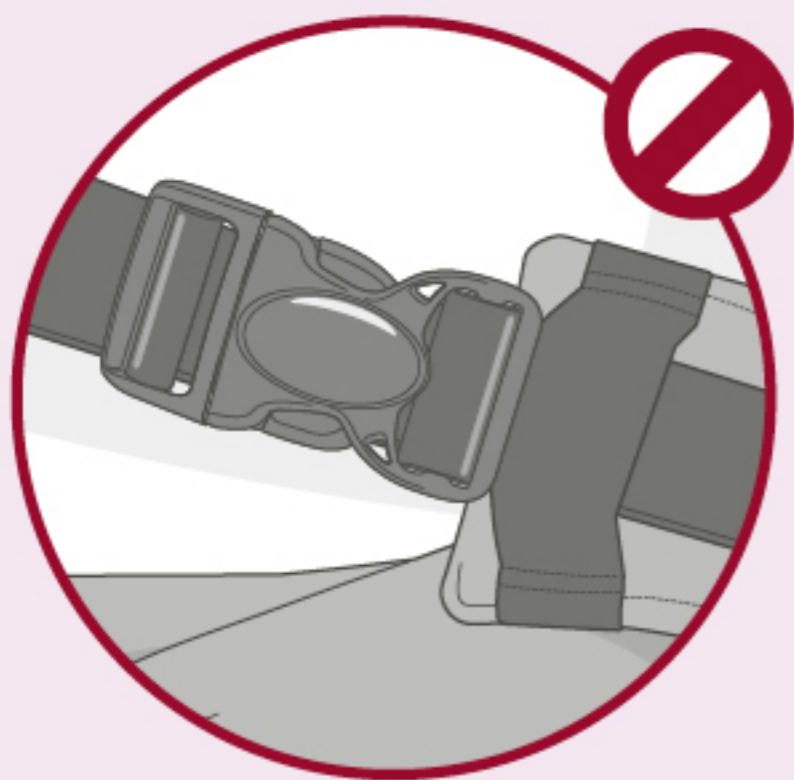
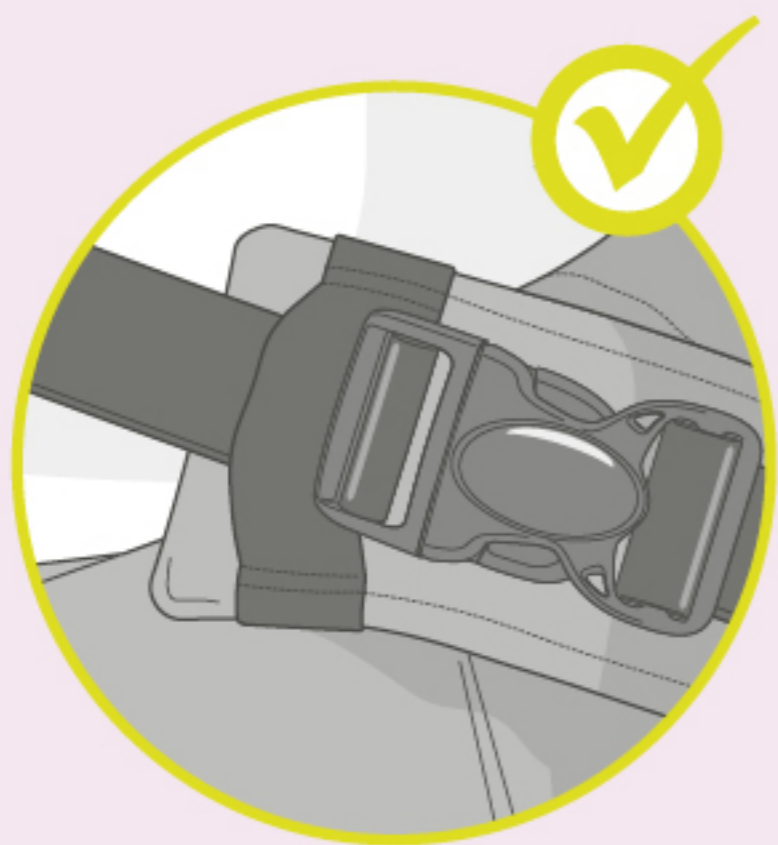



>3 mo. Marsupio dorsale





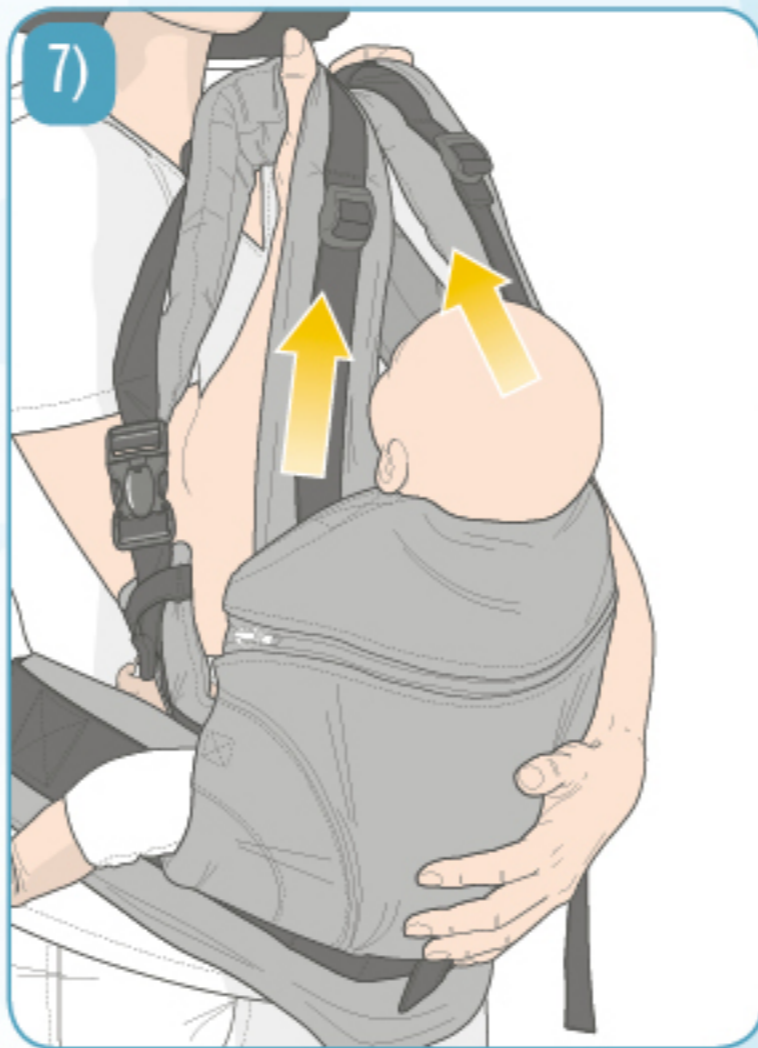



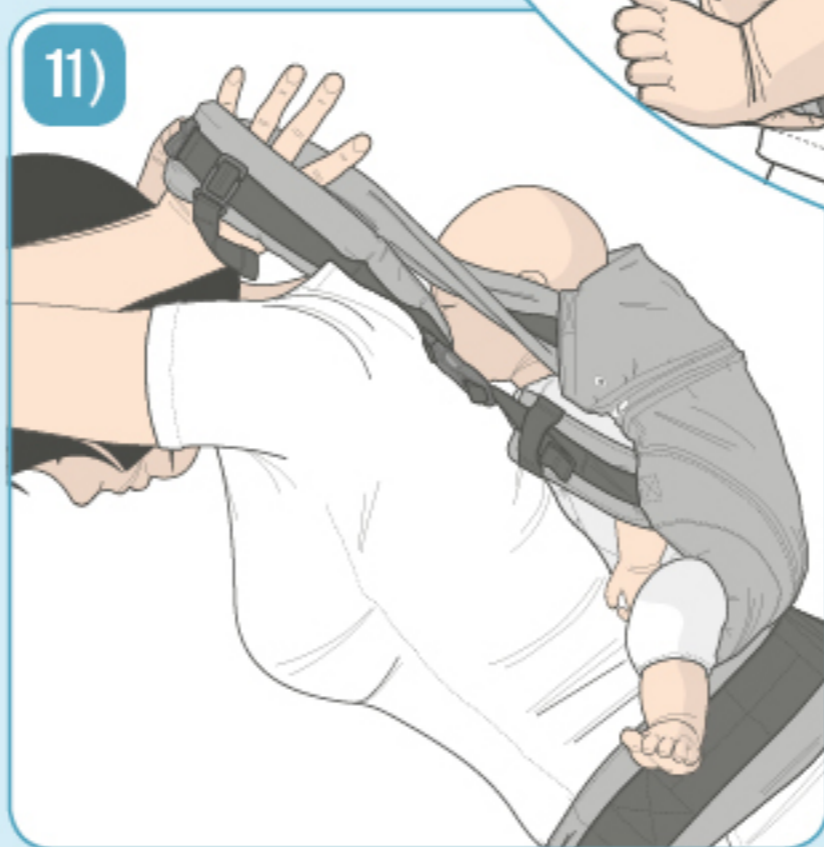
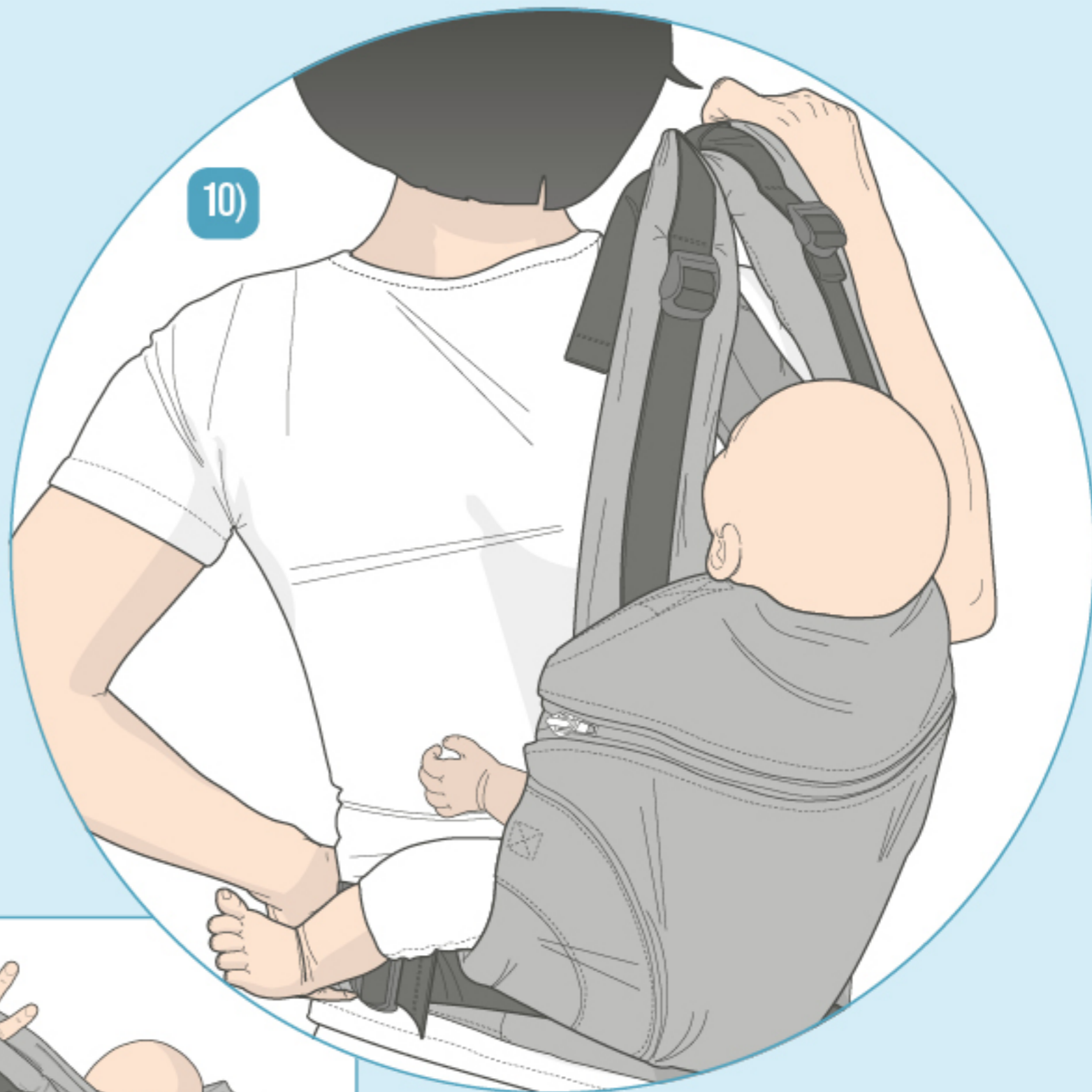
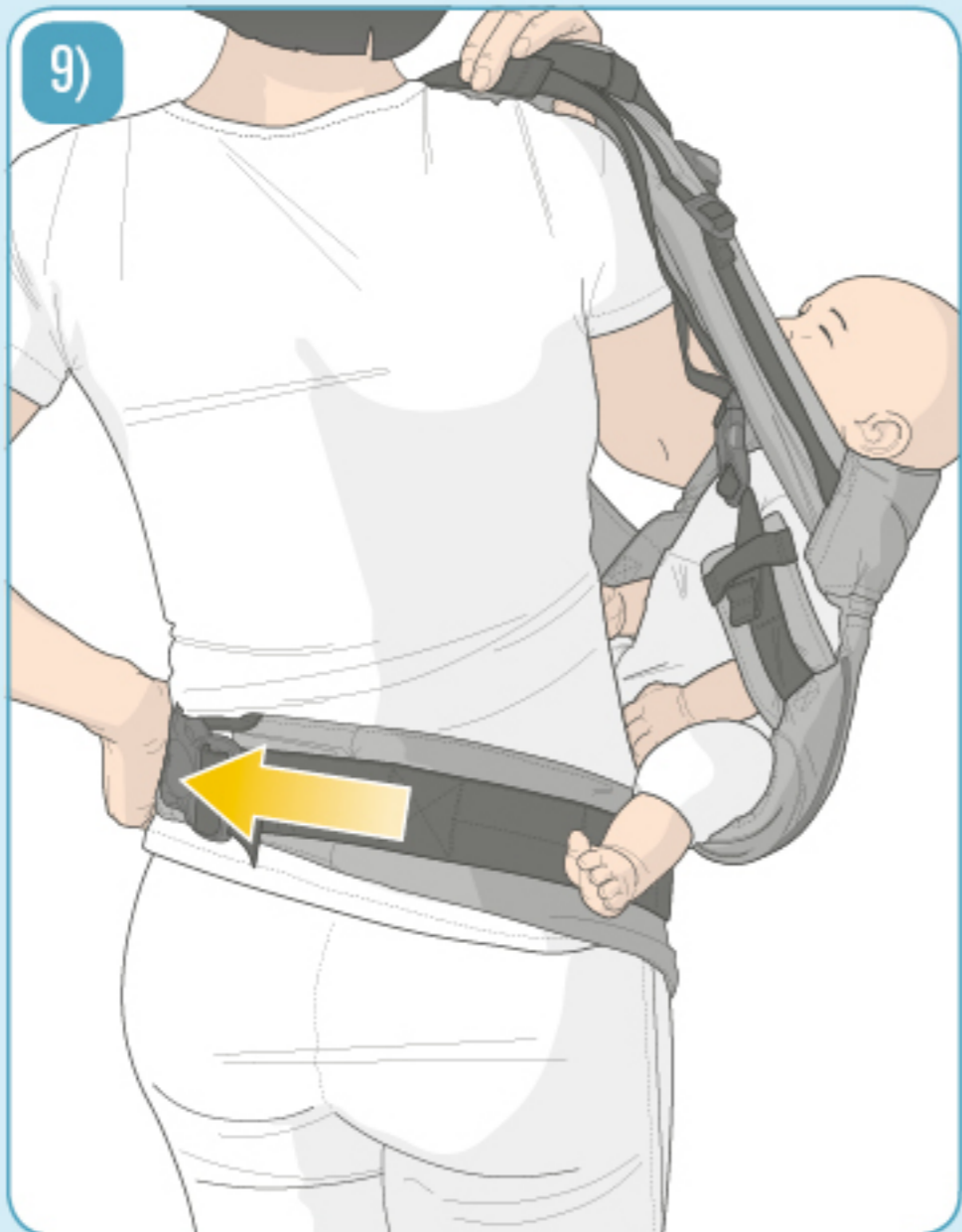

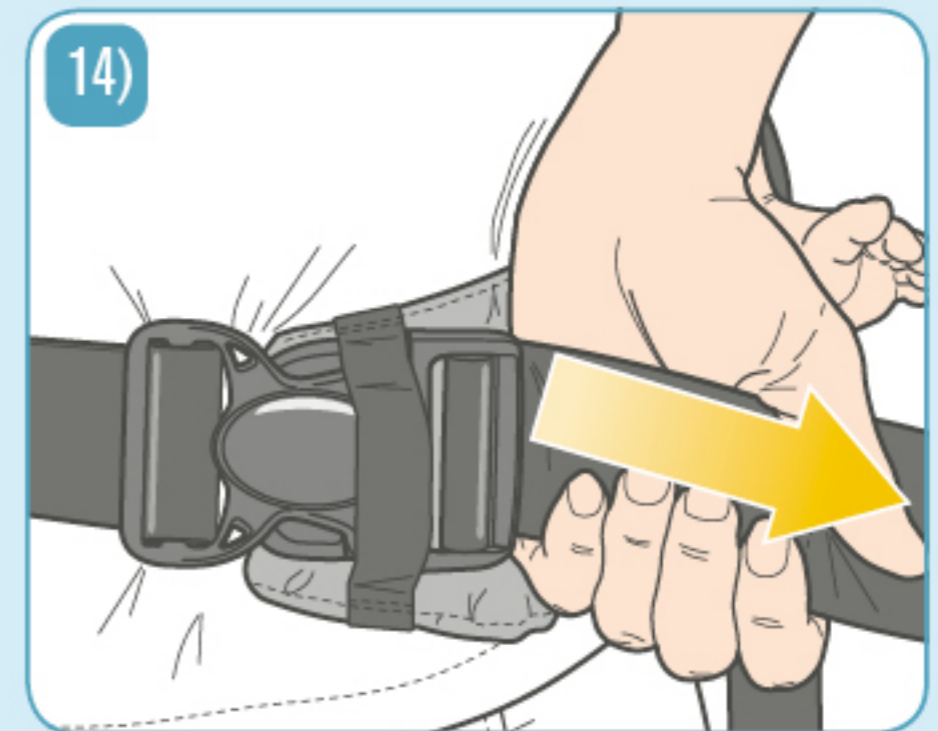
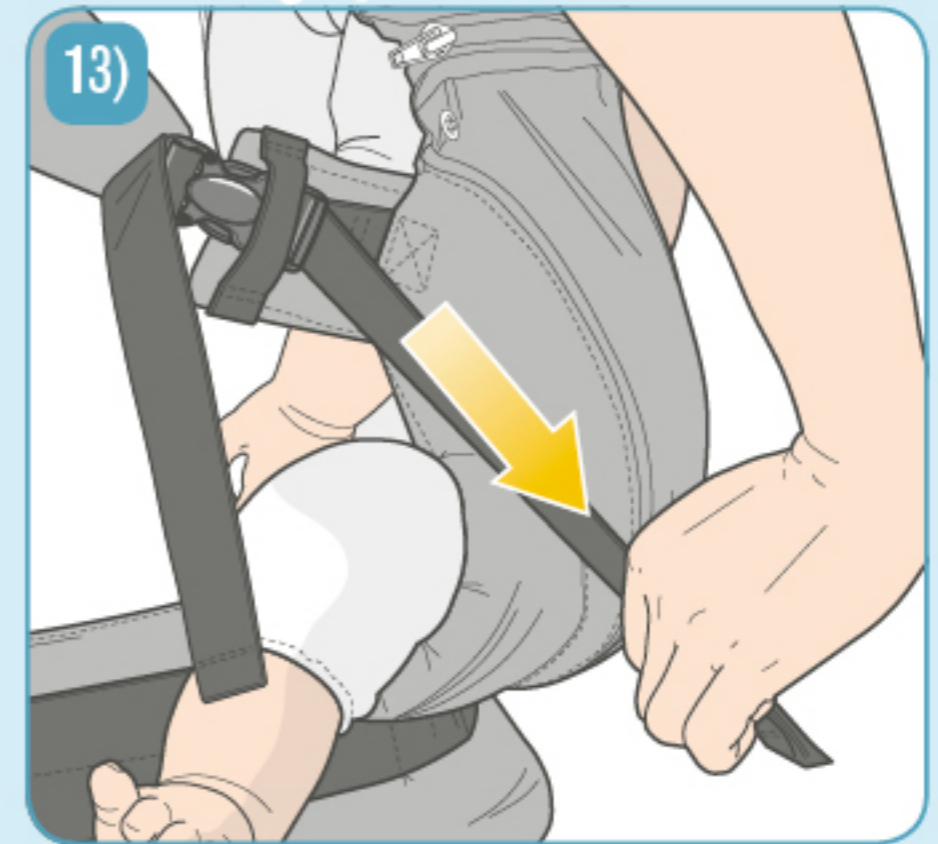
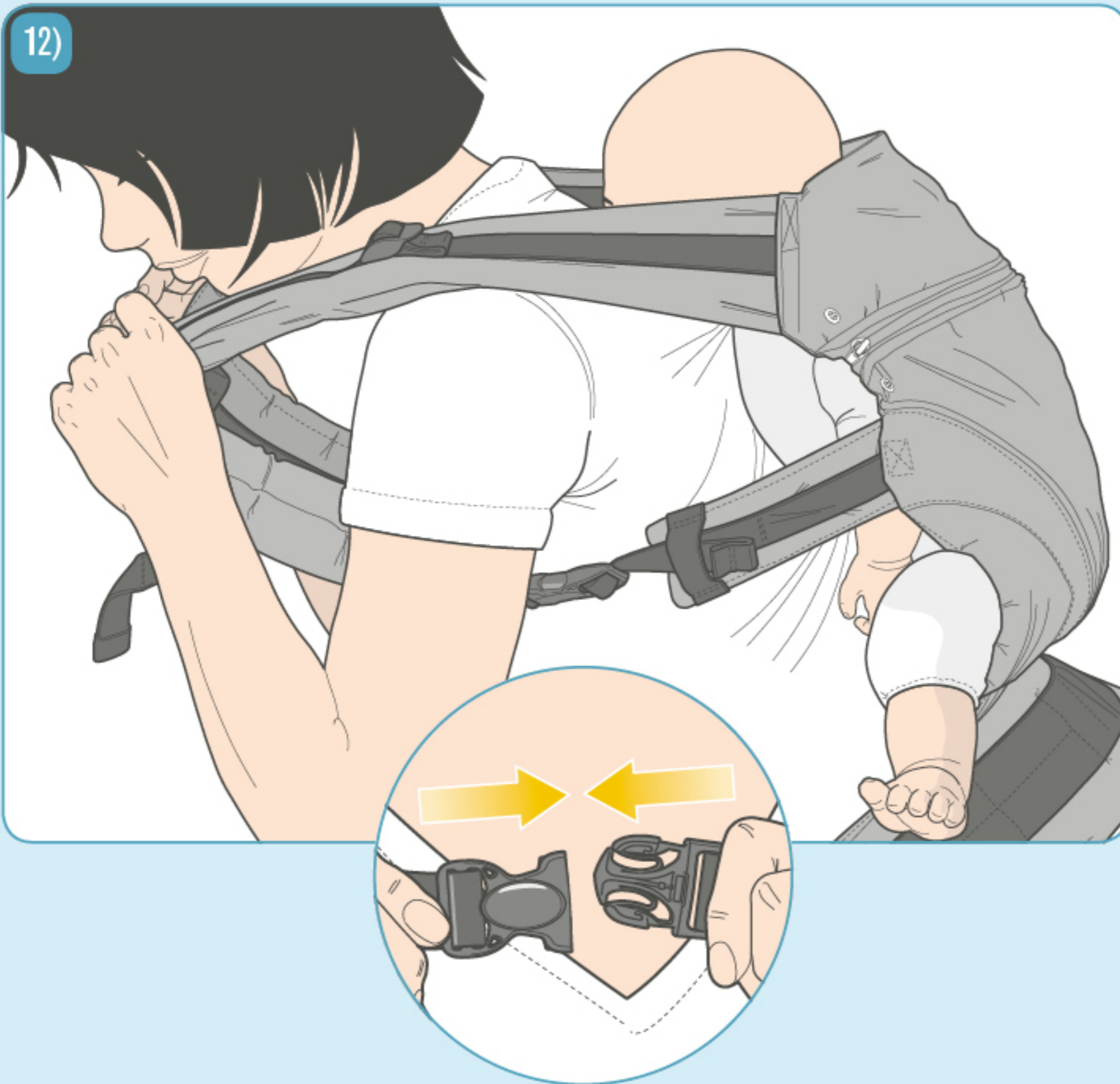





>9 mo.

Marsupio dorsale

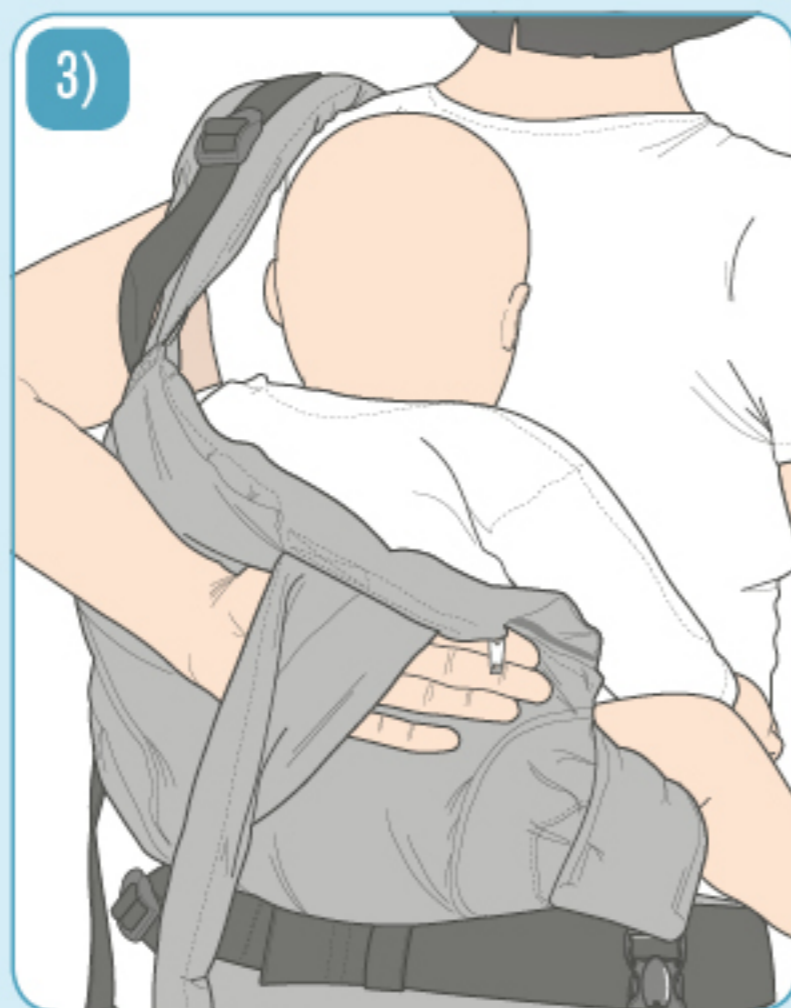



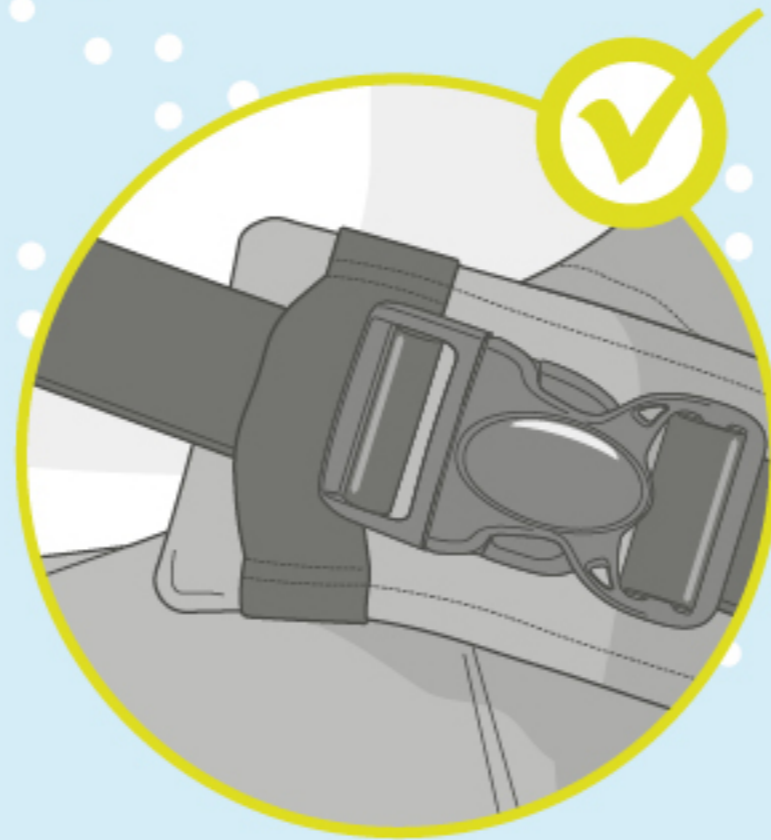
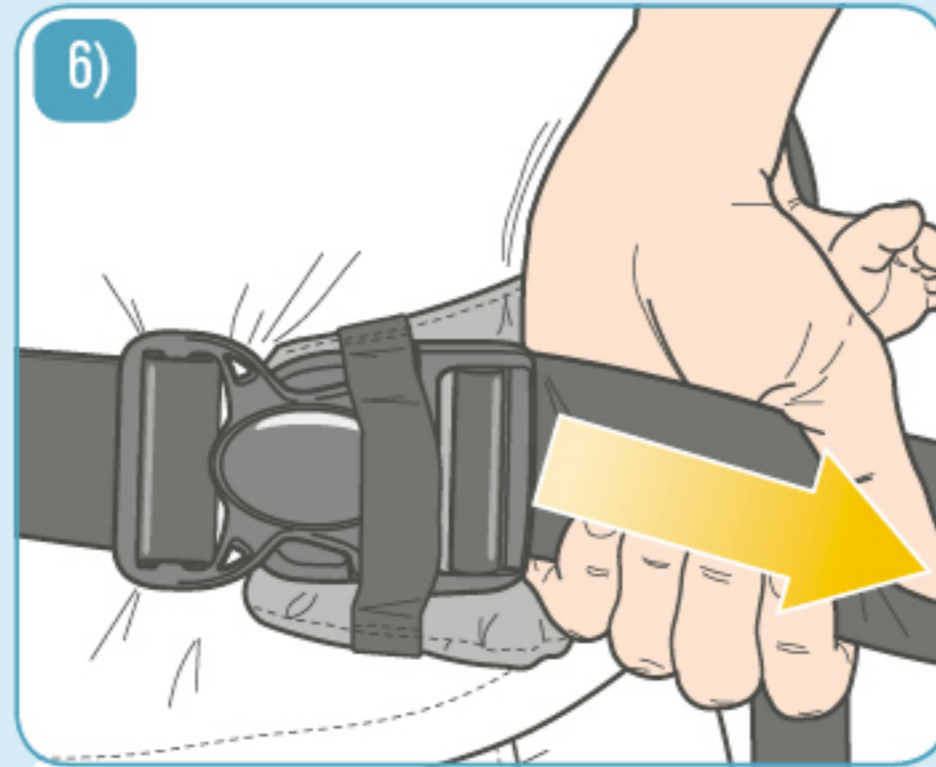
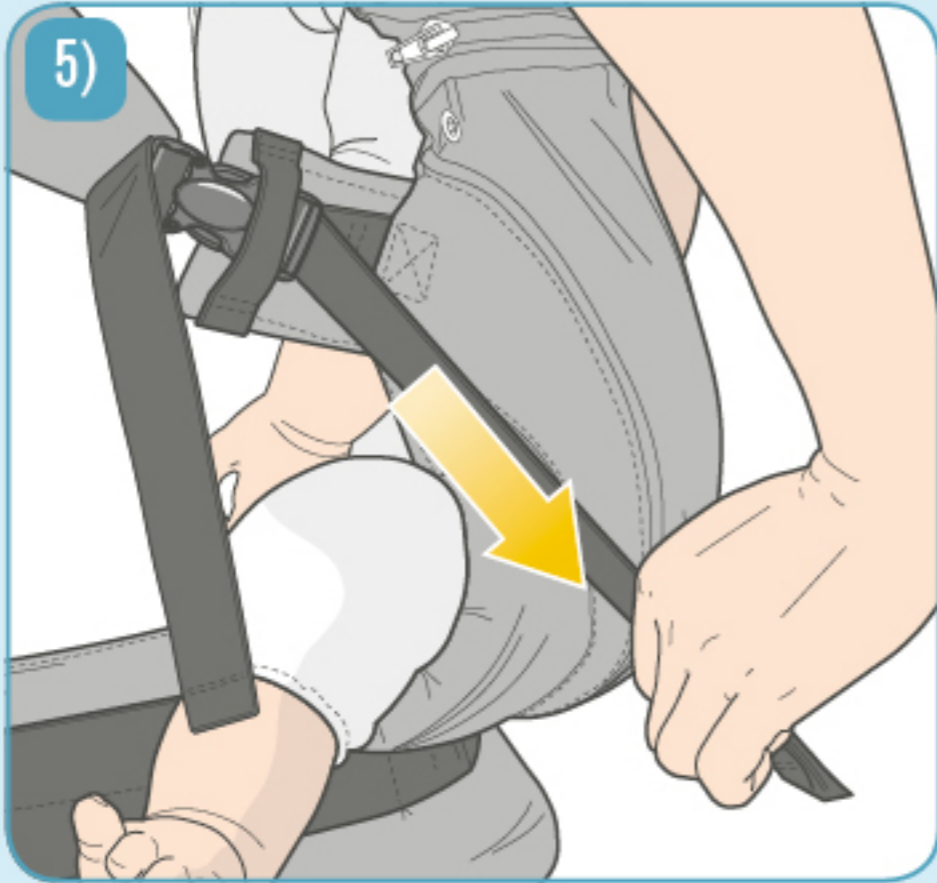

min/max

**3,5/20 kg**  
**7.7/44 lbs**



**manduca**®  
my baby carrier /  
mon porte-bébé **first**

**Design and distribution:**

Wickelkinder GmbH  
Zelterstraße 1  
35043 Marburg  
Germany

Tel. +49 6424 928690  
info@manduca.de